

FHWA REGION NO.	STATE	PROJECT NO.	FISCAL YEAR	SHEET NO.	TOTAL SHEETS
7	KANSAS	87 N-0347-01	2007	75	123

# MACARTHUR ROAD - MERIDIAN AVENUE to SENECA STREET

## WEST-BOUND MACARTHUR DETOUR PLAN

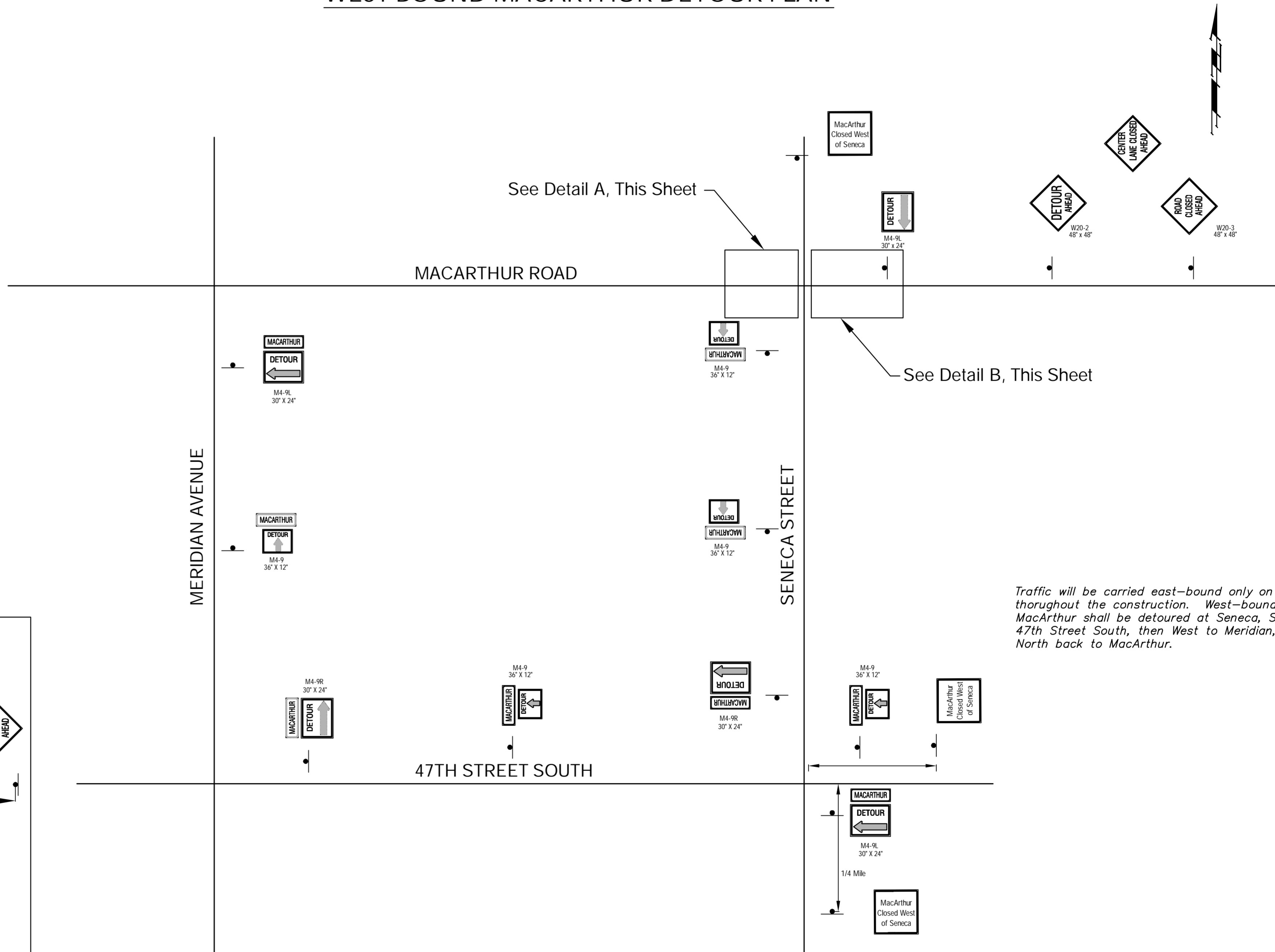
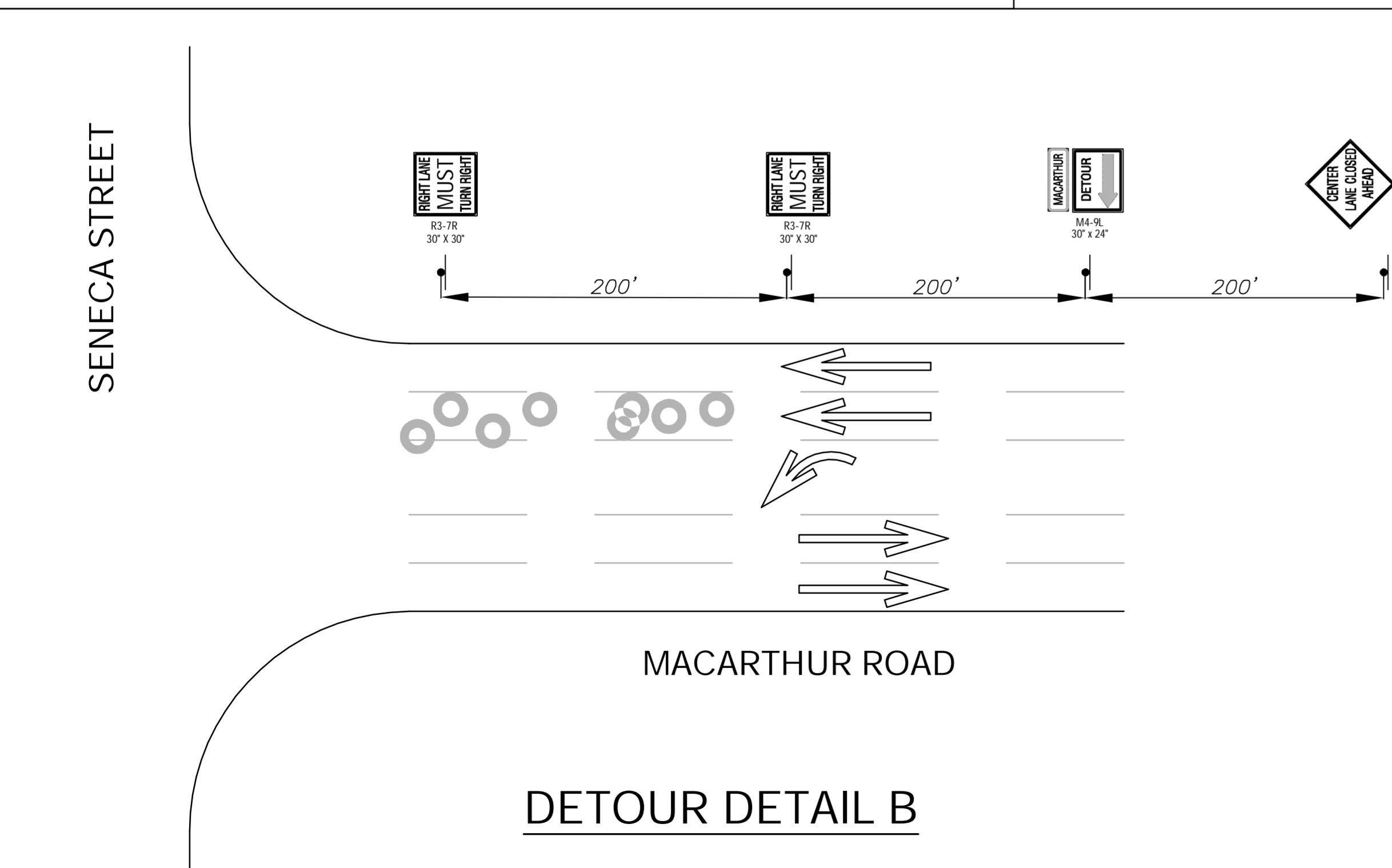
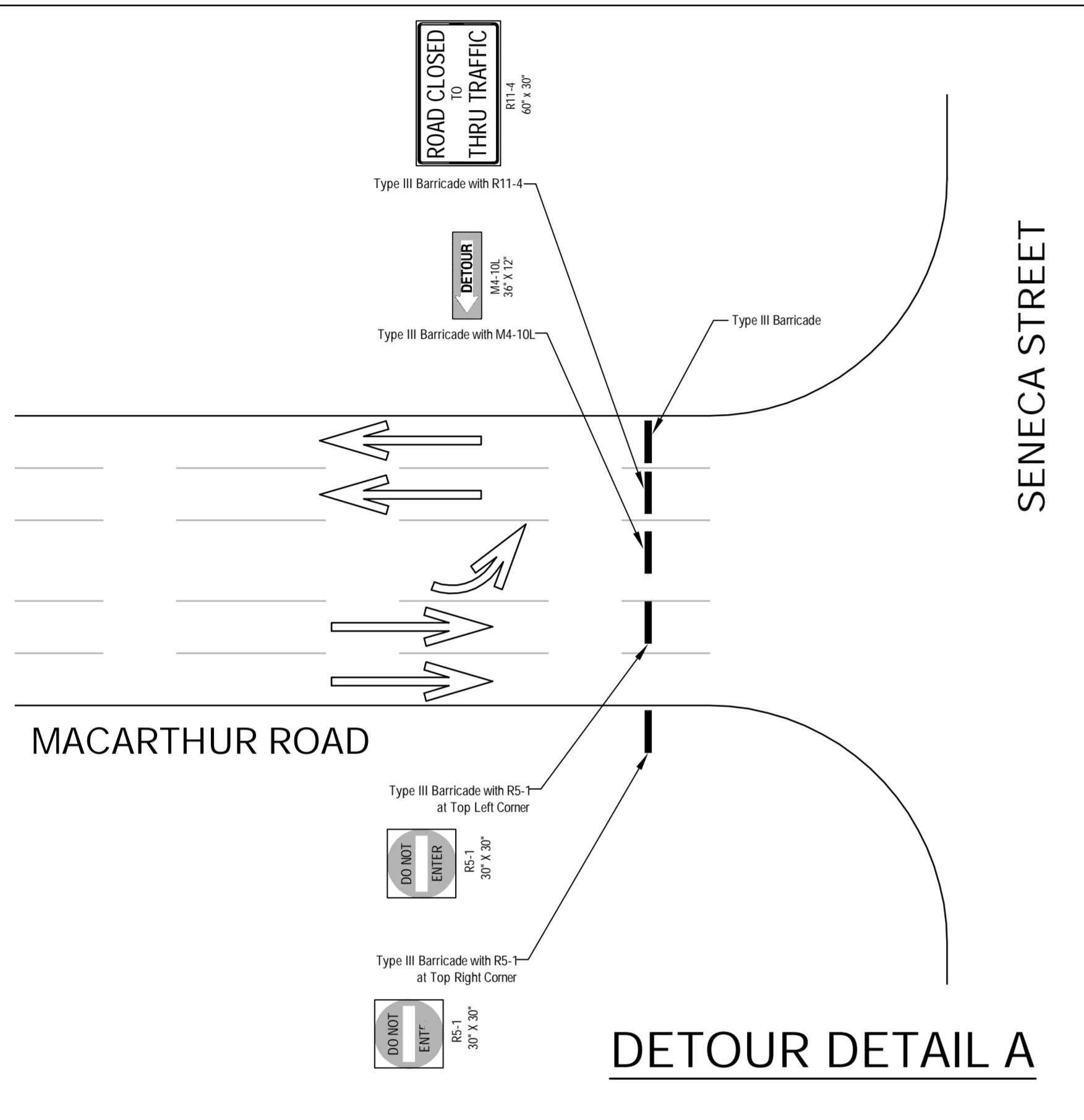

Traffic will be carried east-bound only on MacArthur throughout the construction. West-bound traffic on MacArthur shall be detoured at Seneca, South to 47th Street South, then West to Meridian, and then North back to MacArthur.

Contractor shall provide, erect, and maintain traffic control devices in accordance with the Manual on Uniform Traffic Control Devices (M.U.T.C.D.) as shown on the Traffic Control plans and subject to the Engineer's approval.

Drawing File: E:\MacArthur\Traffic\ConSeq Base.dwg (Detour)

Design: TPV  
 Drawn: TPV  
 Approved: TPV  
 Scale: None

Project No. 04-04-E856 CAPITAL IMPROVEMENT PROJECT  
**MACARTHUR ROAD DETOUR PLAN**  
MACARTHUR ROAD PAVING - MERIDIAN AVENUE to SENECA STREET

**Baughman Company, P.A.**  
 315 Ellis St. Wichita, KS 67211 P 316-262-7271 F 316-262-0149  
ENGINEERING | SURVEYING | PLANNING | LANDSCAPE ARCHITECTURE

July 2007  
 SHEET 75 OF 123