

# MACARTHUR ROAD

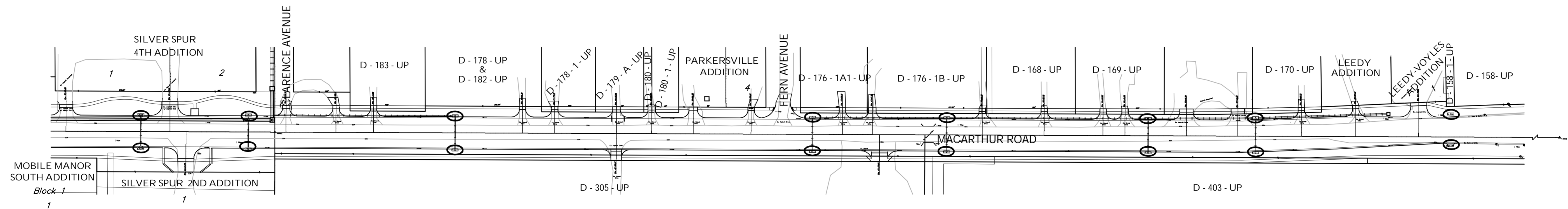

# MERIDIAN AVENUE

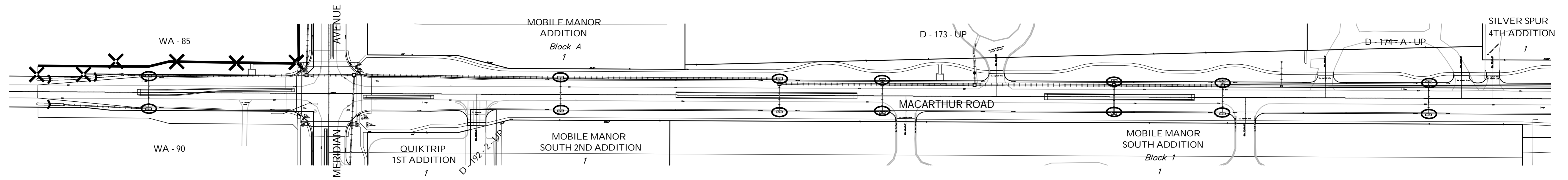
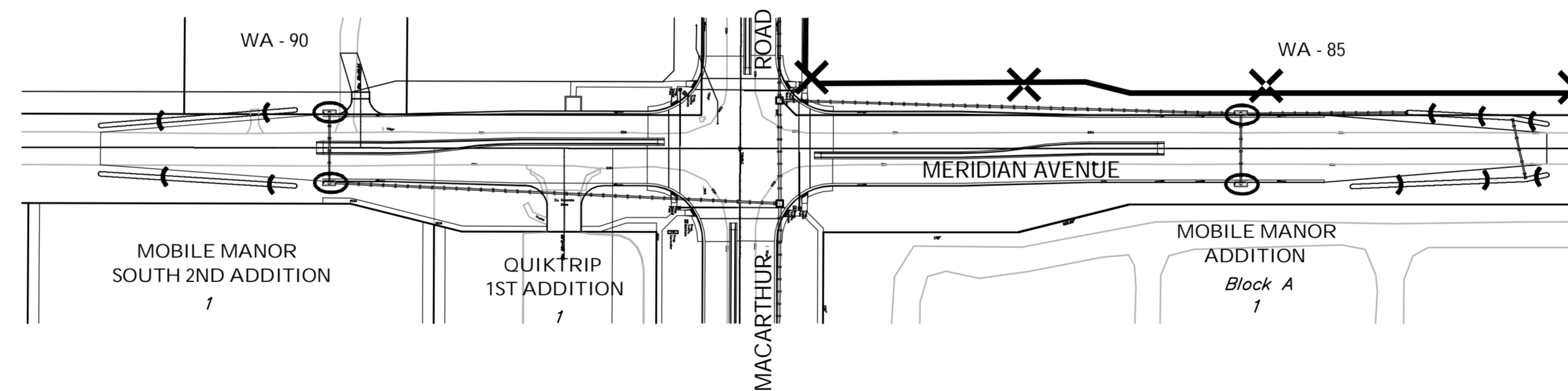

# CLARENCE AVENUE

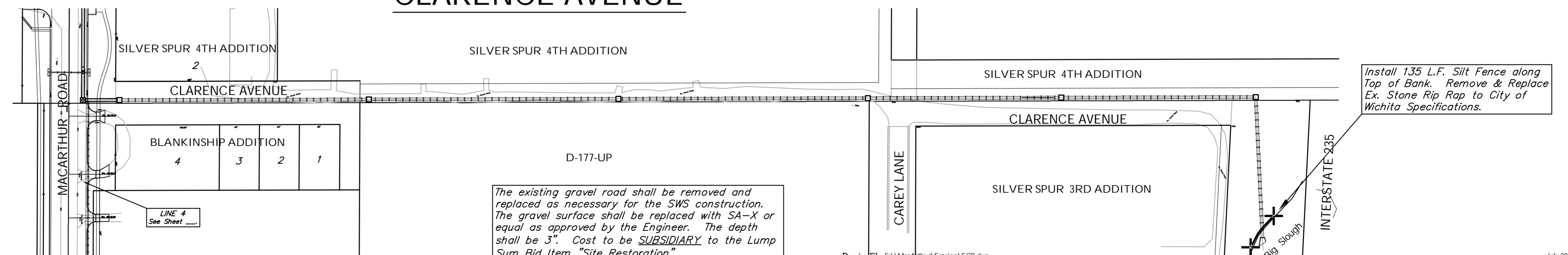

EROSION CONTROL MEASURE	UNITS	QUANTITY
SILT FENCE	L.F.	1,320
RIPRAP	S.Y.	**
DROP INLET BARRIER	EA.	0
CURB INLET BARRIER	EA.	34
STRAW BALE DITCH CHECK	EA.	13
EARTHEN DIKES	L.F.	0
EROSION CONTROL BLANKET	S.Y.	10,500
POND E.C. BLANKET	S.Y.	0
Construction Entrance	EA.	2

QUANTITIES ARE FOR INFORMATION ONLY!  
CONTRACTOR SHALL VERIFY QUANTITIES PER  
SPECIFIC ENGINEERING PLAN SHEET.

\*\*QUANTITIES OF RIP RAP AT END SECTIONS ARE CALLED OUT ON THE PAVING AND SWS PLANS.

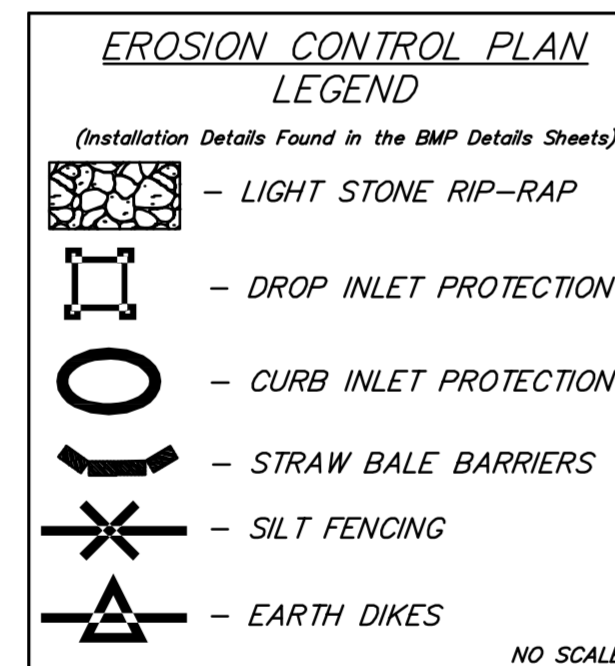

Areas disturbed by the construction of the 54" RCP outside of the gravel road shall be reseeded to City of Wichita Specifications. Cost to be **SUBSIDIARY** to the Lump Sum Bid Item "Permanent Seeding".

Install 135 L.F. Silt Fence along Top of Bank. Remove & Replace Ex. Stone Rip Rap to City of Wichita Specifications.

The existing gravel road shall be removed and replaced as necessary for the SWS construction. The gravel surface shall be replaced with SA-X or equal as approved by the Engineer. The depth shall be 3". Cost to be **SUBSIDIARY** to the Lump Sum Bid Item "Site Restoration".

Drawing File: F:\MacArthur\Erosion\ECP.dwg  
 Design: TPV  
 Drawn: STAFF  
 Approved: TPV  
 Scale: 1" = 100'

Project No. 04-04-E856 CAPITAL IMPROVEMENT PROJECT

## EROSION CONTROL PLAN

MACARTHUR ROAD PAVING - MERIDIAN AVENUE TO SENECA STREET

**Baughman Company, P.A.**  
 315 Ellis St. Wichita, KS 67211 P 316-262-7271 F 316-262-0149  
 ENGINEERING | SURVEYING | PLANNING | LANDSCAPE ARCHITECTURE