

# MANHOLE LOCATIONS

POINT TABLE			
POINT NUMBER	DESCRIPTION	NORTHING	EASTING
MH 1-1	10+05.57 1-1	21386.0855	23082.8646
MH 1-2	12+86.61 1-2	21241.7437	22841.7261
MH 1-3	14+51.29 1-3	21217.9488	22678.7755
MH 1-4	17+44.49 1-4	21219.1463	22385.5820
MH 1-5	19+18.76 1-5	21056.5410	22322.8984
MH 1-6	21+94.81 1-6	20988.3999	22055.3940
MH 1-7	25+65.41 1-7	20635.7104	21941.5606
MH 1-8	29+59.96 1-8	20247.4583	21871.3376
MH 1-9	30+59.82 1-9	20182.0077	21795.9113
MH 1-10	32+64.42 1-10	19984.1822	21743.7149
MH 1-11	35+71.27 1-11	19776.8860	21517.4698
MH 1-12	38+16.84 1-12	19544.4674	21438.1942
MH 1-13	42+16.84 1-13	19207.4554	21222.7344
MH 1-14	44+67.17 1-14	18996.5422	21087.8925
MH 1-15	47+84.78 1-15	18815.2324	20827.1233
MH 1-16	49+76 1-16	18626.0479	20799.3089
MH 1-17	51+63.82 1-17	18439.1951	20818.3260
MH 1-18	55+10.34 1-18	18358.3344	20481.3757
MH 1-19	57+82.11 1-19	18395.8015	20212.2004
MH 1-20	59+90.20 1-20	18524.5763	20048.7432
MH 1-21	60+82.89 1-21	18524.6248	19956.0501
MH 1-22	64+26.48 1-22	18493.4441	19613.8797
MH 1-23	67+70.07 1-23	18462.2634	19271.7093
MH 1-24	69+44.53 1-24	18431.0755	19100.0553
MH 1-25	69+72.18 1-25	18403.4290	19099.9975
MH 1-26	72+76.30 1-26	18099.3075	19099.3617
MH 1-27	74+79.04 1-27	17964.6230	18947.8300
MH 1-28	77+29.39 1-28	17798.3061	18760.7091
MH 1-29	79+32.45 1-29	17619.8314	18663.8495
MH 1-30	81+99.08 1-30	17356.6509	18621.0771
MH 1-31	83+39.02 1-31	17218.5203	18598.6279
MH 1-32	85+63.67 1-32	17106.2787	18793.2267
MH 1-33	89+11.58 1-33	16784.1191	18661.8701
MH 1-34	91+56.33 1-34	16593.1053	18508.8462
MH 1-35	95+40.23 1-35	16617.1975	18125.6995
MH 1-36	98+43.57 1-36	16636.2340	17822.9554
MH 1-37	99+86.67 1-37	16515.3124	17746.4429
MH 1-38	102+10.32 1-38	16417.2062	17545.4548
MH 1-39	103+60.83 1-39	16271.4881	17507.7801
MH 1-40	105+51.27 1-40	16161.8829	17350.8979

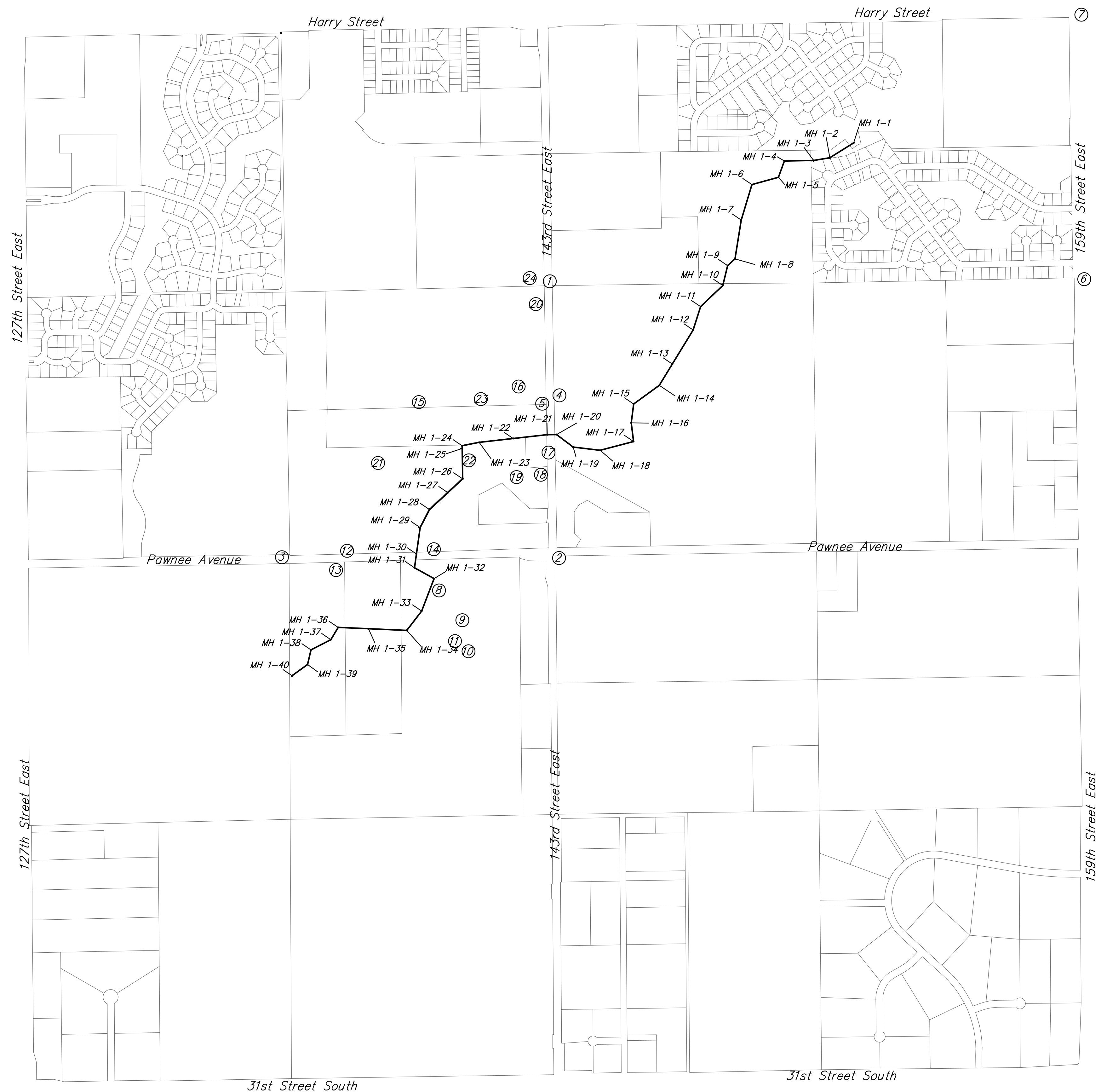

Scale: None



## HORIZONTAL CONTROL

Point	Description	Northing	Easting	Location
1	1/2" IP	N 20,000.0000	E 20,000.0000	2665.76' N. Pawnee & 143rd E.
2	5/8" REBAR CAP	N 17,334.2400	E 20,003.6500	Intersection of Pawnee & 143rd E.
3	5/8" REBAR CAP	N 17,301.8600	E 17,360.2100	2643.64' W. Pawnee & 143rd E.
4	GPS 1/2" REBAR	N 18,677.4334	E 20,048.1074	1343.13' N. & 46.30' E. Pawnee & 143rd E.
5	CNC NAIL	N 18,655.3341	E 20,013.9813	1321.08' N. & 12.14' E. Pawnee & 143rd E.
6	1/2" IP	N 19,990.5433	E 25,299.5697	2655.89' S. Harry & 159th E.
7	3/4" IP	N 22,646.4235	E 25305.7860	Intersection of Harry & 159th E.
8	5/8" REBAR	N 17,090.7297	E 18,781.2281	1225.31' W. & 228.52' S. Pawnee & 143rd E.
9	5/8" REBAR	N 16,934.4676	E 18952.4200	1056.05' W. & 386.87' S. Pawnee & 143rd E.
10	5/8" REBAR	N 16,823.6479	E 18,977.7875	1032.04' W. & 497.99' S. Pawnee & 143rd E.
11	5/8" REBAR	N 16,835.3618	E 18,972.6422	1037.04' W. & 486.21' S. Pawnee & 143rd E.
12	1/2" REBAR	N 17,336.8170	E 17,919.7220	2083.74' W. & 28.10' N. Pawnee & 143rd E.
13	1/2" REBAR	N 17,278.6190	E 17,880.1430	2124.03' W. & 29.61' S. Pawnee & 143rd E.
14	1/2" REBAR	N 17,334.6330	E 18,699.4560	1304.09' W. & 16.37' N. Pawnee & 143rd E.
15	1/2" REBAR	N 18,636.6140	E 18,814.7420	1304.00' N. & 1187.12' W. Pawnee & 143rd E.
16	1/2" REBAR	N 18,719.6960	E 19,842.3360	1385.68' N. & 159.42' W. Pawnee & 143rd E.
17	1/2" REBAR	N 18,349.1070	E 20,029.1330	1014.83' N. & 26.87' E. Pawnee & 143rd E.
18	1/2" REBAR	N 18,167.9630	E 19,975.6730	833.76' N. & 26.84' W. Pawnee & 143rd E.
19	+ CUT	N 18,205.1174	E 19,733.2983	871.25' N. & 269.16' W. Pawnee & 143rd E.
20	1/2" REBAR	N 19,935.0190	E 19,980.9950	2600.81' N. & 19.09' W. Pawnee & 143rd E.
21	1/2" REBAR	N 18,178.9950	E 18,690.1050	1303.10' W. & 860.78' N. Pawnee & 143rd E.
22	1/2" REBAR	N 18,295.4420	E 19,102.3100	962.44' N. & 900.02' W. Pawnee & 143rd E.
23	1/2" REBAR	N 18,695.7300	E 19,556.2726	1362.10' N. & 445.51' W. Pawnee & 143rd E.
24	3/4" IP	N 19,999.6734	E 19,960.5617	2665.49' N & 39.44' W. Pawnee & 143rd E.

Manhole Coordinates Located Above

**SOUTHEAST AREA INTERCEPTOR  
KEY MAP**

	<b>Ruggles &amp; Bohm, P.A.</b> Engineering, Surveying, Land Planning	DESIGN: EJC DRAWN: MLP REVIEW: MLP UTILITY:	SHEET: 2 OF: 20
	924 North Main (316) 264-8008 Wichita, Kansas 67203(316) 264-4821 fax www.rbkansas.com	PROJECT NUMBER: 468-84240	DATE: 5/10/07