

FHWA REGION NO.	STATE	PROJECT NO.	YEAR	SHEET NO.	TOTAL SHEETS
7	KANSAS	54-87 K-6657-01	2002	88	1122

Scale: 1:250

DATE	
BY	
REFERENCES NOTED	
REFERENCES CHECKED	

DSNR: WDH OPER: JGP SCALE: 1:250
 I:/1997/97362/INTERSECTIONS/TYLERSPITS.DGN 12-19-2000 10:00:31 LAST REV: 10-16-01 BY: JGP

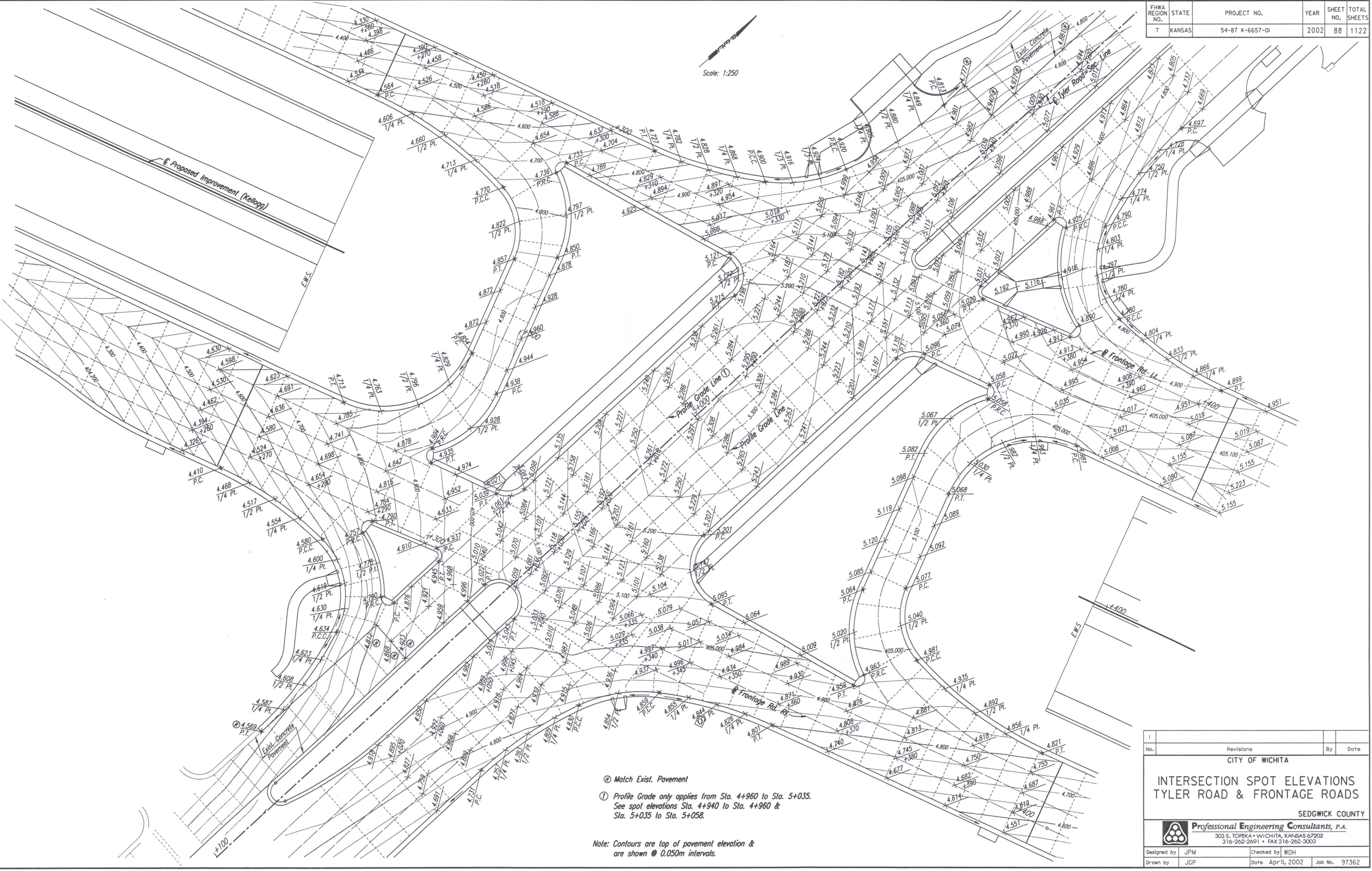

- ⊗ Match Exist. Pavement
- ① Profile Grade only applies from Sta. 4+960 to Sta. 5+035.
See spot elevations Sta. 4+940 to Sta. 4+960 & Sta. 5+035 to Sta. 5+058.

Note: Contours are top of pavement elevation & are shown @ 0.050m intervals.

Revisions		By	Date
CITY OF WICHITA			
INTERSECTION SPOT ELEVATIONS TYLER ROAD & FRONTAGE ROADS			
SEDGWICK COUNTY			
Professional Engineering Consultants, P.A. 303 S. TOPEKA • WICHITA, KANSAS 67202 316-262-2691 • FAX 316-262-3003			
Designed by	JPM	Checked by	WDH
Drawn by	JGP	Date	Apr-11, 2002
		Job No.	97362