

FHWA REGION NO.	STATE	PROJECT NO.	YEAR	SHEET NO.	TOTAL SHEETS
7	KANSAS	54-87 K-6657-01	2002	119	1122

- * 100 mm Pressure relief joint. See Standard Drawing RD661 Sl, Sh. No. 126.
- (*) Expansion joint Type B. See Standard Drawing RD662 Sl, Sh. No. 127 for details.
- K.J. Keyed Construction Joint.
- (1) Measured along back of CSB.

GENERAL NOTE

Special Concrete Bridge Approach shall be paid for as sq. m of Concrete Pavement (260 mm Unit)(A.E.) and includes all work and materials required to construct the approach slab as shown on this sheet.

All work and materials required for installation of expansion joints and pressure relief joints shall be subsidiary to this bid item.

All preformed joint material shall be installed perpendicular to pavement surface. Formed joints shall be edged with 6 mm radius tool for length of joint.

At the Contractor's option #13 x 900 mm tie bars @ 380 mm centers may be substituted for the #19 e bars at 750 mm centers.

All reinforcing steel shall be epoxy coated.

See Standard Drawing RD661 Sl for details of joints & reinforcing mesh.

Clearance from the face of concrete for all reinforcing steel shall be 50 mm.

Standard reinforcing bar hooks in accordance with the latest ACI specifications shall be used throughout.

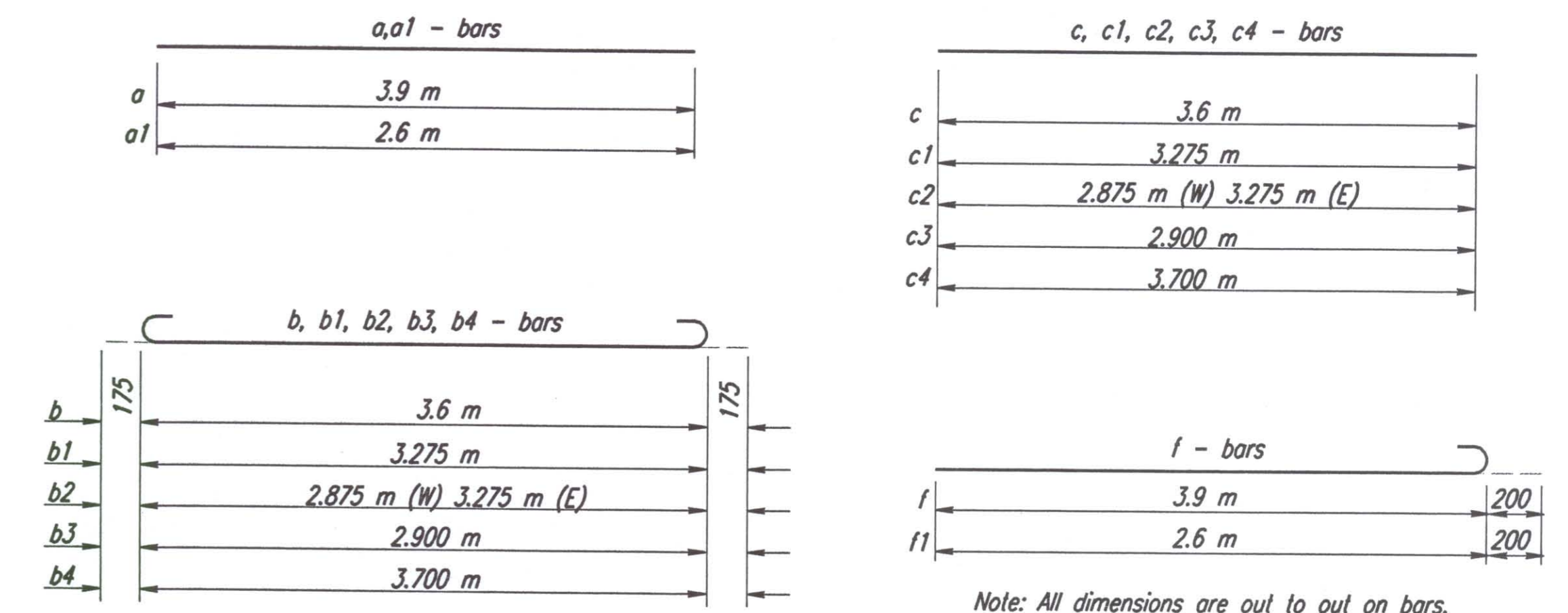

BENDING DIAGRAMS

For Sections A-A, B-B, & C-C, See Sh. No. 120.

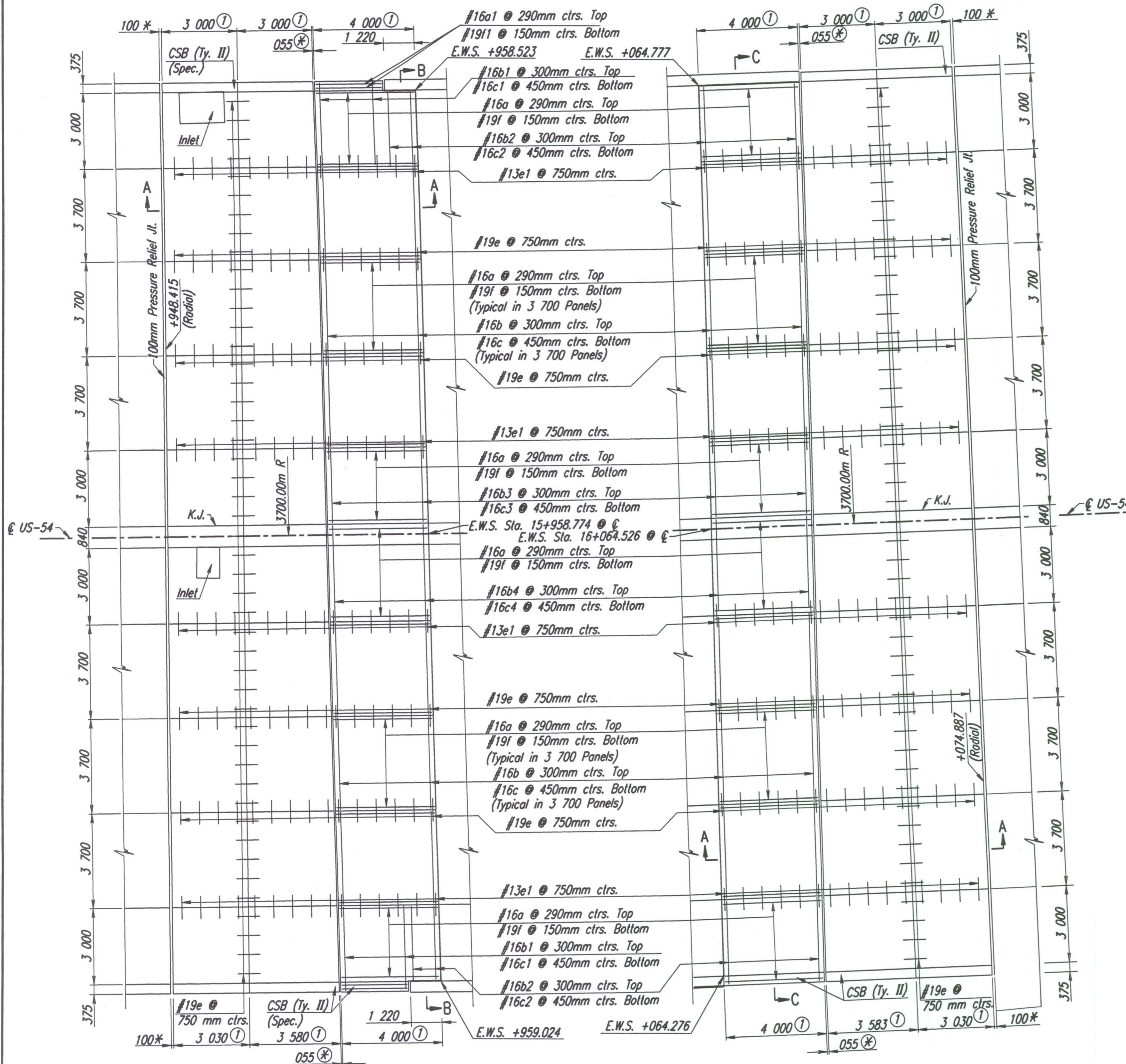

PLAN AT WEST APPROACH

PLAN AT EAST APPROACH

BILL OF MATERIALS (WEST APPROACH)

BAR SCHEDULE																
Bar	a	a1	b	b1	b2	b3	b4	c	c1	c2	c3	c4	e	e1	f	f1
No.	121	4	84	18	10	14	14	54	12	6	9	9	109	60	236	4
Size	#16	#16	#16	#16	#16	#16	#16	#16	#16	#16	#16	#16	#19	#13	#19	#19
Length	3 900	2 600	3 950	3 625	3 225	3 250	4 050	3 600	3 275	2 875	2 900	3 700	900	900	4 100	2 800
Reinforcing Steel																4 516 kg
Concrete Pavement(260 mm Unit)(AE)																367.3 m ²
Expansion Joint																35 793 mm
100 mm Pressure Relief Joint																35 790 mm

BILL OF MATERIALS (EAST APPROACH)

BAR SCHEDULE																
Bar	a	b	b1	b2	b3	b4	c	c1	c2	c3	c4	e	e1	f		
No.	122	84	—	28	14	14	54	—	18	9	9	109	60	239		
Size	#16	#16	—	#16	#16	#16	#16	—	#16	#16	#16	#19	#13	#19		
Length	3 900	3 950	—	3 625	3 250	4 050	3 600	—	3 275	2 900	3 700	900	900	4 100		
Reinforcing Steel																4 518 kg
Concrete Pavement(260 mm Unit)(AE)																365.5 m ²
Expansion Joint																35 794 mm
100 mm Pressure Relief Joint																35 790 mm

Reinforcing steel and joint lengths shown for information only.

DATE	
BY	
REFERENCES NOTED	
REFERENCES CHECKED	

DSNR: OPER: JGP SCALE: 1:100
 I:/1997/97362/APPROACH SLAB/COWSKIN.DGN 12-06-2001 13:24:53 LAST REV: 1-17-2002 BY: svb

Revisions		By	Date
CITY OF WICHITA			
CONCRETE BRIDGE APPROACH PAVEMENT E.B. & W.B. US-54 OVER COWSKIN CREEK			
SEDGWICK COUNTY			
 Professional Engineering Consultants, P.A. 303 S. TOPEKA • WICHITA, KANSAS 67202 316-262-2691 • FAX 316-262-3003			
Designed by	WDH	Checked by	
Drawn by	JGP	Date	Apr 11, 2002
		Job No.	97362