

FHWA REGION NO.	STATE	PROJECT NO.	YEAR	SHEET NO.	TOTAL SHEETS
7	KANSAS	54-87 K-6657-01	2002	155	1122

See Maize Rd. Plans for Storm Water Sewer on Maize Rd.

DATE	
BY	
REFERENCES NOTED	
REFERENCES CHECKED	

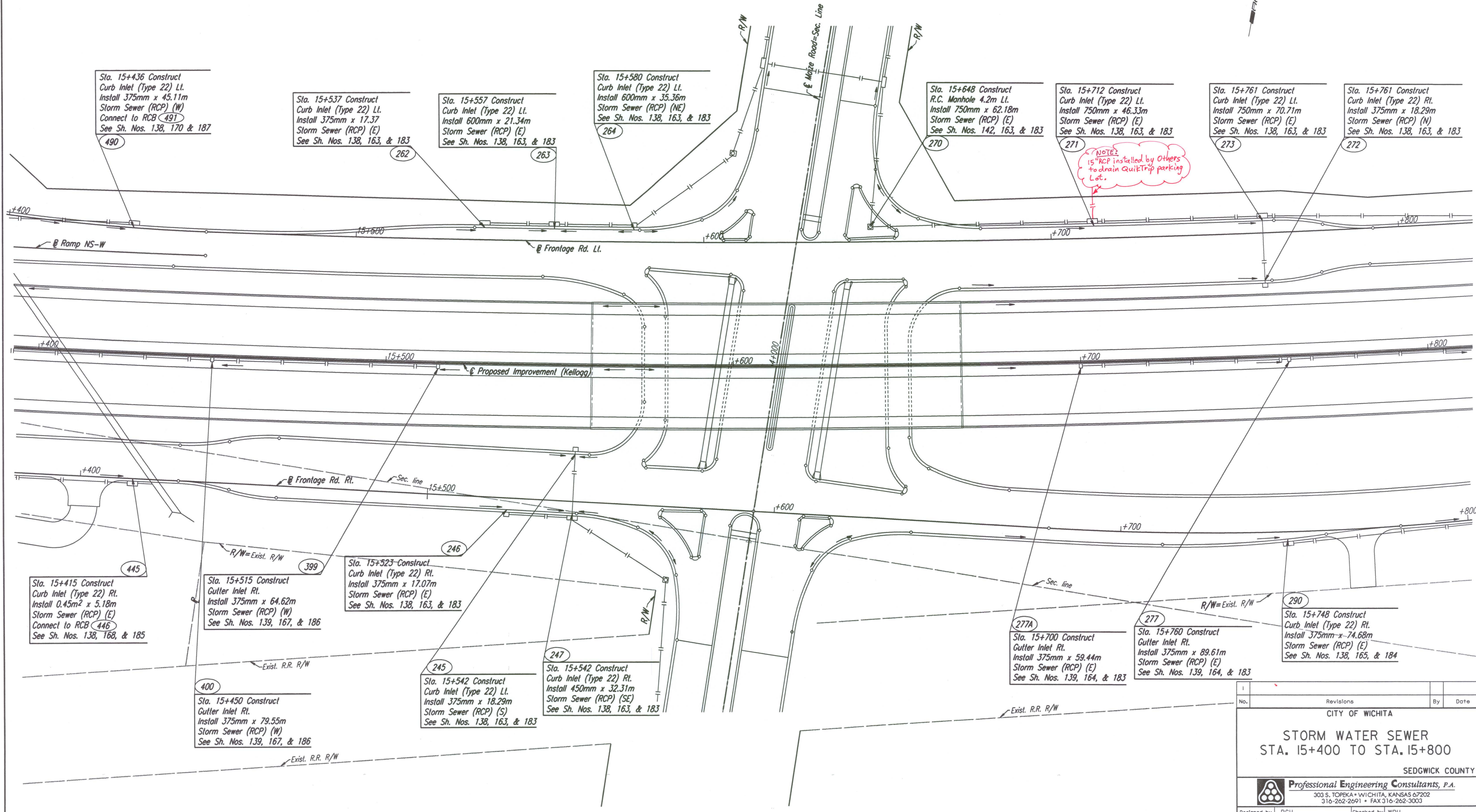

Sta. 15+436 Construct Curb Inlet (Type 22) Lt. Install 375mm x 45.11m Storm Sewer (RCP) (W) Connect to RCB 491 See Sh. Nos. 138, 170 & 187

Sta. 15+537 Construct Curb Inlet (Type 22) Lt. Install 375mm x 17.37 Storm Sewer (RCP) (E) See Sh. Nos. 138, 163, & 183

Sta. 15+557 Construct Curb Inlet (Type 22) Lt. Install 600mm x 21.34m Storm Sewer (RCP) (E) See Sh. Nos. 138, 163, & 183

Sta. 15+580 Construct Curb Inlet (Type 22) Lt. Install 600mm x 35.36m Storm Sewer (RCP) (NE) See Sh. Nos. 138, 163, & 183

Sta. 15+648 Construct R.C. Manhole 4.2m Lt. Install 750mm x 62.18m Storm Sewer (RCP) (E) See Sh. Nos. 142, 163, & 183

Sta. 15+712 Construct Curb Inlet (Type 22) Lt. Install 750mm x 46.33m Storm Sewer (RCP) (E) See Sh. Nos. 138, 163, & 183

NOTE: 15" RCP installed by Others to drain QuikTrip parking Lot.

Sta. 15+761 Construct Curb Inlet (Type 22) Lt. Install 750mm x 70.71m Storm Sewer (RCP) (E) See Sh. Nos. 138, 163, & 183

Sta. 15+761 Construct Curb Inlet (Type 22) Rt. Install 375mm x 18.29m Storm Sewer (RCP) (N) See Sh. Nos. 138, 163, & 183

Sta. 15+415 Construct Curb Inlet (Type 22) Rt. Install 0.45m² x 5.18m Storm Sewer (RCP) (E) Connect to RCB 446 See Sh. Nos. 138, 168, & 185

Sta. 15+515 Construct Gutter Inlet Rt. Install 375mm x 64.62m Storm Sewer (RCP) (W) See Sh. Nos. 139, 167, & 186

Sta. 15+523 Construct Curb Inlet (Type 22) Rt. Install 375mm x 17.07m Storm Sewer (RCP) (E) See Sh. Nos. 138, 163, & 183

Sta. 15+542 Construct Curb Inlet (Type 22) Lt. Install 375mm x 18.29m Storm Sewer (RCP) (S) See Sh. Nos. 138, 163, & 183

Sta. 15+542 Construct Curb Inlet (Type 22) Rt. Install 450mm x 32.31m Storm Sewer (RCP) (SE) See Sh. Nos. 138, 163, & 183

Sta. 15+700 Construct Gutter Inlet Rt. Install 375mm x 59.44m Storm Sewer (RCP) (E) See Sh. Nos. 139, 164, & 183

Sta. 15+760 Construct Gutter Inlet Rt. Install 375mm x 89.61m Storm Sewer (RCP) (E) See Sh. Nos. 139, 164, & 183

Sta. 15+748 Construct Curb Inlet (Type 22) Rt. Install 375mm x 74.68m Storm Sewer (RCP) (E) See Sh. Nos. 138, 165, & 184

No.	Revisions	By	Date

CITY OF WICHITA
STORM WATER SEWER
 STA. 15+400 TO STA. 15+800
 SEDGWICK COUNTY

Professional Engineering Consultants, P.A.
 303 S. TOPEKA • WICHITA, KANSAS 67202
 316-262-2691 • FAX 316-262-3003

Designed by	RCH	Checked by	WDH
Drawn by	JGP	Date	April, 2002
		Job No.	97362

DSNR: JPS OPER: JGP SCALE: 1:500
 I:/1997/97362/SWS/SWS154.DGN 11-22-1999 15:54:32 LAST REV: 2-6-2002 BY: svb