

FHWA REGION NO.	STATE	PROJECT NO.	YEAR	SHEET NO.	TOTAL SHEETS
7	KANSAS	54-87 K-6657-01	2002	156	1122

DATE	
BY	
REFERENCES NOTED	
REFERENCES CHECKED	

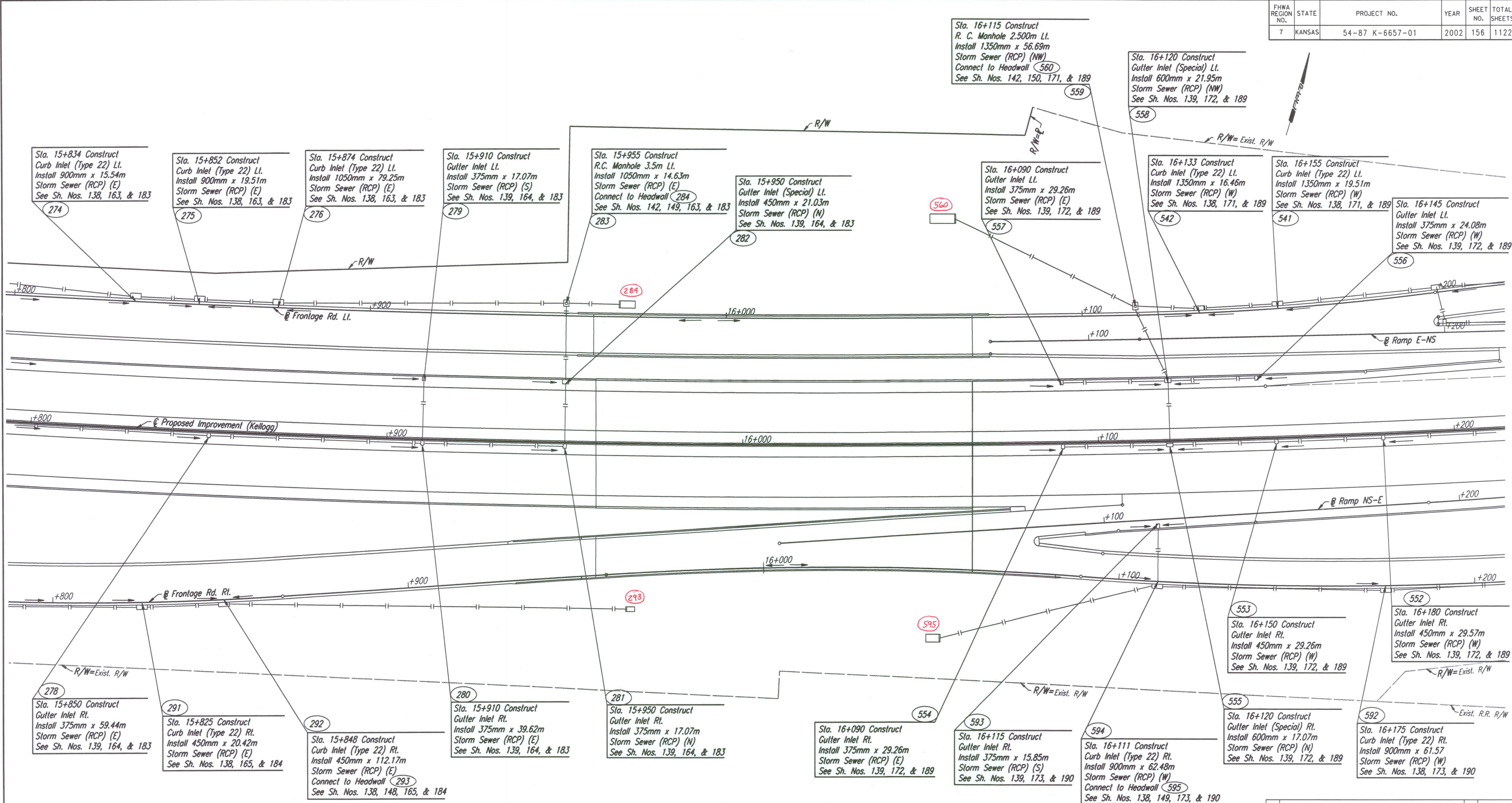

DSNR: JPS OPER: JGP SCALE: 1:500  
 I:/1997/07362/SWS/SWS158.DGN 11-22-1999 10:52:34 LAST REV: 2-6-2002 BY: svb

No.	Revisions	By	Date

**CITY OF WICHITA**  
**STORM WATER SEWER**  
**STA. 15+800 TO STA. 16+200**  
**SEDGWICK COUNTY**

**Professional Engineering Consultants, P.A.**  
303 S. TOPEKA • WICHITA, KANSAS 67202  
 316-262-2691 • FAX 316-262-3003

Designed by	RCH	Checked by	WDH
Drawn by	JGP	Date	Apr 11, 2002
		Job No.	97362