

FHWA REGION NO.	STATE	PROJECT NO.	YEAR	SHEET NO.	TOTAL SHEETS
7	KANSAS	54-87 K-6657-01	2002	160	1122

DATE	
BY	
REFERENCES NOTED	
REFERENCES CHECKED	

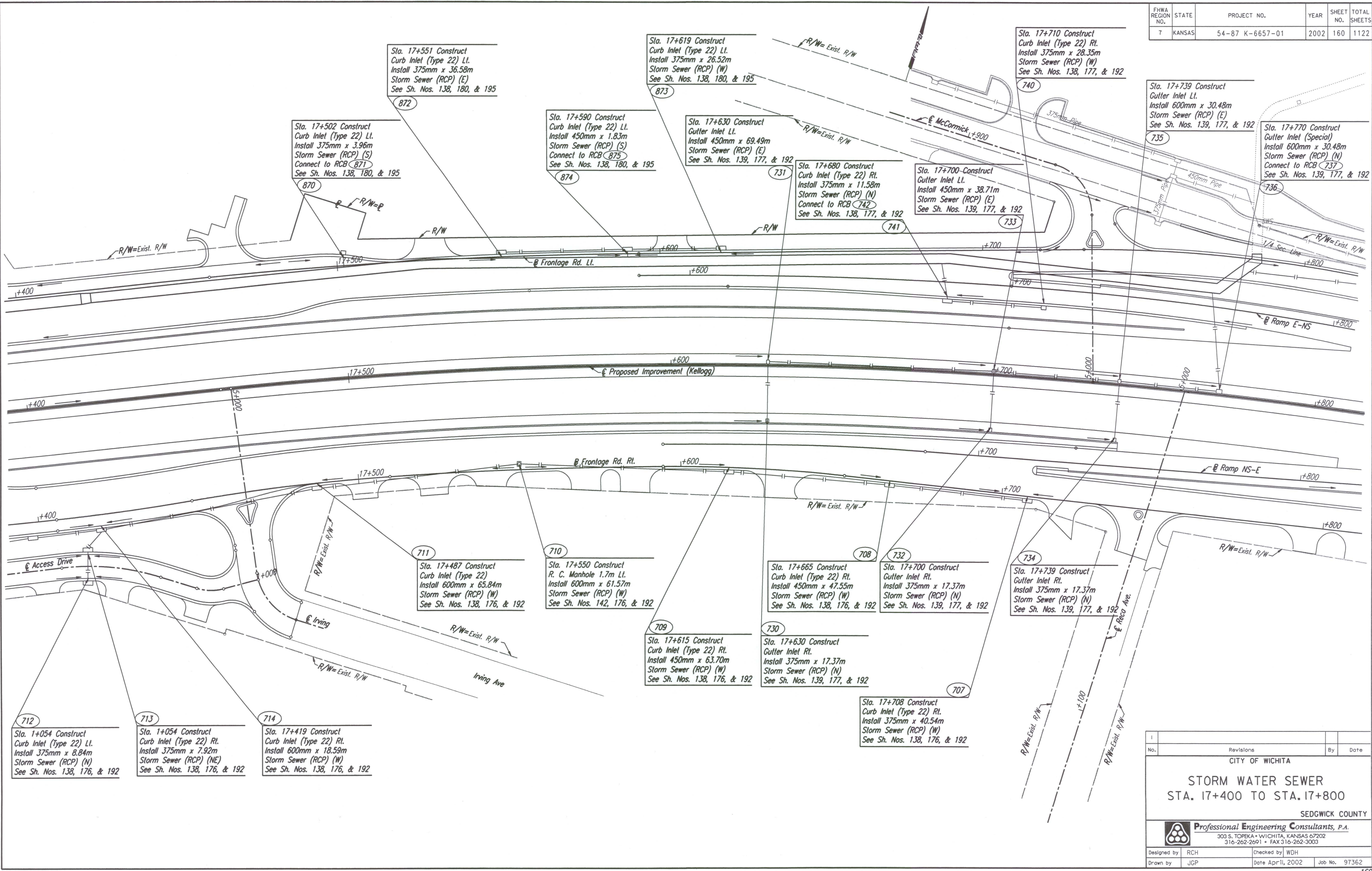

DSNR: JPS OPER: JGP SCALE: 1:500
 i:/1997/97362/SWS/SWS174.DGN 11-22-1999 13:25:28 LAST REV: 2-5-2002 BY: svb

No.	Revisions	By	Date
CITY OF WICHITA			
STORM WATER SEWER			
STA. 17+400 TO STA. 17+800			
SEDGWICK COUNTY			
Professional Engineering Consultants, P.A. 303 S. TOPEKA • WICHITA, KANSAS 67202 316-262-2691 • FAX 316-262-3003			
Designed by	RCH	Checked by	WDH
Drawn by	JGP	Date	Apr 11, 2002
		Job No.	97362