

STATE	PROJECT NO.	YEAR	SHEET NO.	TOTAL SHEETS
KANSAS	54-87 K-6657-01	2002	246	1122

DATE	
BY	
REFERENCES NOTED	
REFERENCES CHECKED	

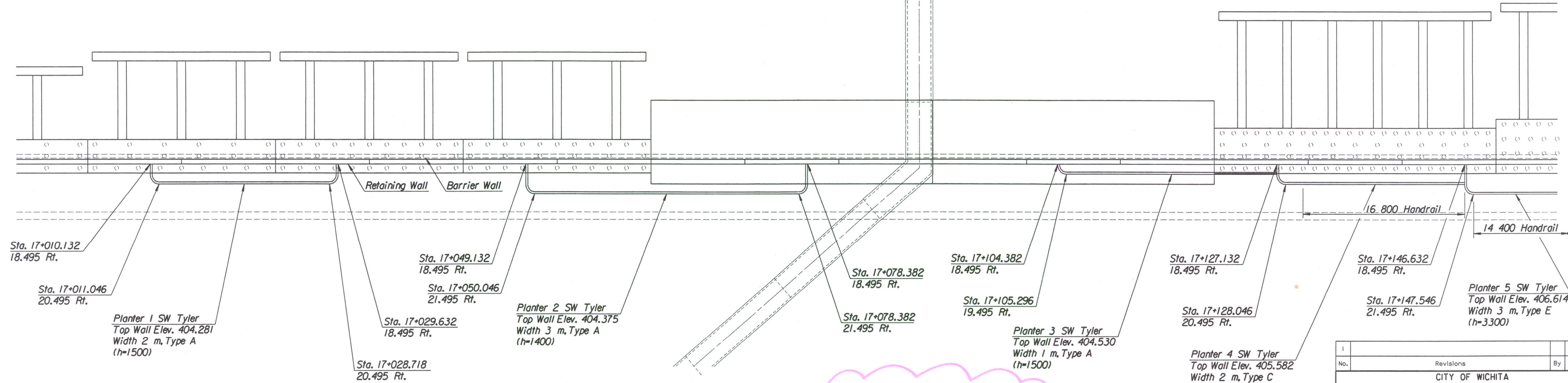
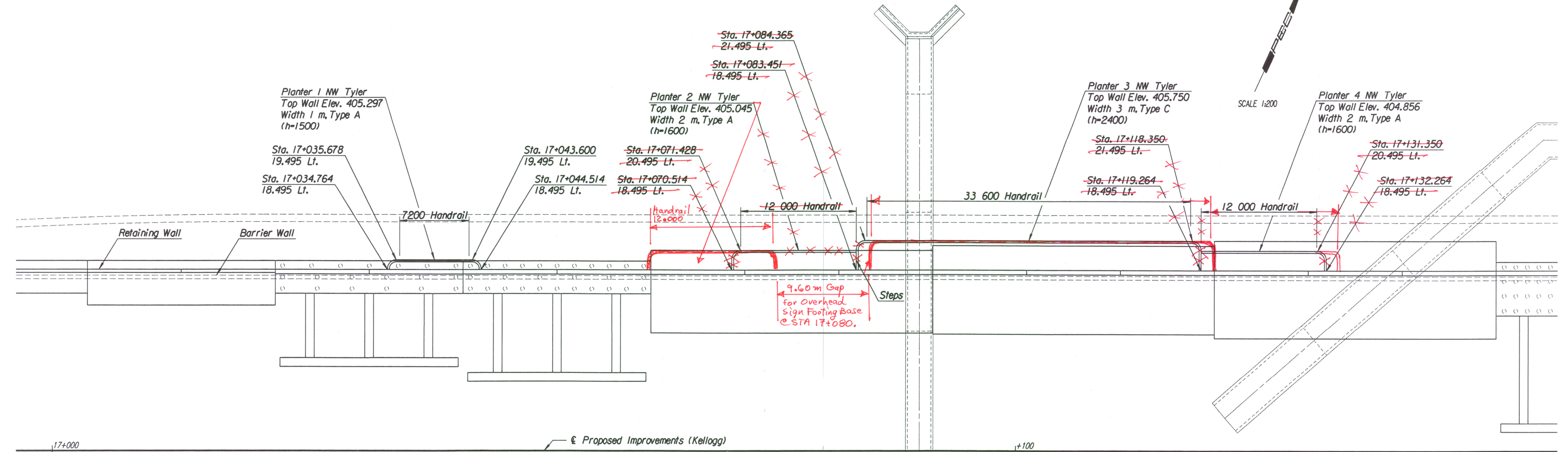

NOTE:
Mechanically Stabilized Earth (MSE) Walls were constructed in lieu of Cast-In-Place Retaining Walls. See Submittal #'s 21.1, 21.1.A, 21.2.A, 21.2.B, 21.2.C, 21.3.A, 34.1.A, 34.1.B, 34.2.A, 34.3.A & 34.3. Also see Special Provision 90M-110-R3.

Note: See Sheet No. 238A for Wall Type A thru Wall Type E. *It equals Top of Planter Wall to Bottom of Footing.

No.	Revisions	By	Date

CITY OF WICHITA

KELLOGG

CAST IN PLACE RETAINING WALL
STA. 17+005 to STA. 17+156
SEDGWICK COUNTY

Professional Engineering Consultants, P.A.
303 S. TOPEKA • WICHITA, KANSAS 67202
316-262-2691 • FAX 316-262-3003

Designed by	PDF	Checked by	RAS
Drawn by	DRP	Date	April, 2002
		Job No.	97362

DSNR: PDF OPER: DRP SCALE: 1:200
 I:/1997/97362/001/RETWALL/PLANTWALL7.DGN 3-20-2002 15:56:12 LAST REV: 4-11-2002 BY: drp