

| | | | | |
|--------|-----------------|------|-----------|--------------|
| STATE | PROJECT NO. | YEAR | SHEET NO. | TOTAL SHEETS |
| KANSAS | 54-87 K-6657-01 | 2002 | 264 | 1122 |

| | |
|--------------------|--|
| DATE | |
| BY | |
| REFERENCES NOTED | |
| REFERENCES CHECKED | |

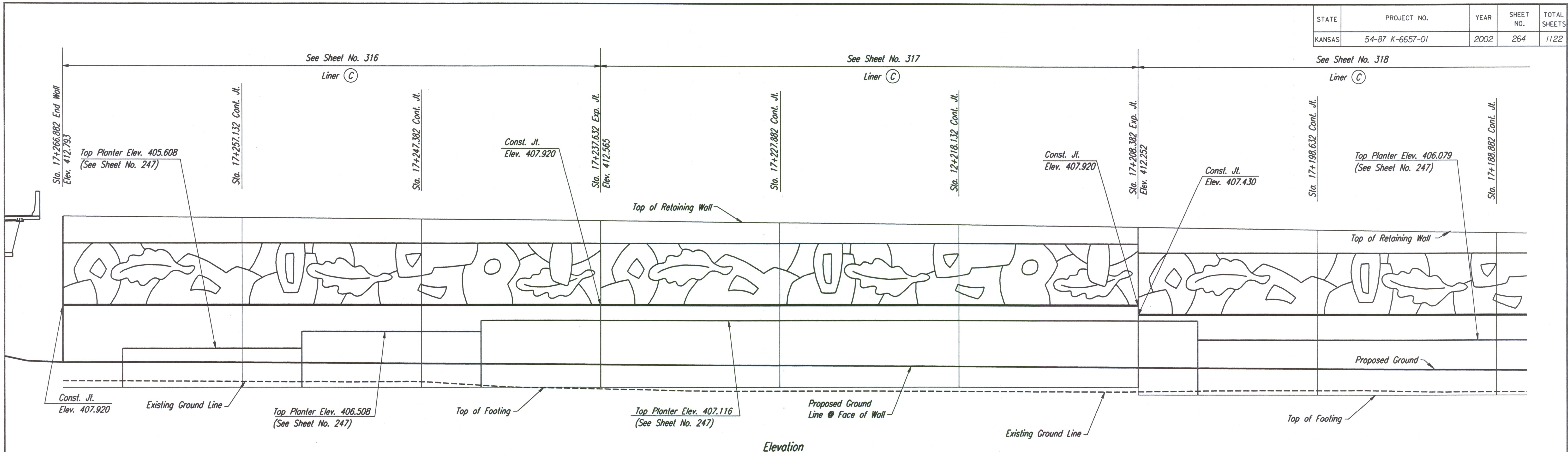

Elevation

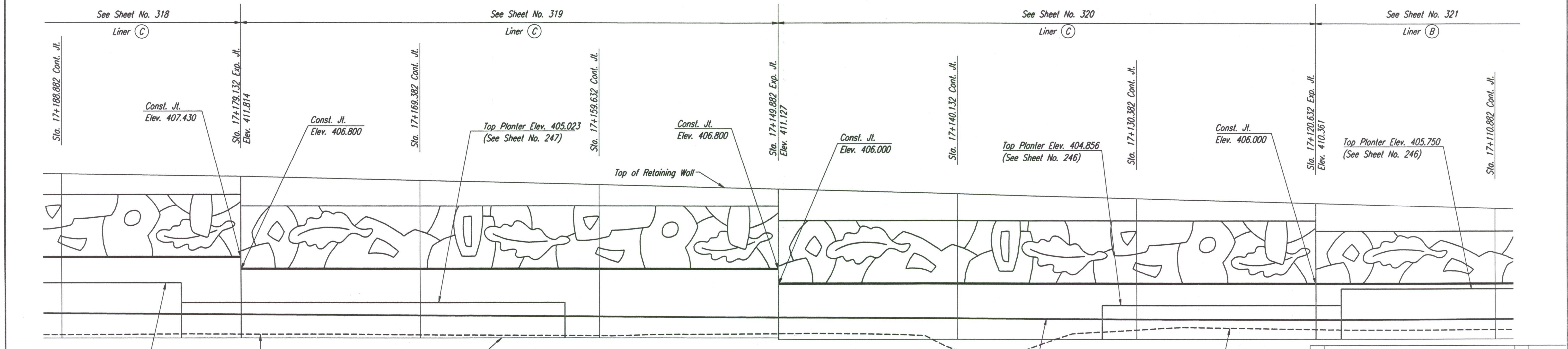

Elevation

NOTE:
Mechanically Stabilized Earth (MSE)
Walls were constructed in lieu of Cast-In-Place Retaining Walls.
See Submittal #'s 21.1, 21.1.A, 21.2.A, 21.2.B, 21.2.C, 21.3.A, 34.1.A, 34.1.B, 34.2.A, 34.3.A & 34.3.
Also see Special Provision 90M-110-R3.

DSNR: DWH OPER: JCP SCALE: 1:100
 1/1997/97362/WALL PLAN/TYLERNE.DGN 3-15-2002 11:25:02 LAST REV: BY:

| | | | |
|---|-----------|------------|-------------|
| No. | Revisions | By | Date |
| | | | |
| CITY OF WICHITA | | | |
| KELLOGG | | | |
| CAST-IN-PLACE RETAINING WALLS | | | |
| TYLER NW ELEVATION | | | |
| SEDGWICK COUNTY | | | |
| Professional Engineering Consultants, P.A. 303 S. TOPEKA • WICHITA, KANSAS 67202 316-262-2691 • FAX 316-262-3003 | | | |
| Designed by | PDF | Checked by | RAS |
| Drawn by | JSB | Date | April, 2002 |
| | | Job No. | 97362 |