

LAYOUT INFORMATION				
Point No.	North Coordinate	East Coordinate	Station	Offset
1	511381.399	491499.713	15+499.607	14.795 Lt.
2	511385.942	491498.993	15+499.607	19.395 Lt.
3	511390.633	491527.857	15+529.004	19.395 Lt.
4	511386.095	491528.613	15+529.004	14.795 Lt.

REINFORCING STEEL							
Straight Bars			Bent Bars				
Mark	Size	Number	Length	Mark	Size	Number	Length
BI-1	*25	342	4520	BI-3	*29	195	3940
BI-2	*25	60	15 540	BI-4	*19	195	2620
				BI-5	*25	195	2110
BI-6	*25	195	4450				
BI-7	*13	99	3600	BI-9	*19	99	1350
BI-8	*16	147	9650				
BI-10	*19	99	4150				
BI-11	*13	99	4250				
BI-12	*29	60	4000				

WALL QUANTITIES		
Item	Quantity	Unit
Pressure Grouted Pile (406 mm)	840.0	m
Concrete (Grade 30(AE))	262.4	m ³
Reinforcing Steel (Grade 420)	25 363	kg
Class III Excavation	278.6	m ³

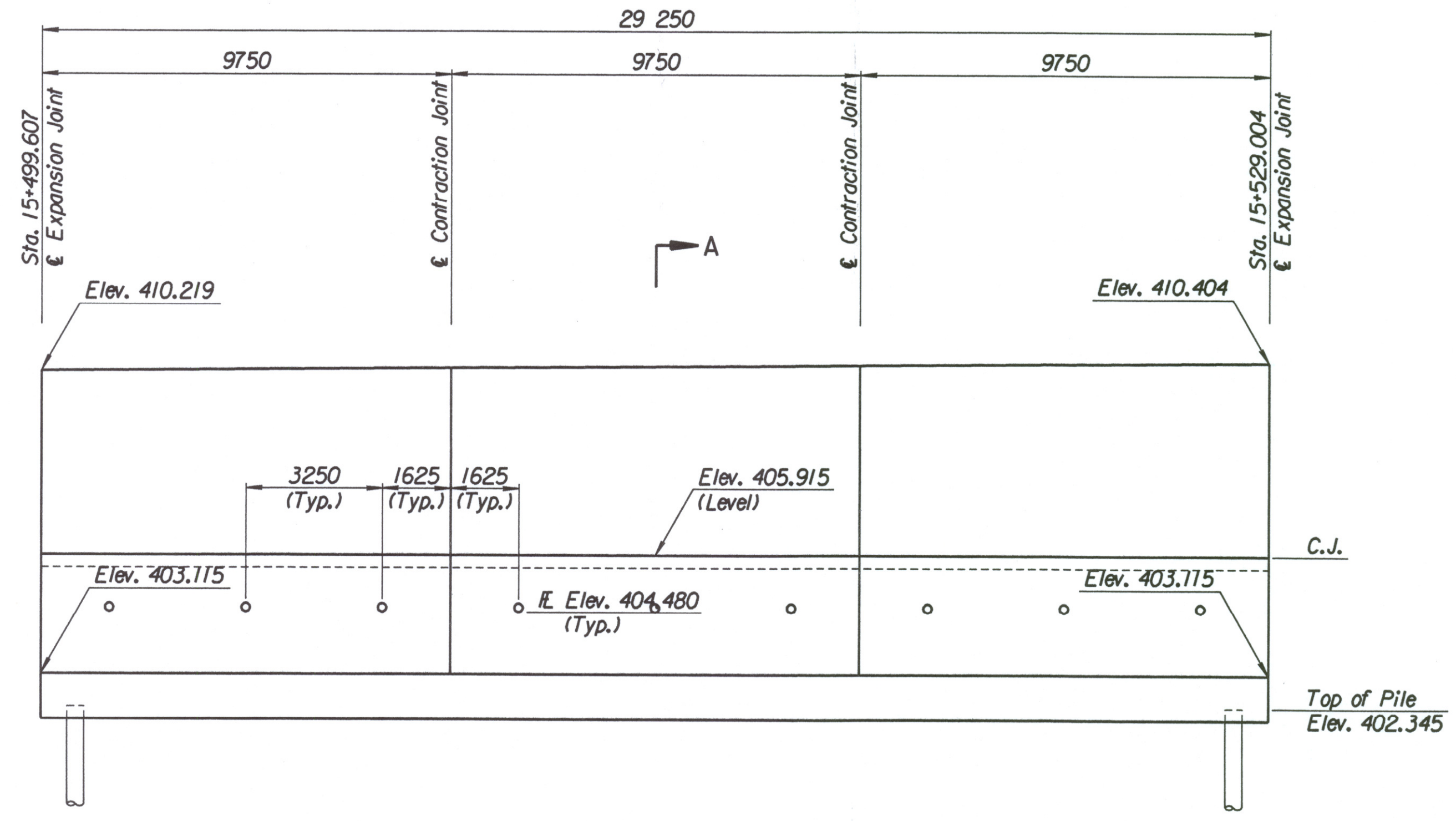

ELEVATION

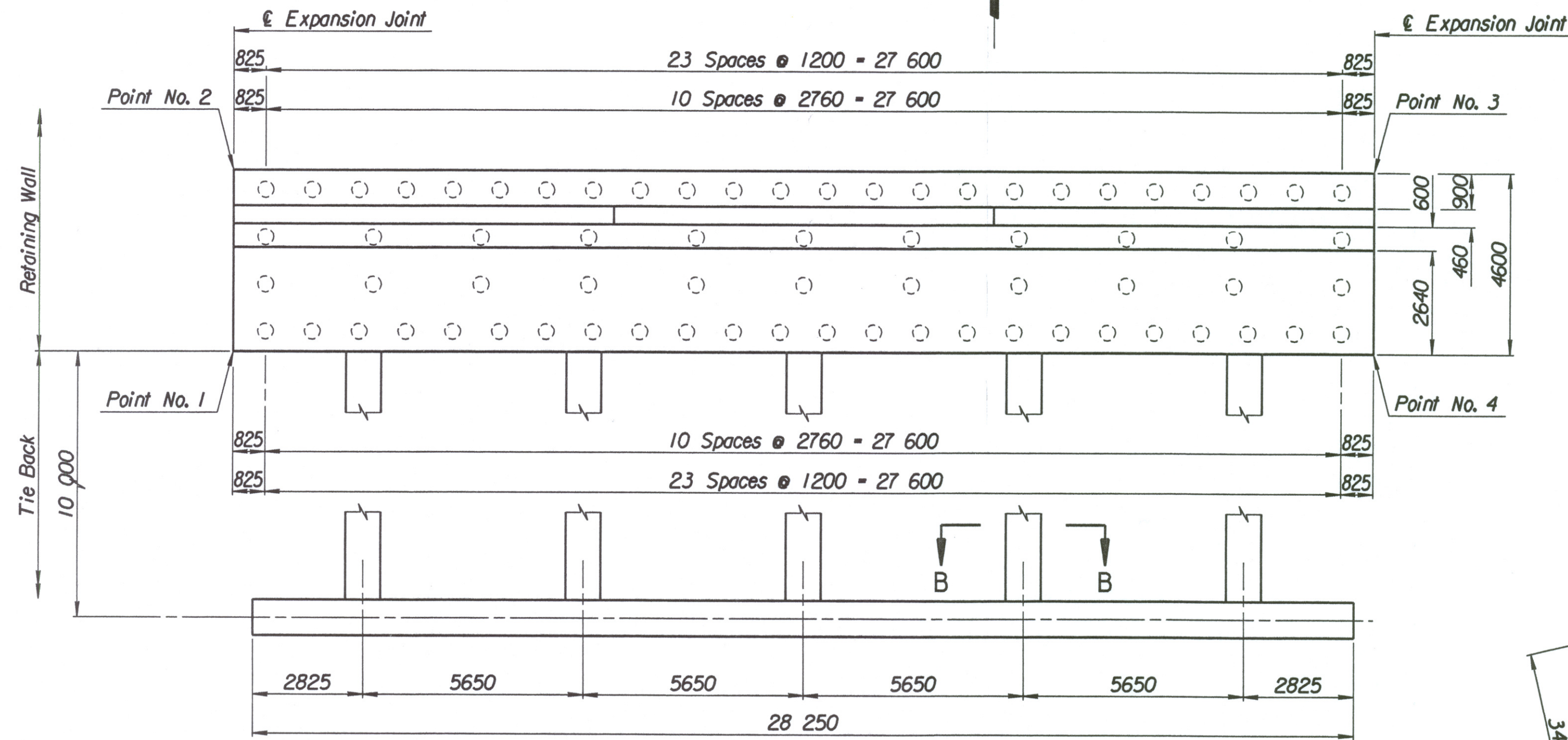

PLAN

TIE BACK REINFORCING STEEL							
Straight Bars			Bent Bars				
Mark	Size	Number	Length	Mark	Size	Number	Length
BI-16	*25	36	15 040	BI-13	*13	160	2740
				BI-14	*29	60	10 500
				BI-15	*13	94	5700

TIE BACK QUANTITIES		
Item	Quantity	Unit
Concrete (Grade 30(AE))	80.0	m ³
Reinforcing Steel (Grade 420)	6307	kg

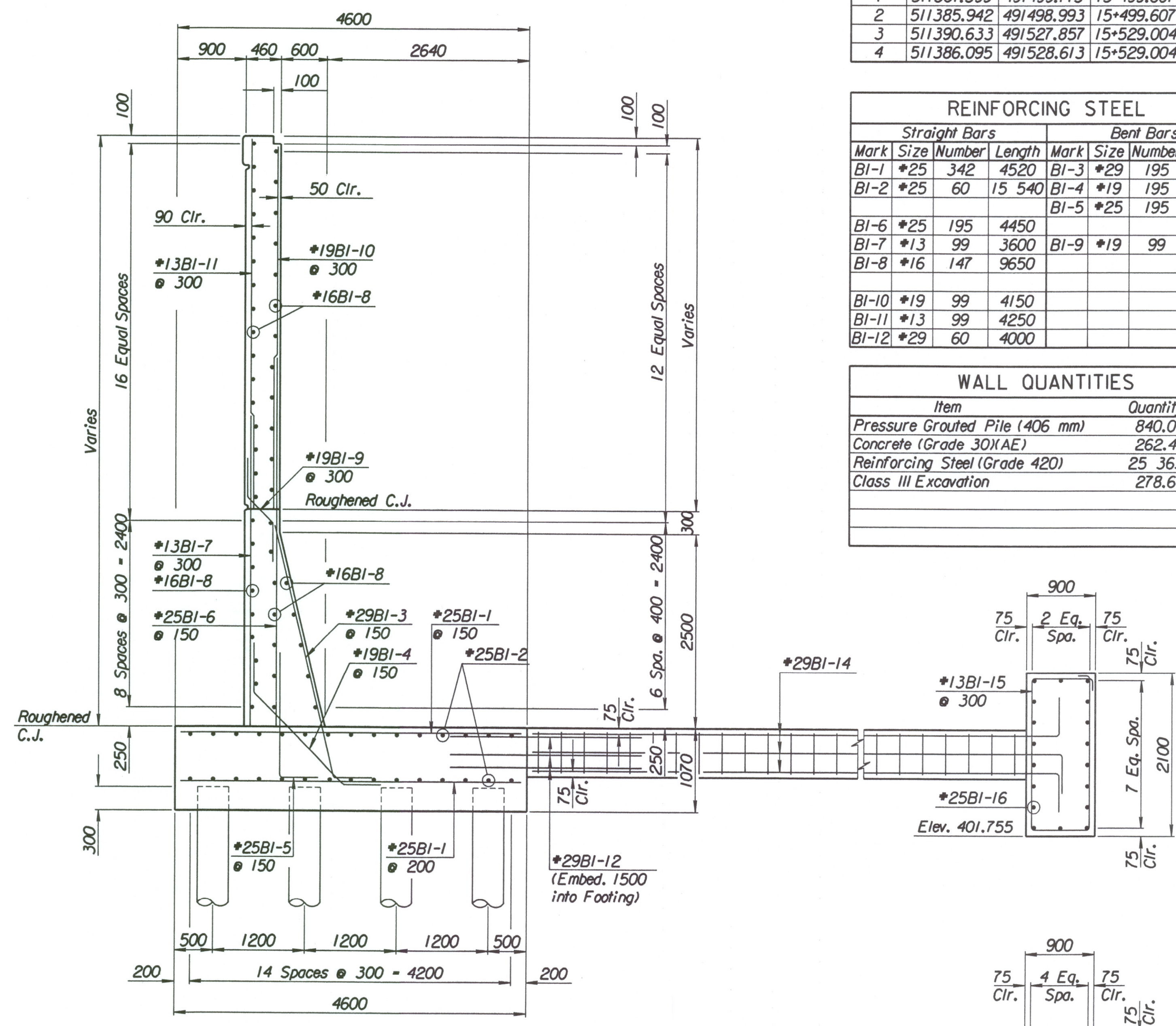

SECTION A-A

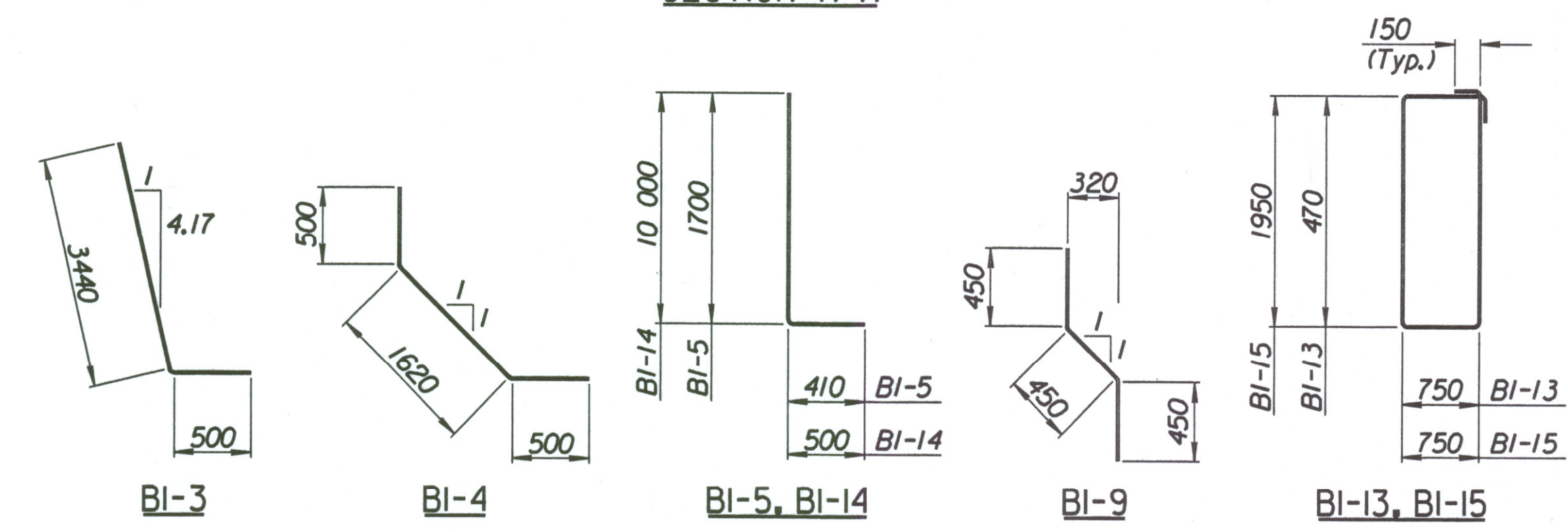

SECTION B-B

No.	Revisions	By	Date

CITY OF WICHITA
MAIZE NORTHWEST WALL
 STA. 15+499.607 TO STA. 15+529.004
 SEDGWICK COUNTY

Professional Engineering Consultants, P.A.
 303 S. TOPEKA • WICHITA, KANSAS 67202
 316-262-2691 • FAX 316-262-3003

Designed by P.D.F. Checked by R.A.S.
 Drawn by W.L.L. Date Apr. 2002 Job No. 97362

Drawn by: will
 Plotted by: drp 3-25-2002
 i:/1997/97362/001/bridge/maizerd/NWwall-2