

Point No.	North Coordinate	East Coordinate	Station	Offset
1	511417.072	491691.805	15+695.791	14.795 Lt.
2	511421.571	491690.846	15+695.791	19.395 Lt.
3	511427.784	491719.421	15+725.188	19.395 Lt.
4	511423.293	491720.416	15+725.188	14.795 Lt.

Straight Bars				Bent Bars			
Mark	Size	Number	Length	Mark	Size	Number	Length
B2-1	*25	342	4520	B2-3	*29	195	3940
B2-2	*25	60	15 540	B2-4	*19	195	2620
				B2-5	*29	195	2500
B2-6	*29	195	5040				
B2-7	*13	99	3800	B2-9	*19	99	1350
B2-8	*16	147	9650				
B2-10	*19	99	4180				
B2-11	*13	99	4280				
B2-12	*29	72	4000				

Item	Quantity	Unit
Pressure Grouted Pile (406 mm)	888.0	m
Concrete (Grade 30(AE))	264.3	m ³
Reinforcing Steel (Grade 420)	27 904	kg
Class III Excavation	350.2	m ³

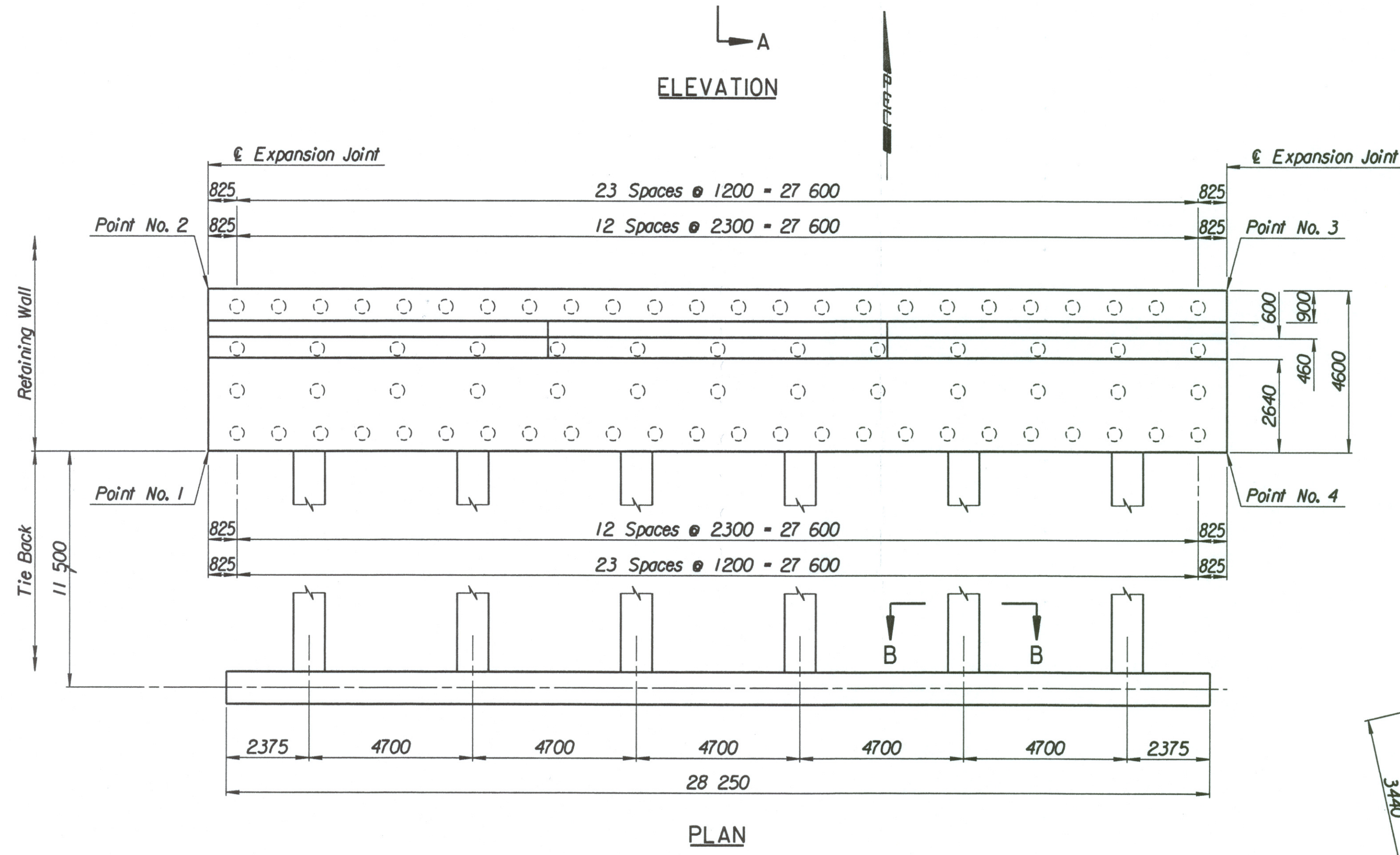
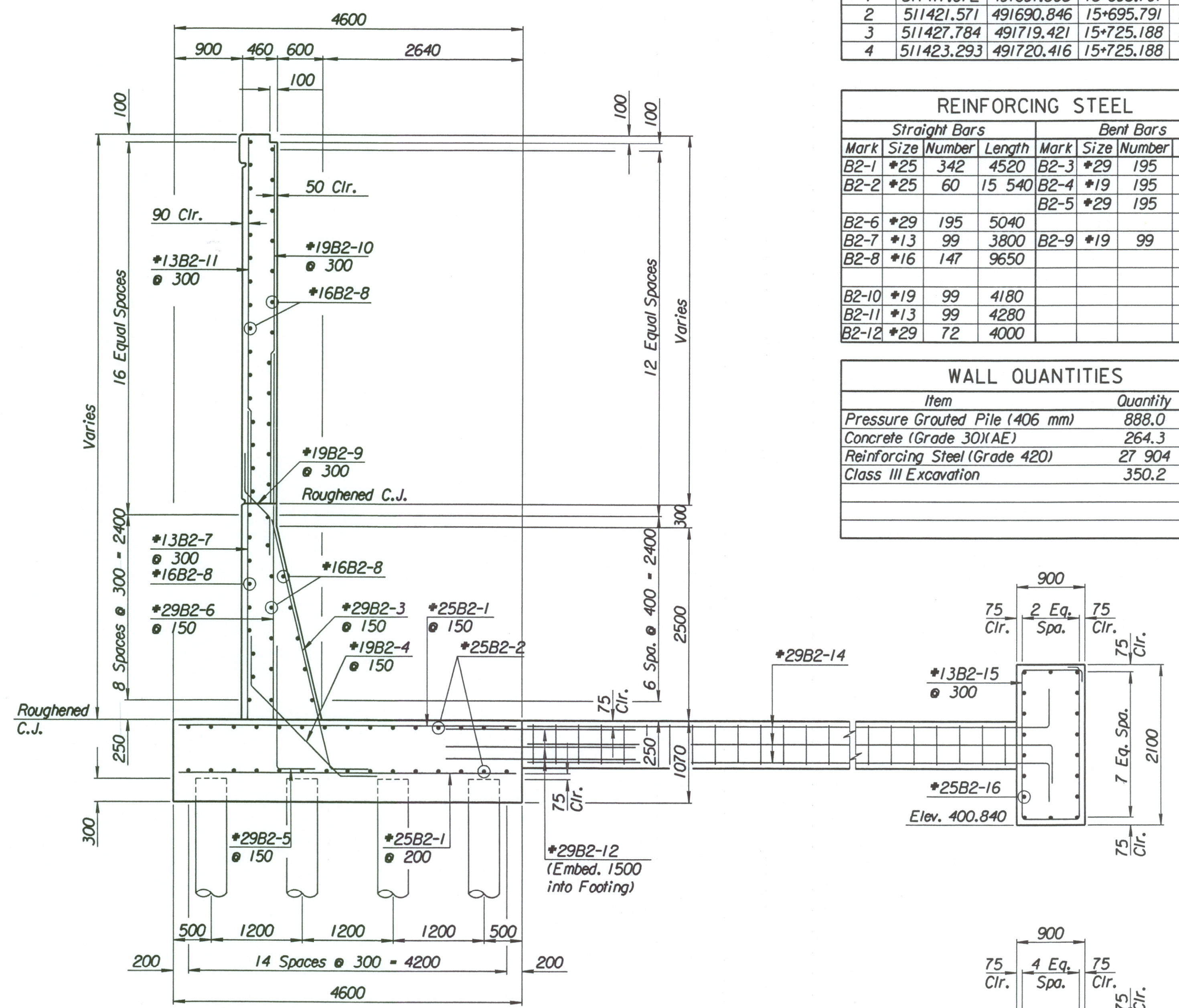
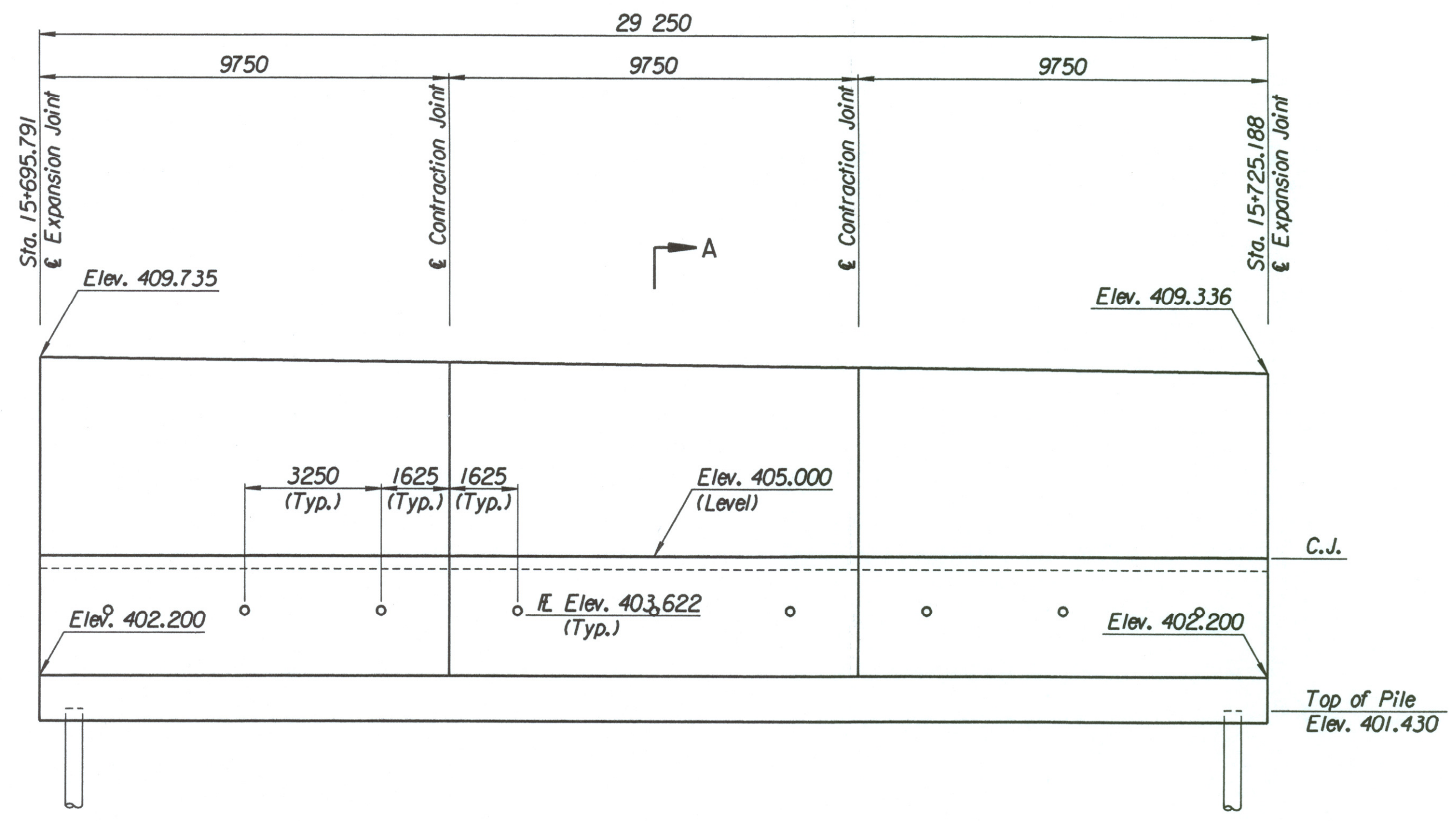

Straight Bars			Bent Bars		
Mark	Size	Length	Mark	Size	Length
B2-16	*25	36	B2-13	*13	222
		15 040	B2-14	*29	72
			B2-15	*13	94
					5700

Item	Quantity	Unit
Concrete (Grade 30(AE))	90.4	m ³
Reinforcing Steel (Grade 420)	7660	kg

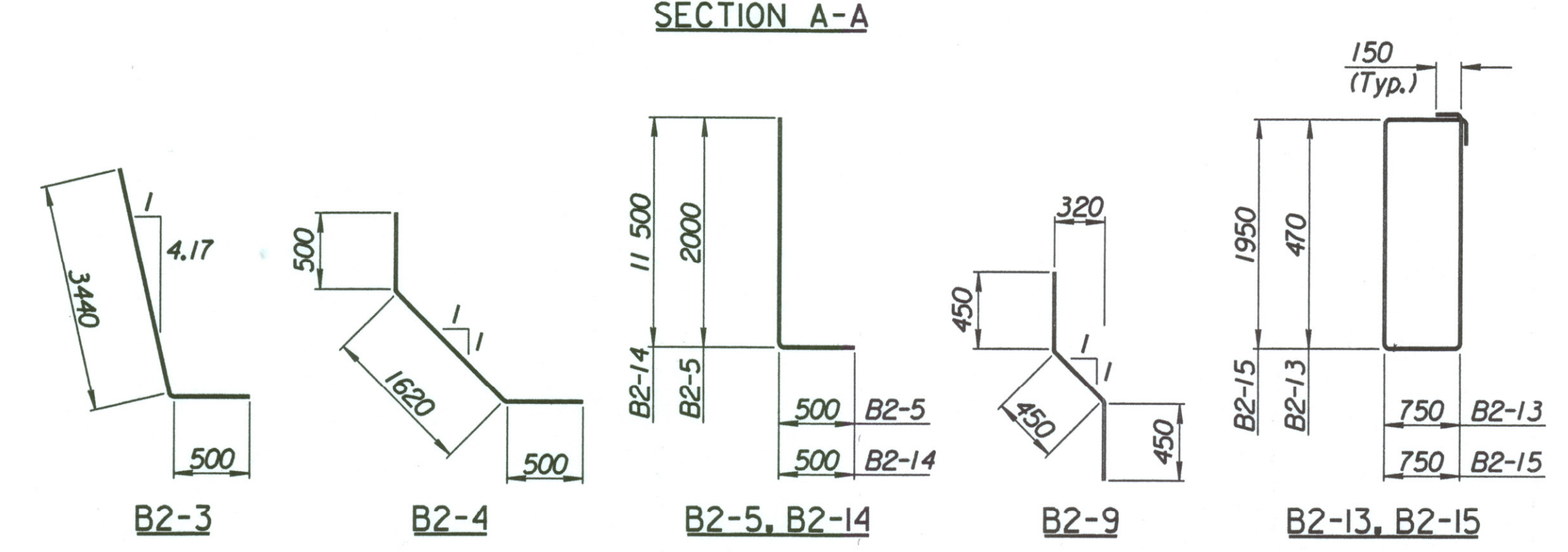

No.	Revisions	By	Date
CITY OF WICHITA			
MAIZE NORTHEAST WALL			
STA. 15+695.791 TO STA. 15+725.188			
SEDGWICK COUNTY			
 Professional Engineering Consultants, P.A. 303 S. TOPEKA • WICHITA, KANSAS 67202 316-262-2691 • FAX 316-262-3003			
Designed by	P.D.F.	Checked by	R.A.S.
Drawn by	W.L.L.	Date	Apr., 2002
		Job No.	97362

Drawn by: will
 Plotted by: drp 3-25-2002
 i:/1997/97362/001/bridge/maizerd/NEWall-7