

LAYOUT INFORMATION				
Point No.	North Coordinate	East Coordinate	Station	Offset
1	511913.993	492988.454	17+091.382	11.895 Lt.
2	511922.247	492984.620	17+091.382	20.995 Lt.
3	511934.568	493011.148	17+120.632	20.995 Lt.
4	511926.315	493014.982	17+120.632	11.895 Lt.

REINFORCING STEEL							
Straight Bars			Bent Bars				
Mark	Size	Number	Length	Mark	Size	Number	Length
F5-1	*29	294	9020	F5-3	*29	195	3950
F5-2	*29	120	16 000	F5-4	*19	195	2600
				F5-5	*29	195	2500
F5-6	*29	195	5510				
F5-7	*13	99	4270	F5-9	*19	99	1350
F5-8	*16	141	9650				
F5-10	*19	99	3360				
F5-11	*13	99	3460				

WALL QUANTITIES		
Item	Quantity	Unit
Concrete (Grade 30XAE)	314.5	m
Reinforcing Steel (Grade 420)	39 982	kg <sup>3</sup>
Class III Excavation	1305.3	m <sup>3</sup>

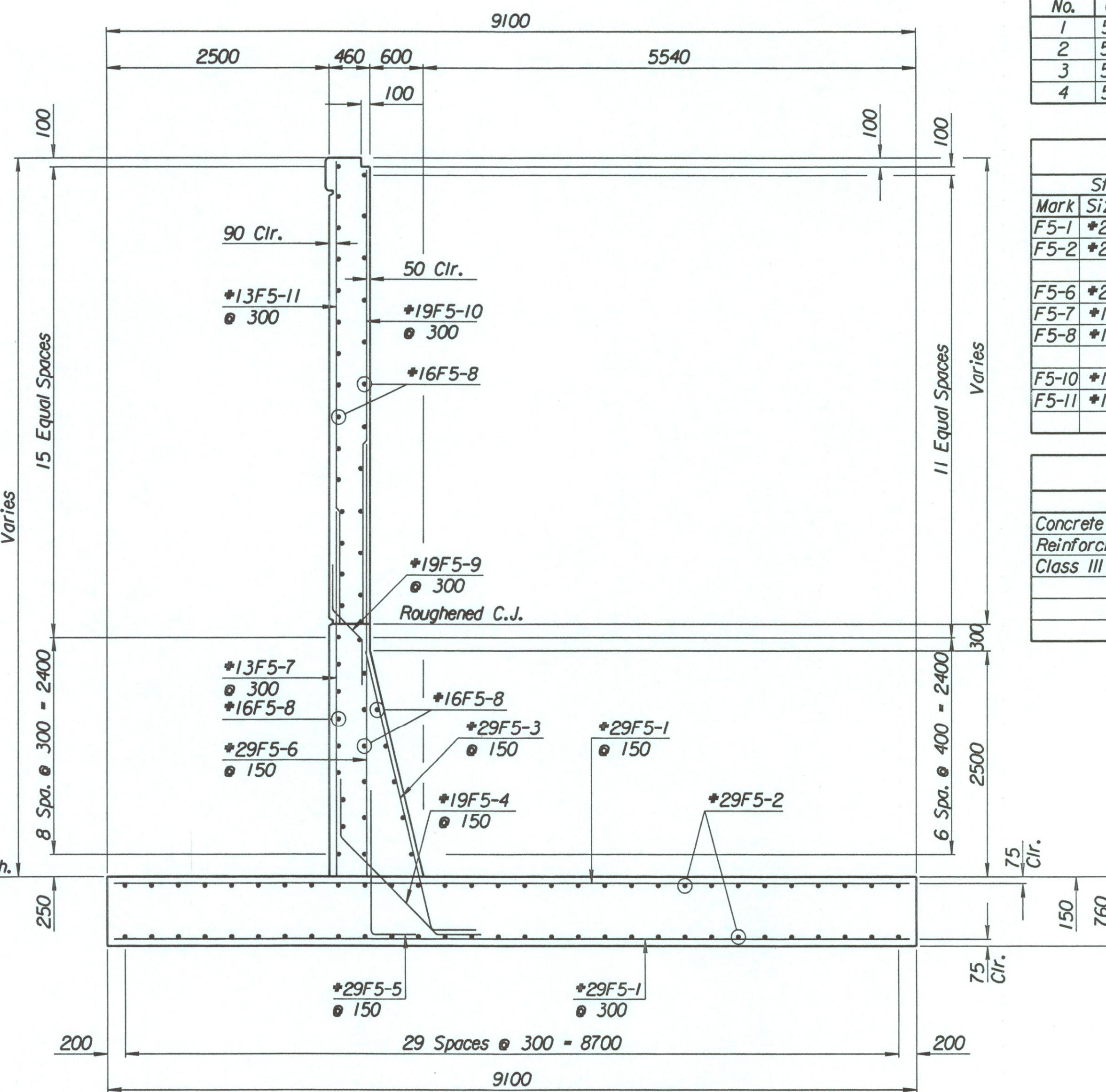
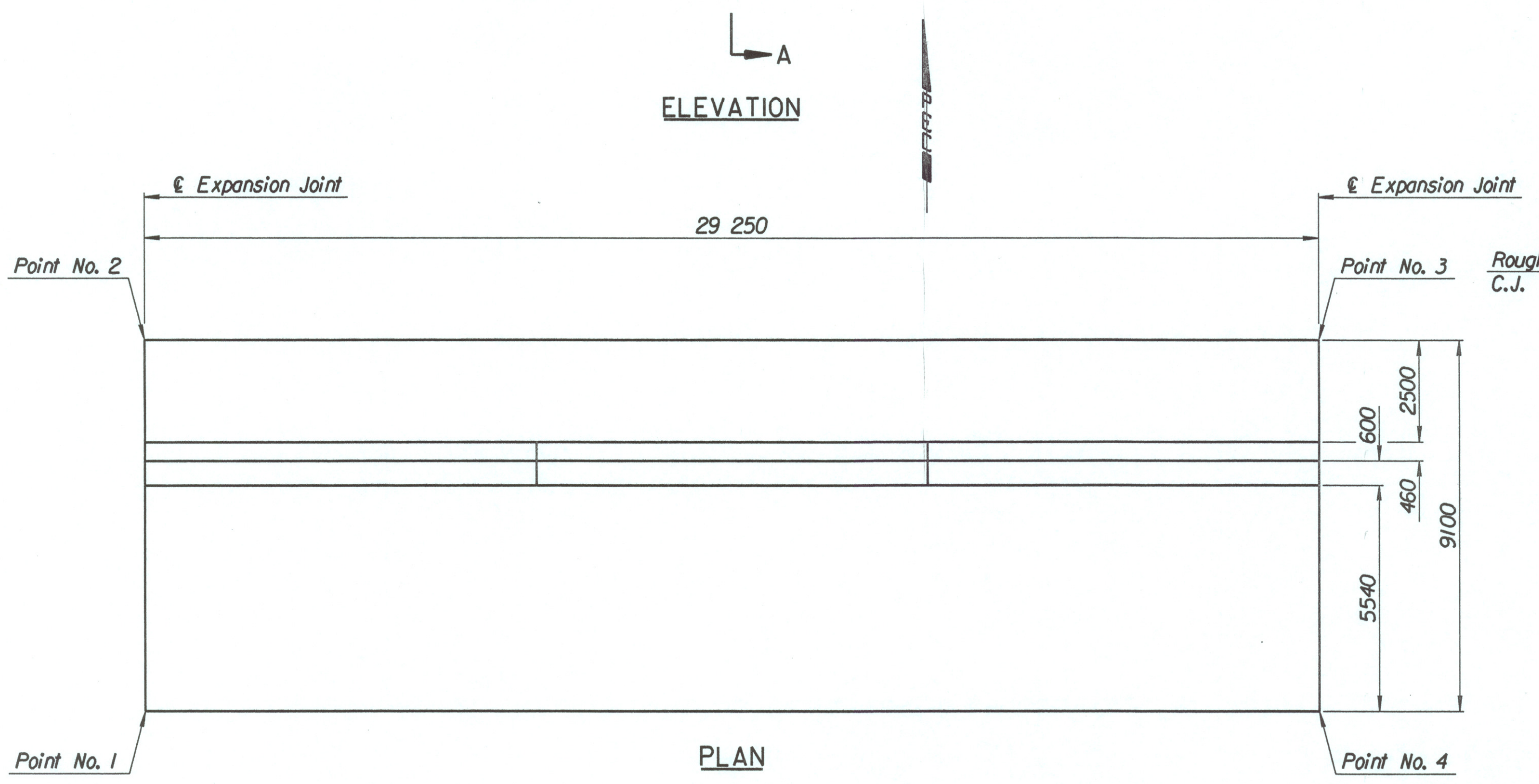
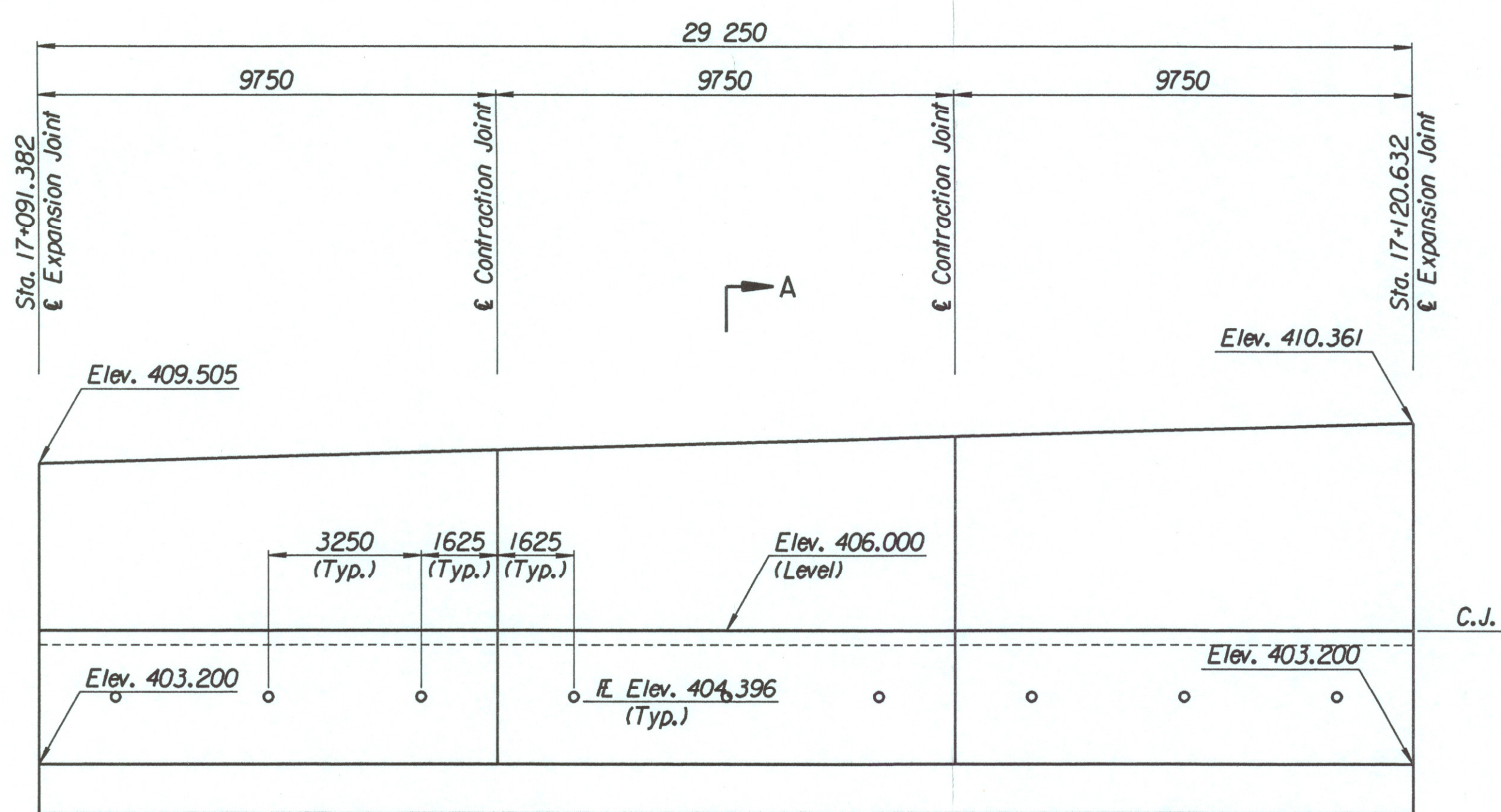

SECTION A-A

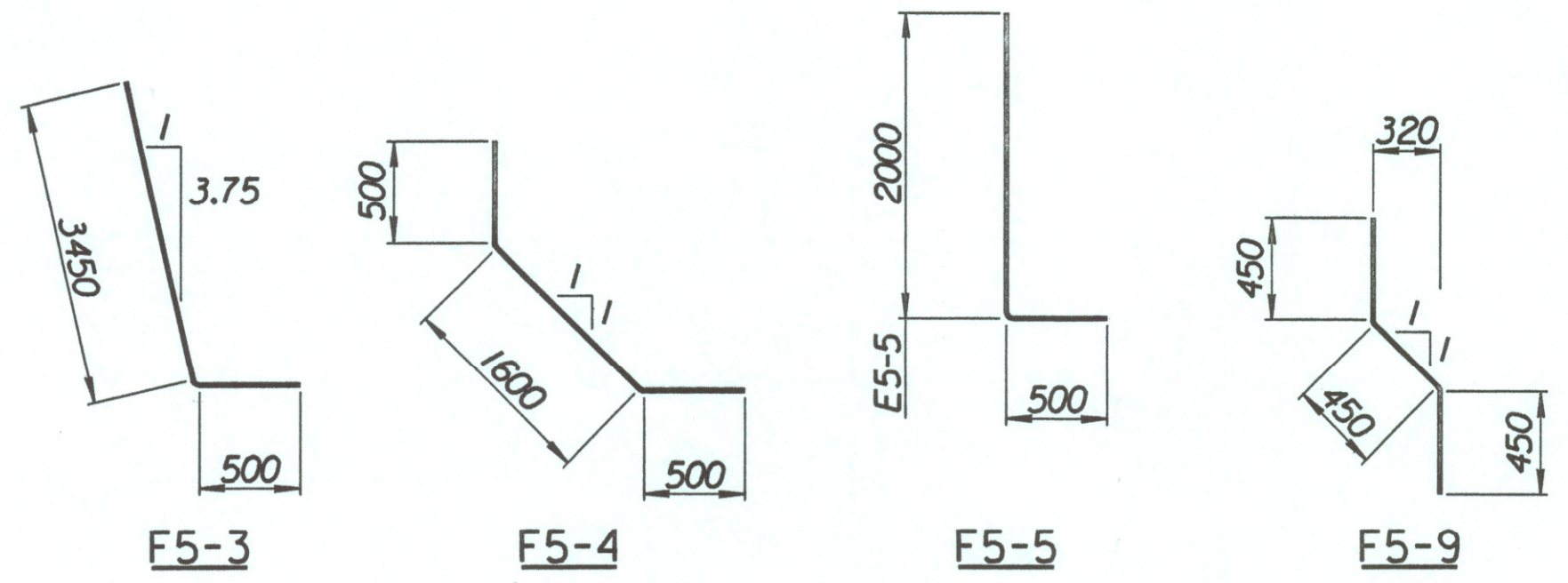

BENDING DIAGRAMS  
All dimensions are out to out of bars.

Excavate to Elevation 399.6 and compact backfill.  
See "Overexcavation and Compaction Detail" on Sheet No. 238.

Drawn by: wll  
Plotted by: drp  
3-28-2002  
i:\1997\97362\001\bridge\tylerd\NWwall-6

No.	Revisions	By	Date

CITY OF WICHITA

**TYLER NORTHWEST WALL**  
STA. 17+091.382 TO STA. 17+120.632  
SEDGWICK COUNTY

**Professional Engineering Consultants, P.A.**  
303 S. TOPEKA • WICHITA, KANSAS 67202  
316-262-2691 • FAX 316-262-3003

Designed by	P.D.F.	Checked by	R.A.S.
Drawn by	W.L.L.	Date	Apr 11, 2002
		Job No.	97362