

LAYOUT INFORMATION				
Point No.	North Coordinate	East Coordinate	Station	Offset
1	512051.674	493359.684	17+486.404	19.395 Rt.
2	512055.879	493357.819	17+486.404	14.795 Rt.
3	512067.501	493384.741	17+516.020	14.795 Rt.
4	512063.260	493386.522	17+516.020	19.395 Rt.

REINFORCING STEEL							
Straight Bars				Bent Bars			
Mark	Size	Number	Length	Mark	Size	Number	Length
D7-1	*25	246	4520	D7-3	*25	195	3160
D7-2	*25	60	15 540	D7-4	*19	195	2320
				D7-5	*25	195	1910
D7-6	*25	195	4330				
D7-7	*13	99	3480	D7-9	*19	99	1350
D7-8	*16	129	9650				
D7-10	*19	99	3480				
D7-11	*13	99	3580				
D7-12	*29	48	4000				

WALL QUANTITIES		
Item	Quantity	Unit
Pressure Grouted Pile (406 mm)	672.0	m
Concrete (Grade 30/AE)	218.8	m ³
Reinforcing Steel (Grade 420)	21 083	kg
Class III Excavation	331.7	m ³

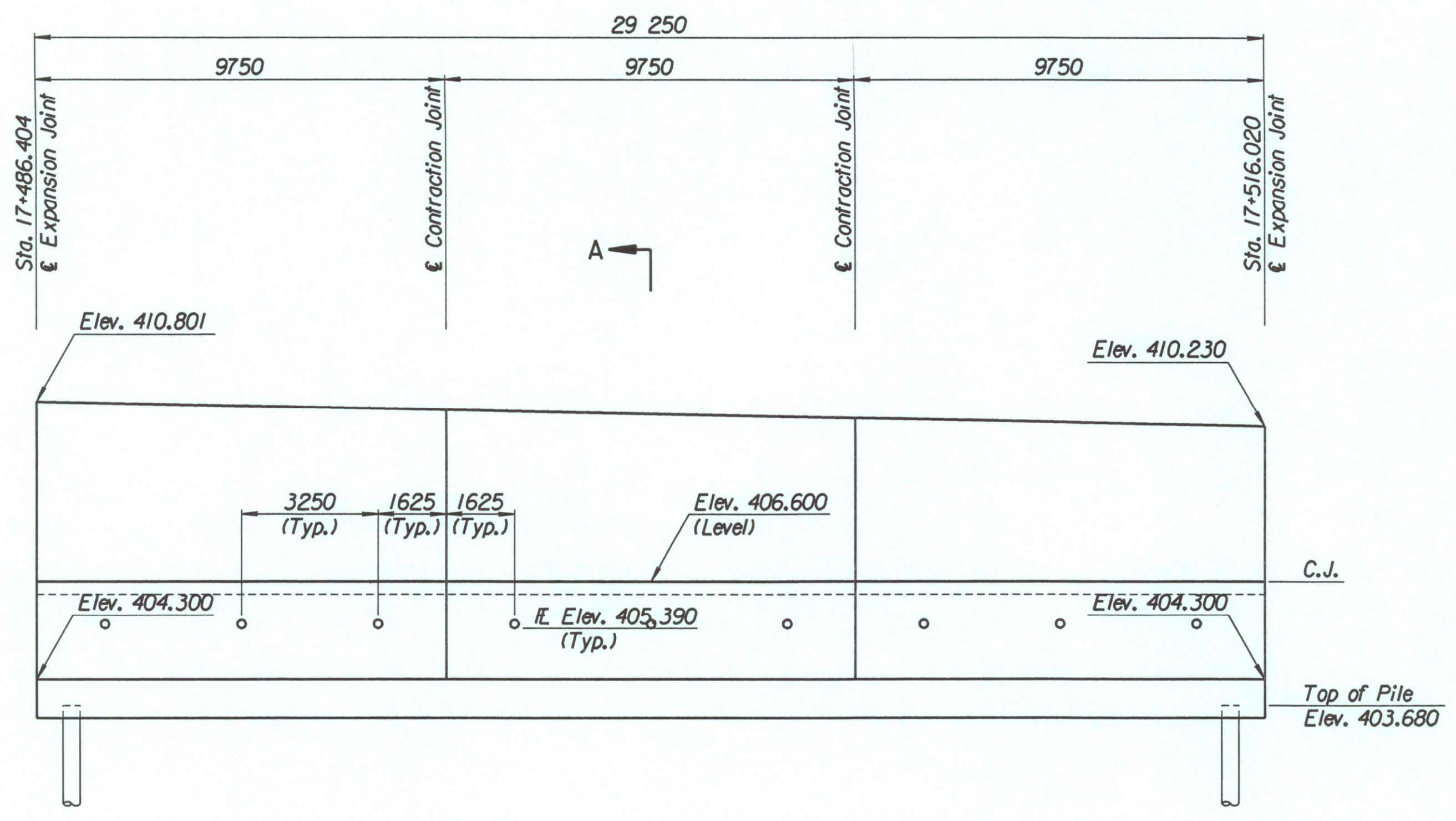

ELEVATION

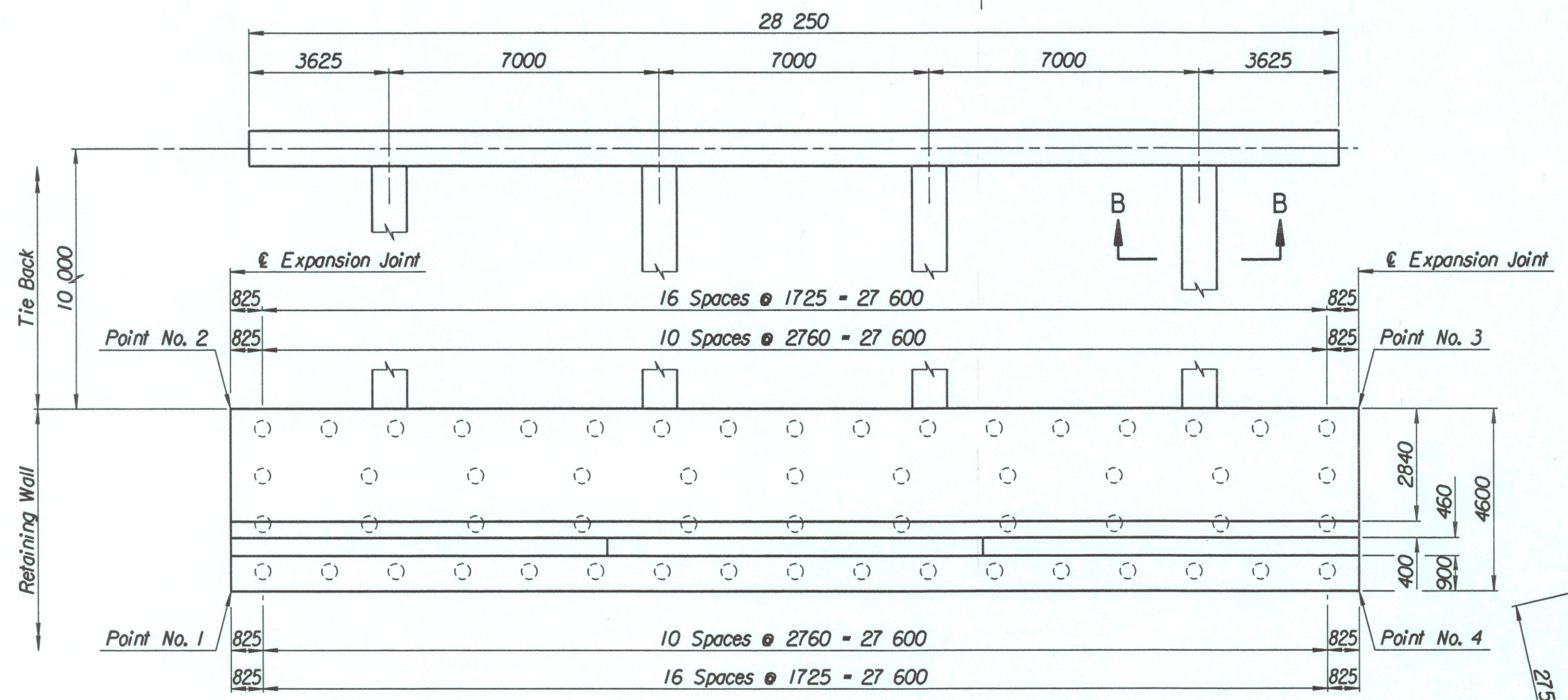

PLAN

TIE BACK REINFORCING STEEL							
Straight Bars				Bent Bars			
Mark	Size	Number	Length	Mark	Size	Number	Length
D7-16	*25	32	15 040	D7-13	*13	128	2740
				D7-14	*29	48	10 500
				D7-15	*13	94	5100

TIE BACK QUANTITIES		
Item	Quantity	Unit
Concrete (Grade 30/AE)	67.1	m ³
Reinforcing Steel (Grade 420)	5288	kg

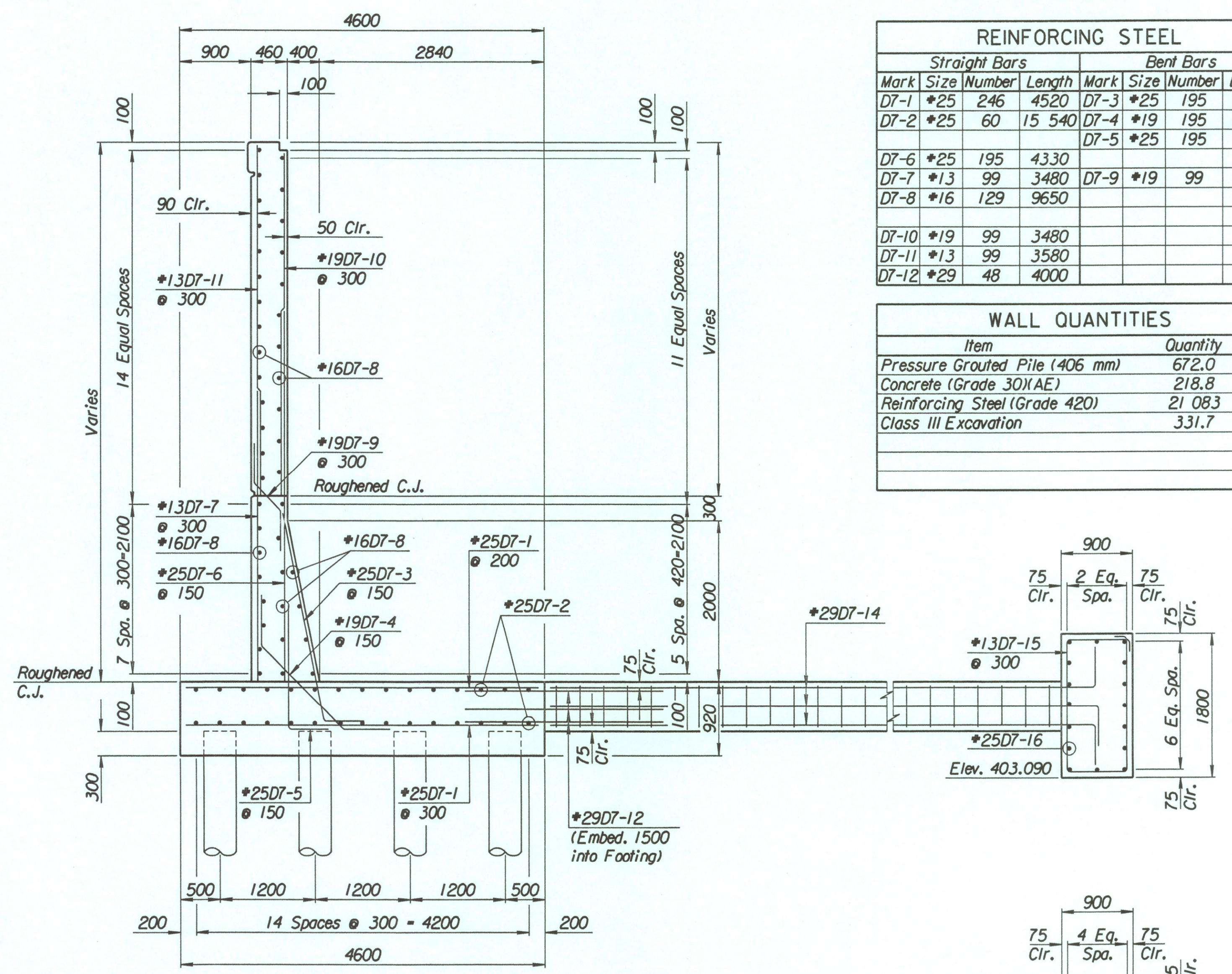

SECTION A-A

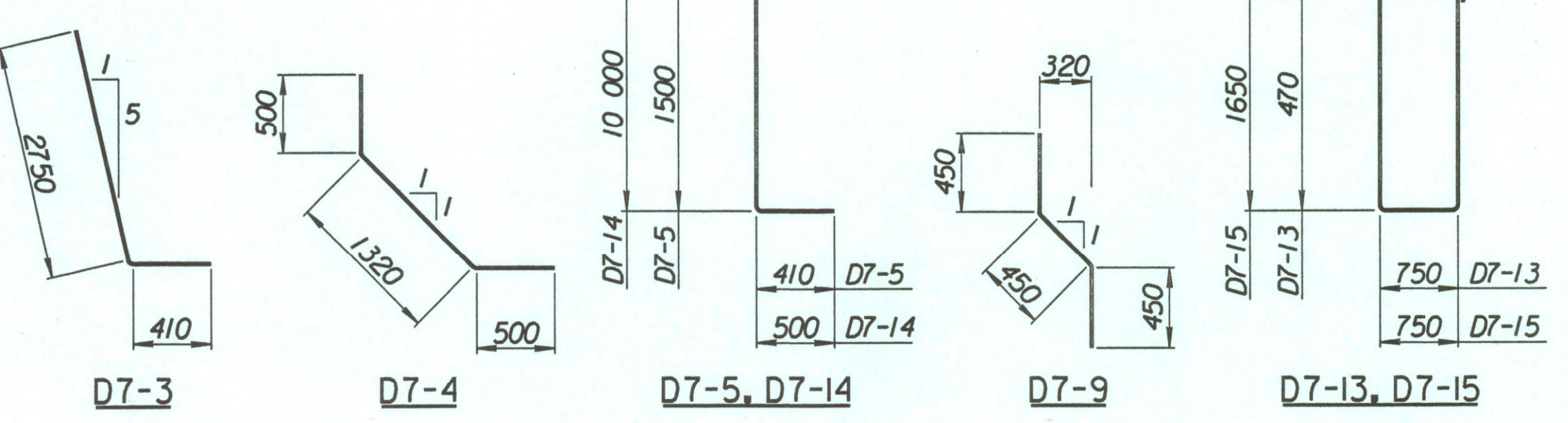

SECTION B-B

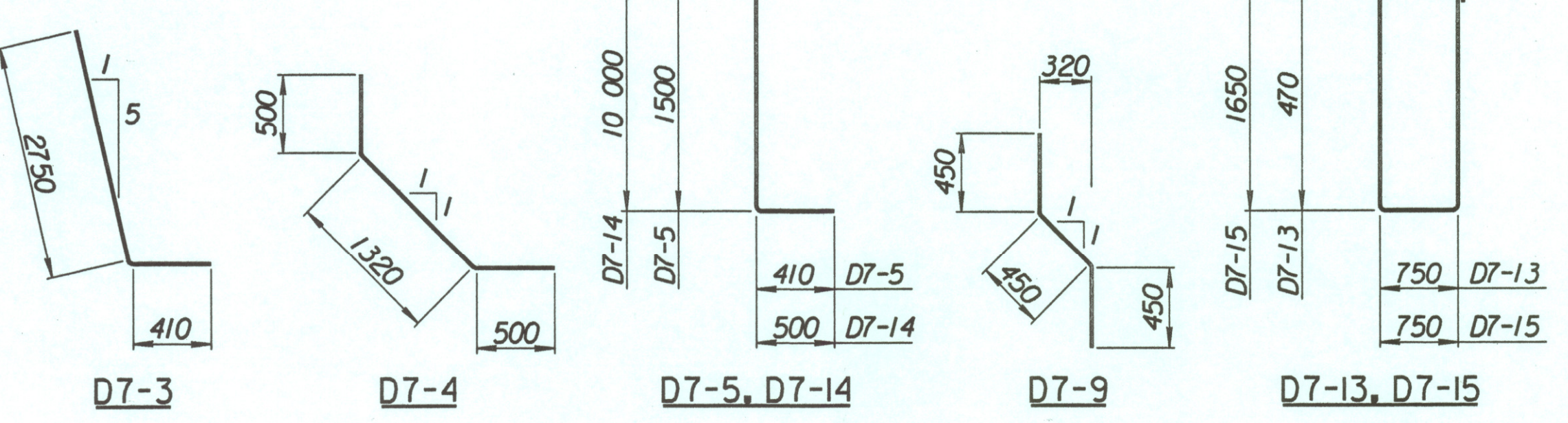

BENDING DIAGRAMS
All dimensions are out to out of bars.

No.	Revisions	By	Date

CITY OF WICHITA
TYLER SOUTHEAST WALL
STA. 17+486.404 TO STA. 17+516.020
SEDGWICK COUNTY

Professional Engineering Consultants, P.A.
303 S. TOPEKA • WICHITA, KANSAS 67202
316-262-2691 • FAX 316-262-3003

Designed by P.D.F. Checked by R.A.S.
Drawn by W.L.L. Date April, 2002 Job No. 97362

Drawn by: wll
 Plotted by: drp 3-22-2002
 i:\1997\97362\001\bridge\tyler\sd\wall-4