

STATE	PROJECT NO.	YEAR	SHEET NO.	TOTAL SHEETS
KANSAS	54-87 K-6657-01	2002	382	1122

DATE	BY
REFERENCES NOTED	REFERENCES CHECKED

DSNR: WDH OPER: JGP SCALE: 1:500
 I:\1997\97362\001\RETWALL\TYLERWEST PLAN.DGN 3-11-2002 15:52:14 LAST REV: BY:

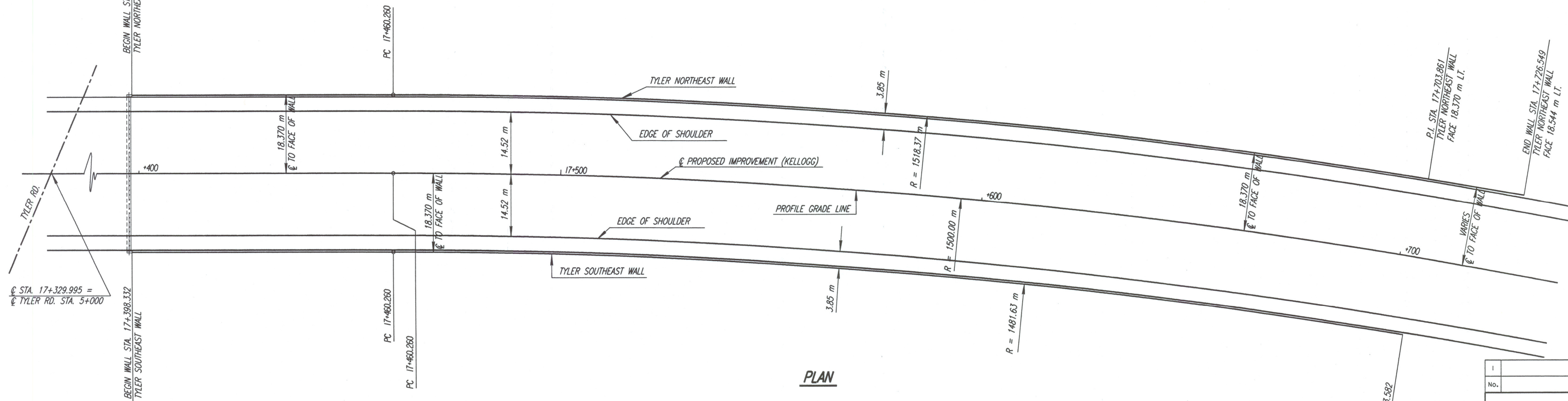
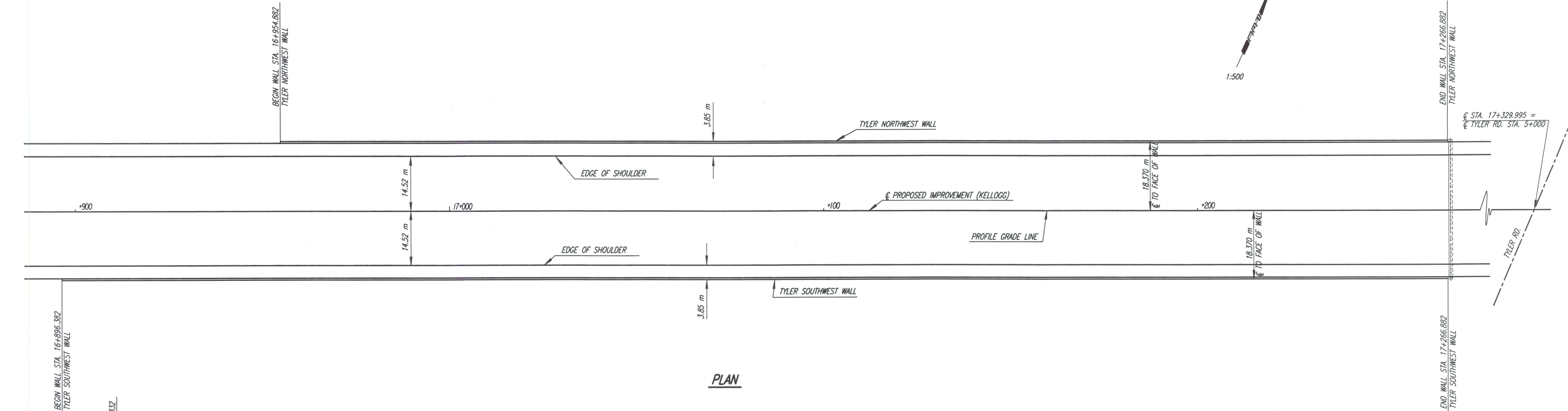

STATIONS SHOWN ARE PROPOSED @ KELLOGG
 UNLESS NOTED OTHERWISE.

No.	Revisions	By	Date

CITY OF WICHITA
MECHANICALLY STABILIZED EARTH WALLS
 PLAN TYLER WALLS
 SEDGWICK COUNTY

Professional Engineering Consultants, P.A.
 303 S. TOPEKA • WICHITA, KANSAS 67202
 316-262-2691 • FAX 316-262-3003

Designed by	RWM	Checked by	WDH
Drawn by	JSB	Date	Apr 11, 2002
		Job No.	97362