

SECTION
Sta. 0+308.794

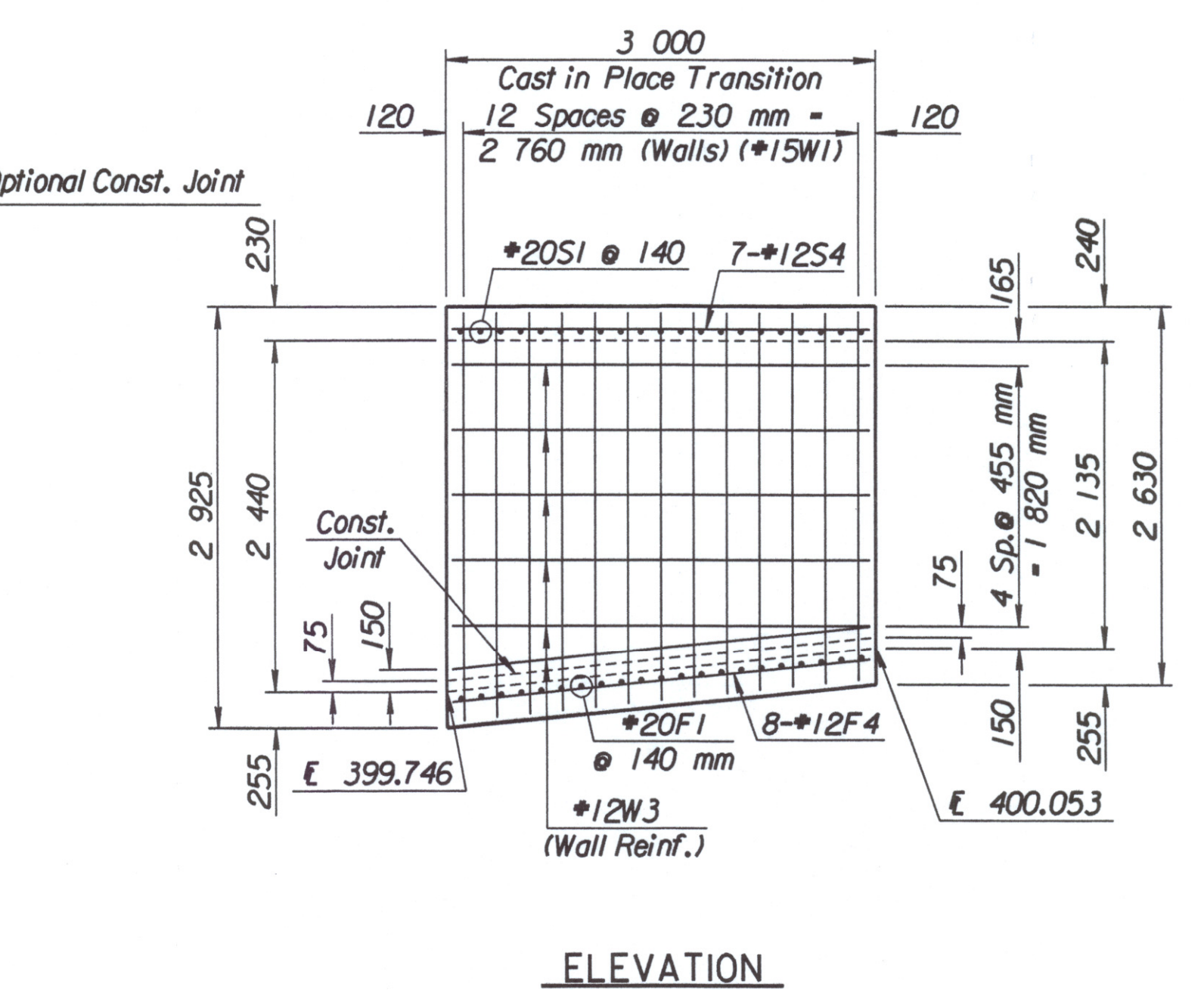

ELEVATION

3.4 x 2.4 x 3.794 m
Special R.C.B. Section
(See Sheet No. 413)

3,000
Transition Section

3.0 x 2.1 x 5.406 m
Special R.C.B. Section
(See Sheet No. 422)

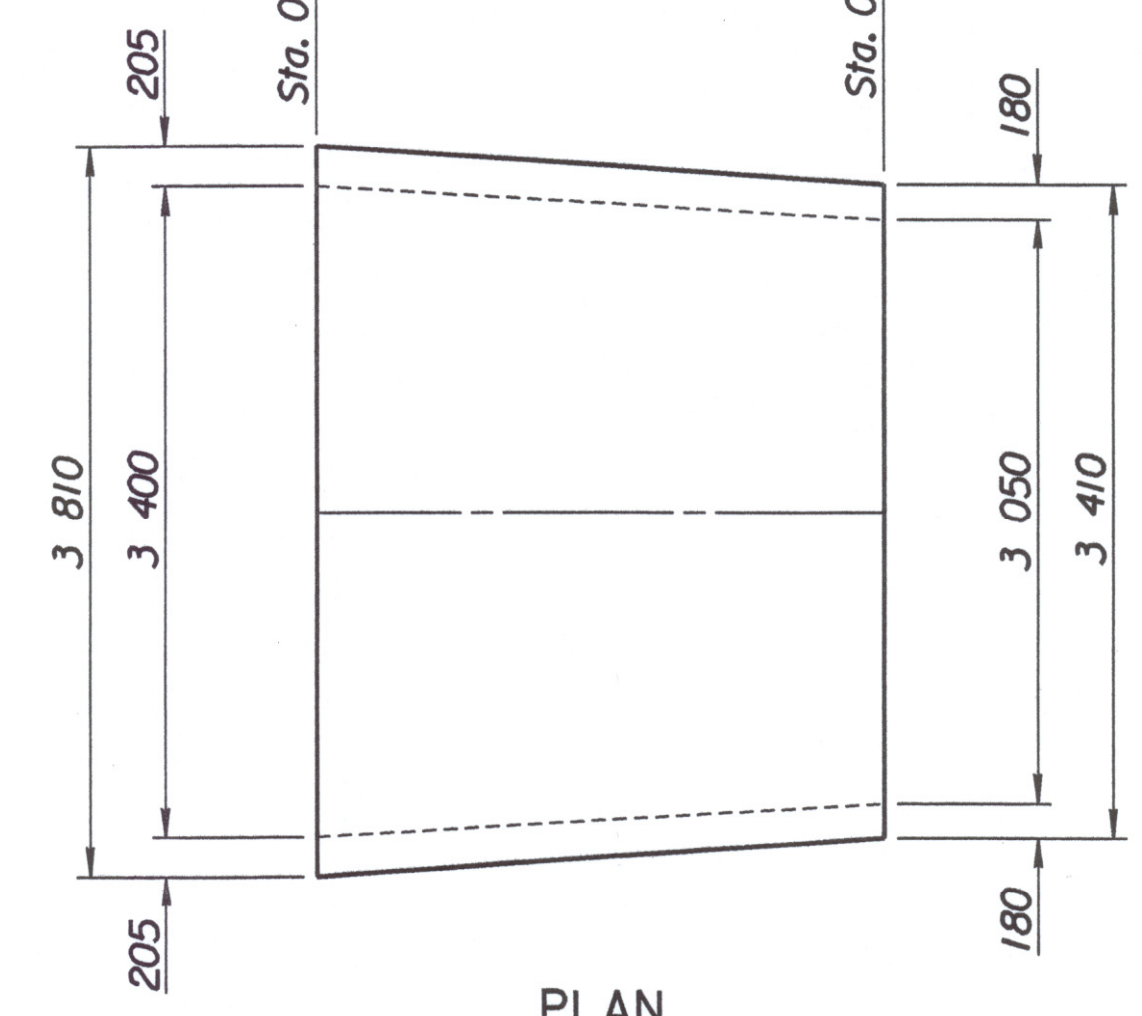

PLAN

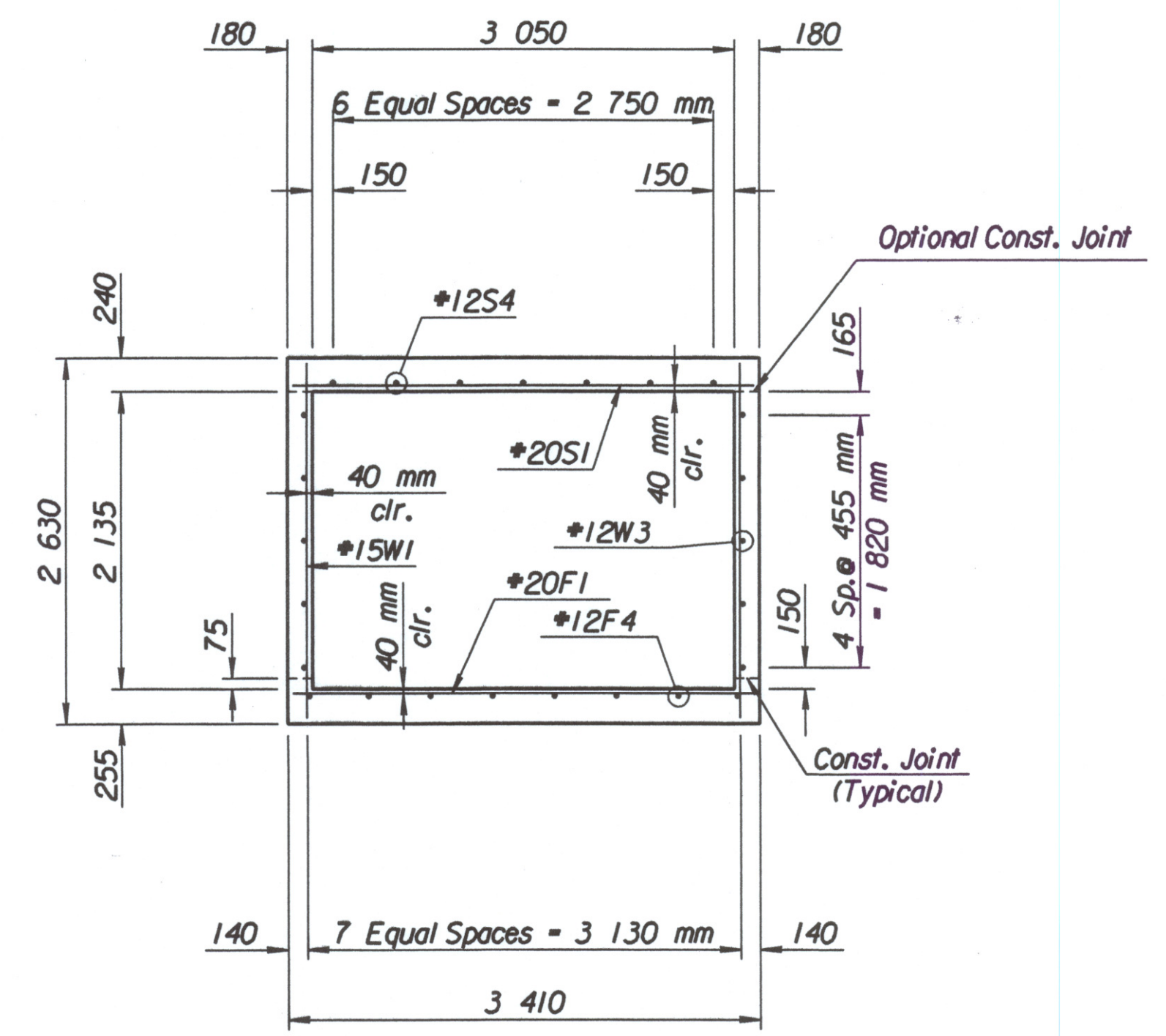

SECTION
Sta. 0+311.794

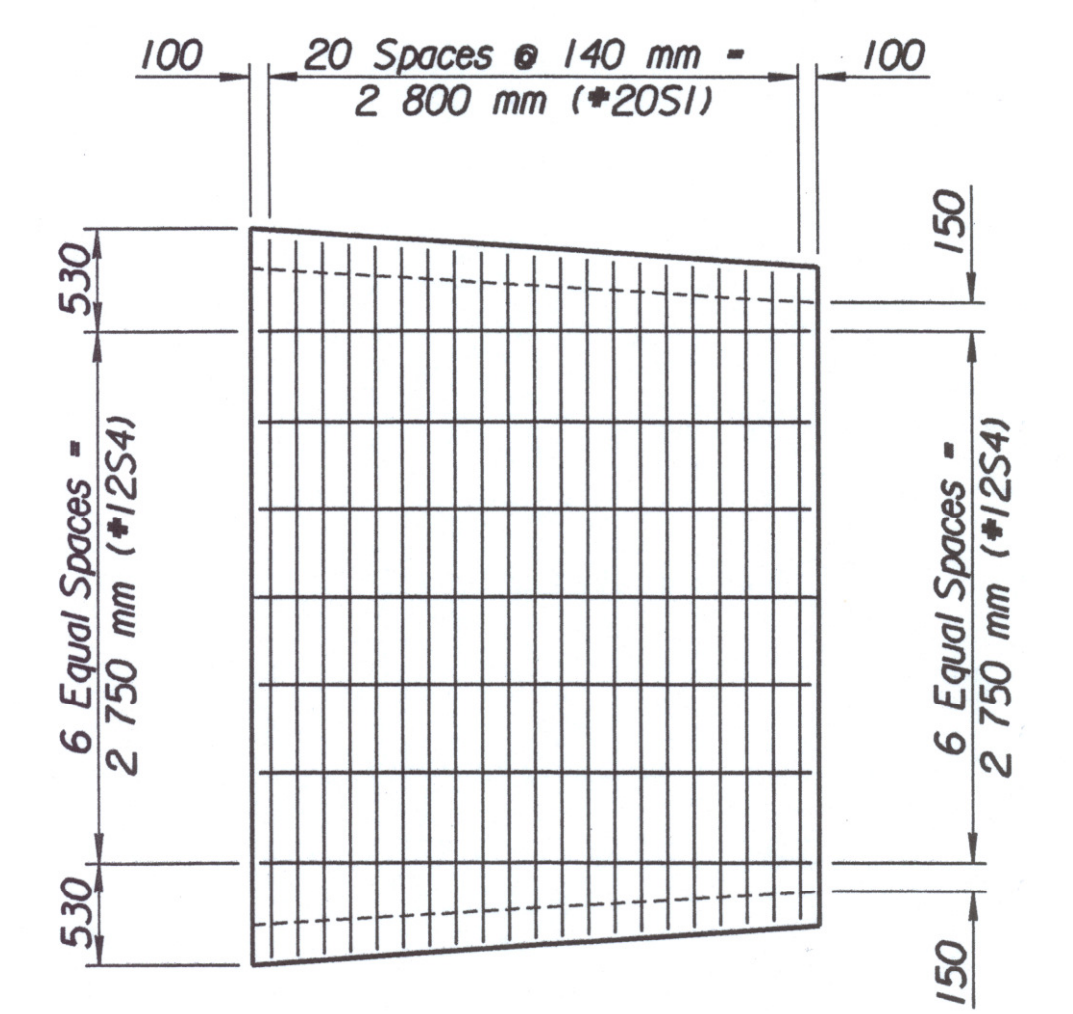

SLAB REINFORCING

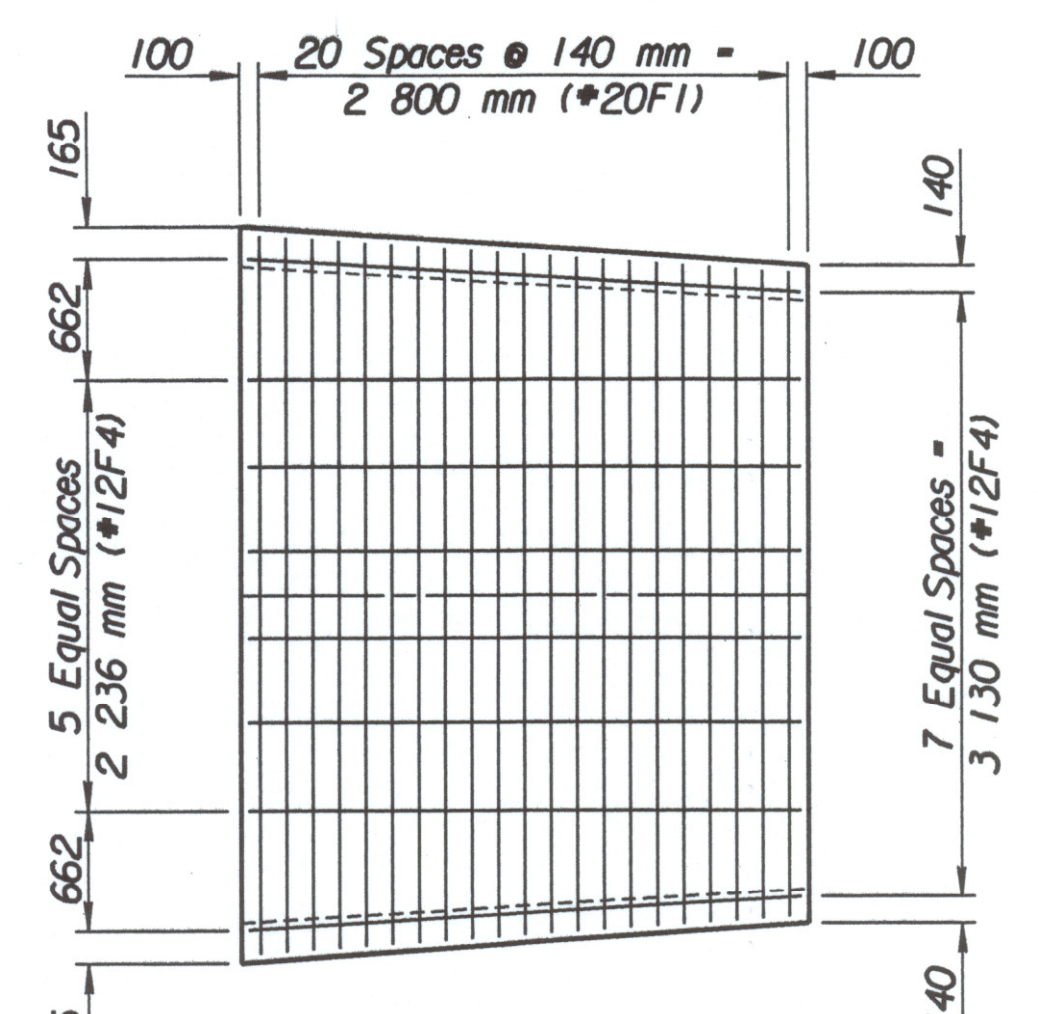

FLOOR REINFORCING

SI	Varies from 3 310 to 3 730 by 21 mm incr. Cut 1 Each Length
FI	Varies from 3 310 to 3 730 by 21 mm incr. Cut 1 Each Length
WI	Varies from 2 520 to 2 820 by 25 mm incr. Cut 2 Each Length

REINFORCING STEEL							
Straight Bars			Bent Bars				
Mark	No.	Size	Length	Mark	No.	Size	Length
SI	21	*20	Varies				
S4	7	*12	2 900				
FI	21	*20	Varies				
F4	8	*12	2 900				
WI	26	*15	Varies				
W3	12	*12	2 900				

SUMMARY OF QUANTITIES		
Item	Quantity	Unit
Class AAA Concrete	8.0	m ³
Reinforcing Steel (Grade 420)	521	kg

Notes:
See Plan and Profile Sheets for location of this R.C.B. Transition Section.

See Sheet No. 413 for General Notes.

No.	Revisions	By	Date
CITY OF WICHITA			
3.4 x 2.4 m TO 3.0 x 2.1 m			
R.C.B. TRANSITION DETAILS			
KELLOGG (US-54)			
SEDGWICK COUNTY			
Professional Engineering Consultants, P.A. <small>303 S. TOPEKA • WICHITA, KANSAS 67202 316-262-2601 • FAX 316-262-3003</small>			
Designed by	RWA	Checked by	RAS
Drawn by	GDR	Date	April, 2002
		Job No.	97362