

FHWA REGION NO.	STATE	PROJECT NO.	YEAR	SHEET NO.	TOTAL SHEETS
7	KANSAS	54-87 K-6657-01	2002	651	1122

GROUNDING NOTE:
LIGHT STANDARDS SHALL BE GROUNDED BY MEANS OF A NO.6 AWG STRANDED BARE COPPER GROUND WIRE BOLTED TO THE INSIDE OF THE LIGHT STANDARD SHAFT WITH A 13 mm GROUNDING NUT. GROUND WIRE SHALL BE CONNECTED TO THE COPPERCLAD GROUND ROD BY MEANS OF A GROUND ROD CLAMP.

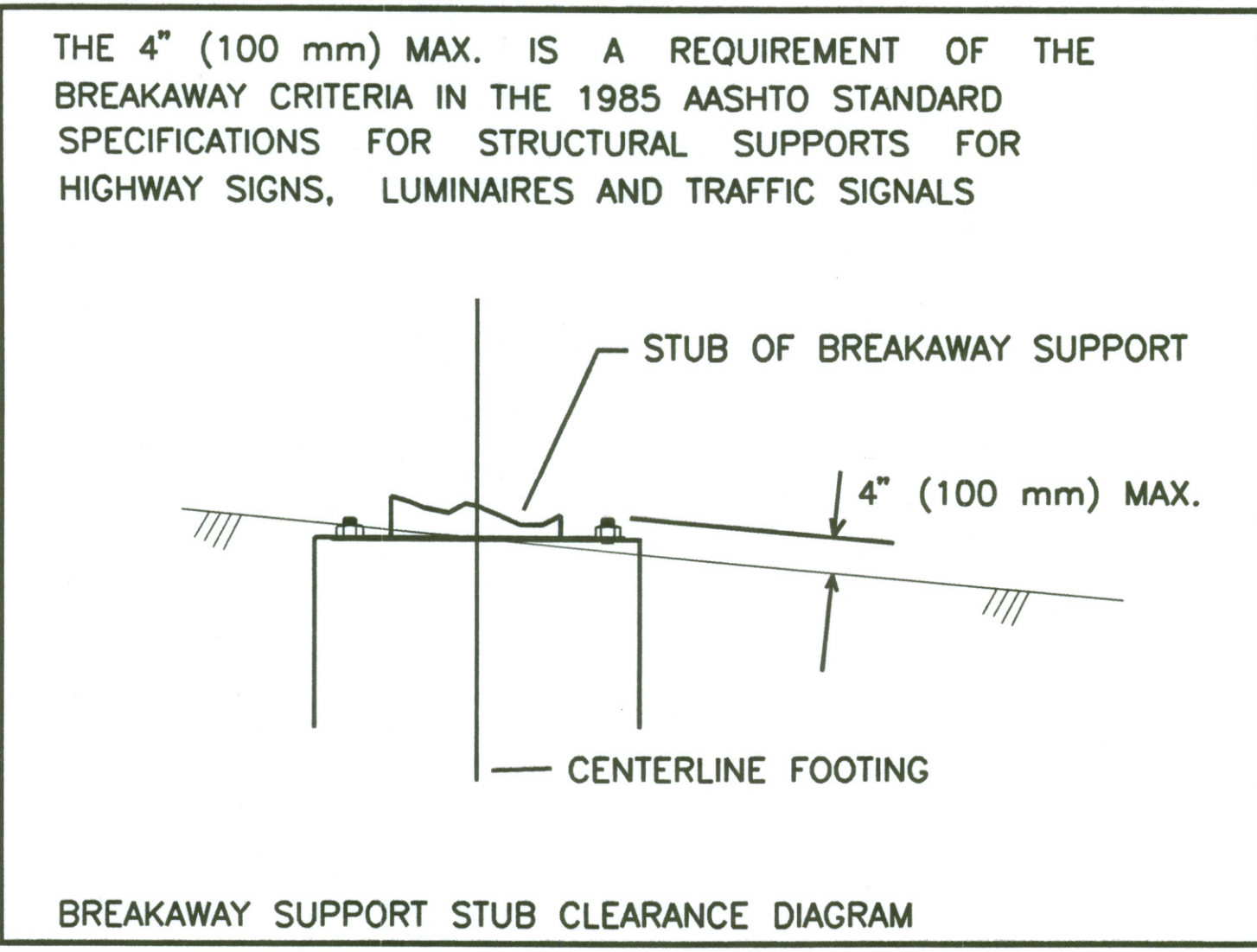

NOTE:
THE FOUNDATION SHALL BE INSTALLED TO MEET THE BREAKAWAY SUPPORT STUB CLEARANCE OF 100 mm MAXIMUM, TO INCLUDE ANCHOR BOLTS.

NOTES:
STANDARDS SHALL BE CAREFULLY SET, THEY SHALL BE RAKED TO PROVIDE A VERTICAL ALIGNMENT UPON COMPLETION OF THE LIGHTING SYSTEM, AND ALL LUMINAIRES SHALL BE SUPPORTED WITH LIGHT CENTERS APPROXIMATELY 12 meter MOUNTING HEIGHT AS INDICATED. THE CAREFUL ALIGNMENT AND GRADING OF STANDARDS IS AN ESSENTIAL FEATURE OF THE INSTALLATION. THE WORK SHALL BE AS NEARLY PERFECT AS PRACTICAL AND NO PERCEPTIBLE TOLERANCE WILL BE PERMITTED. IN ORDER TO ACCOMPLISH THE DESIRED PERFECTION OF ALIGNMENT OF THE LUMINAIRES, THE STANDARDS SHALL BE CAREFULLY ALIGNED.

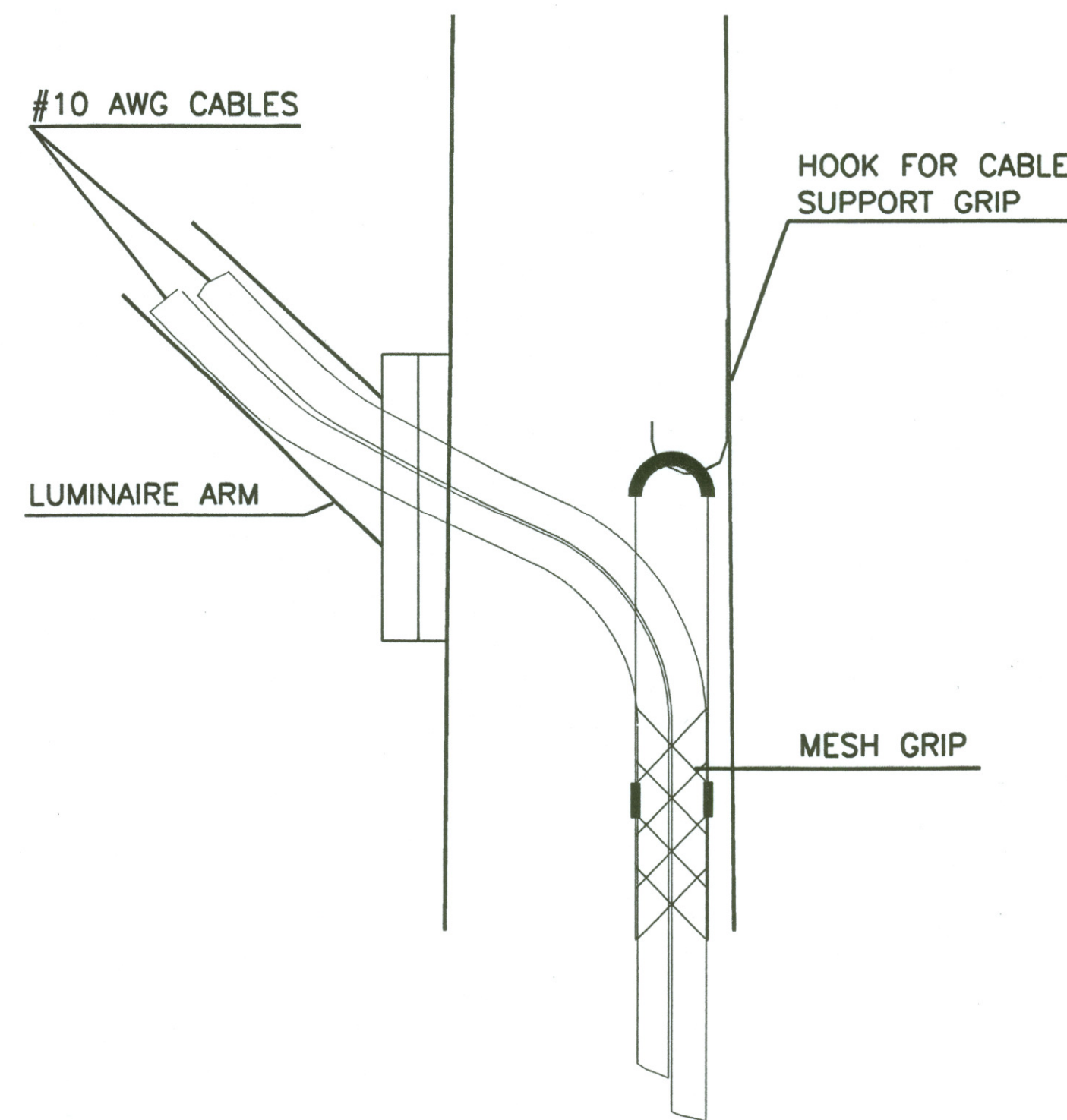
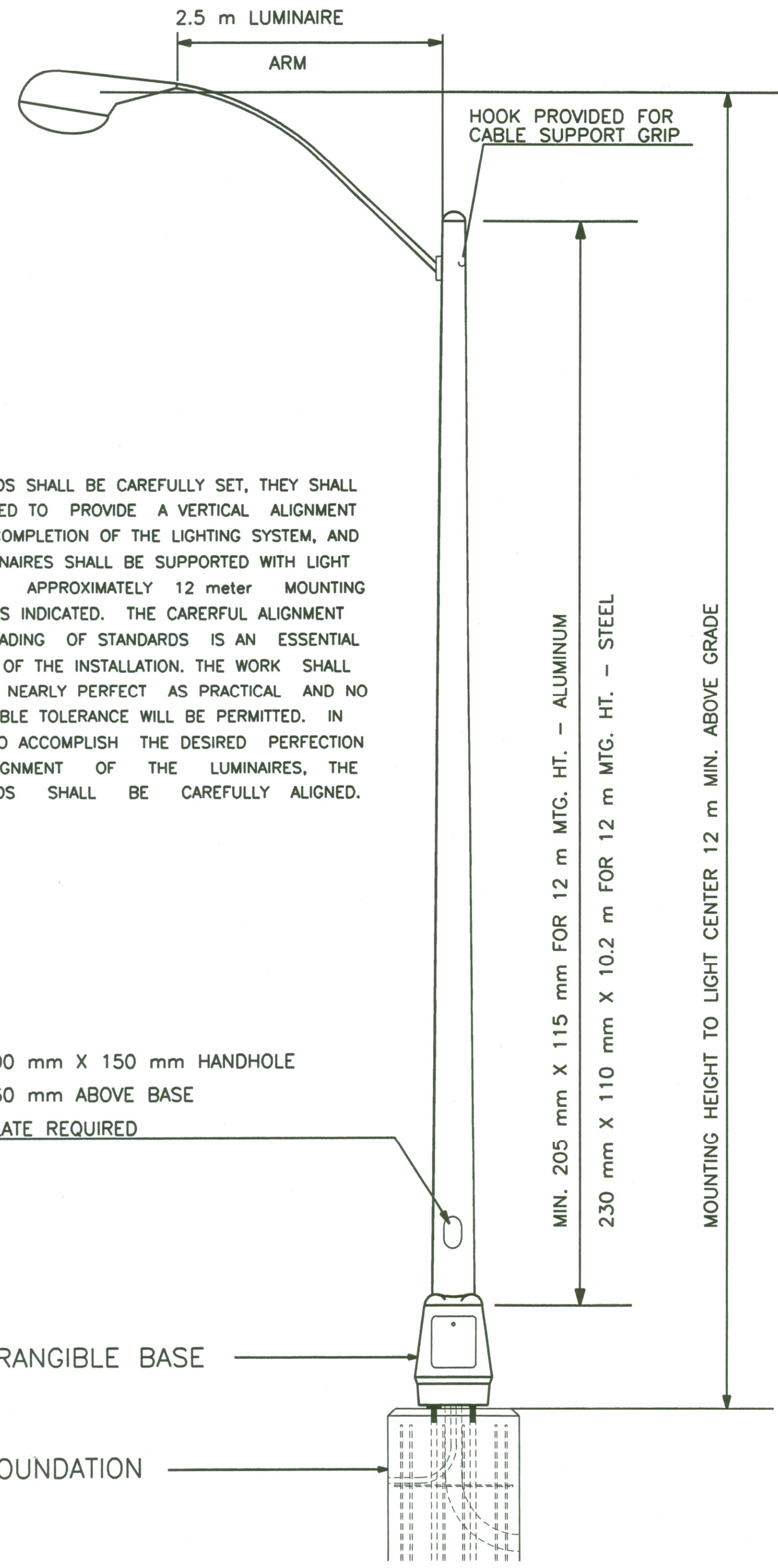

CABLE SUPPORT GRIP

NOTE:
THE CABLE SUPPORT GRIP SHALL BE INSTALLED ON THE HOOK SUPPLIED WITHIN THE LIGHT POLE AS SHOWN ABOVE.

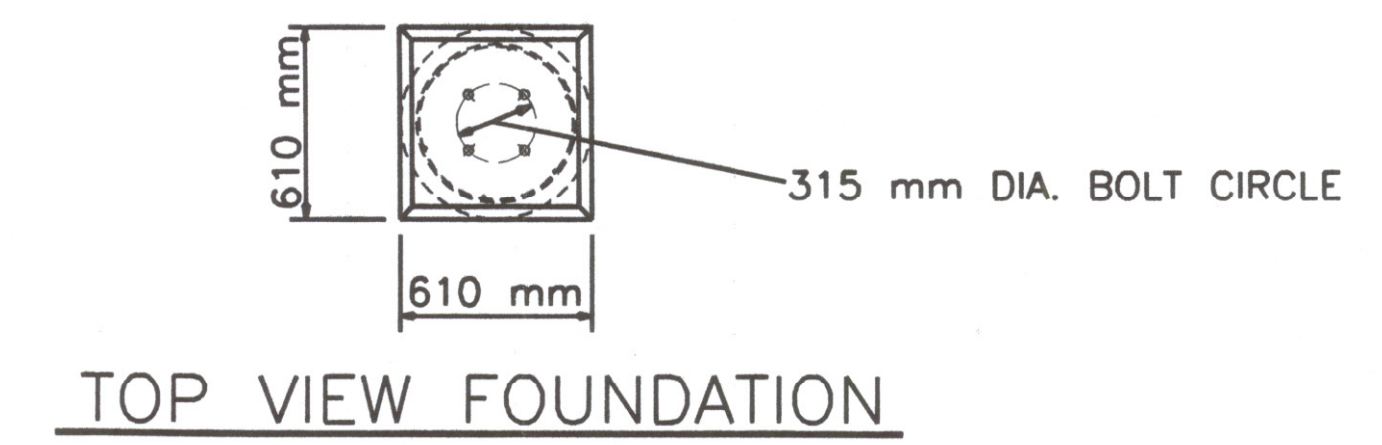

RUBBER SEALANT IS REQUIRED FOR TOP OF FRANGIBLE BASE

FRANGIBLE BASE
A MIN. OF 150 mm TO BE FORMED 610 mm X 610 mm AT TOP OF BASE

NOTE: CENTERLINE OF CONCRETE BASE SHALL BE INSTALLED AT GROUNDLINE.

4-25 mm X 1 m ANCHOR BOLTS

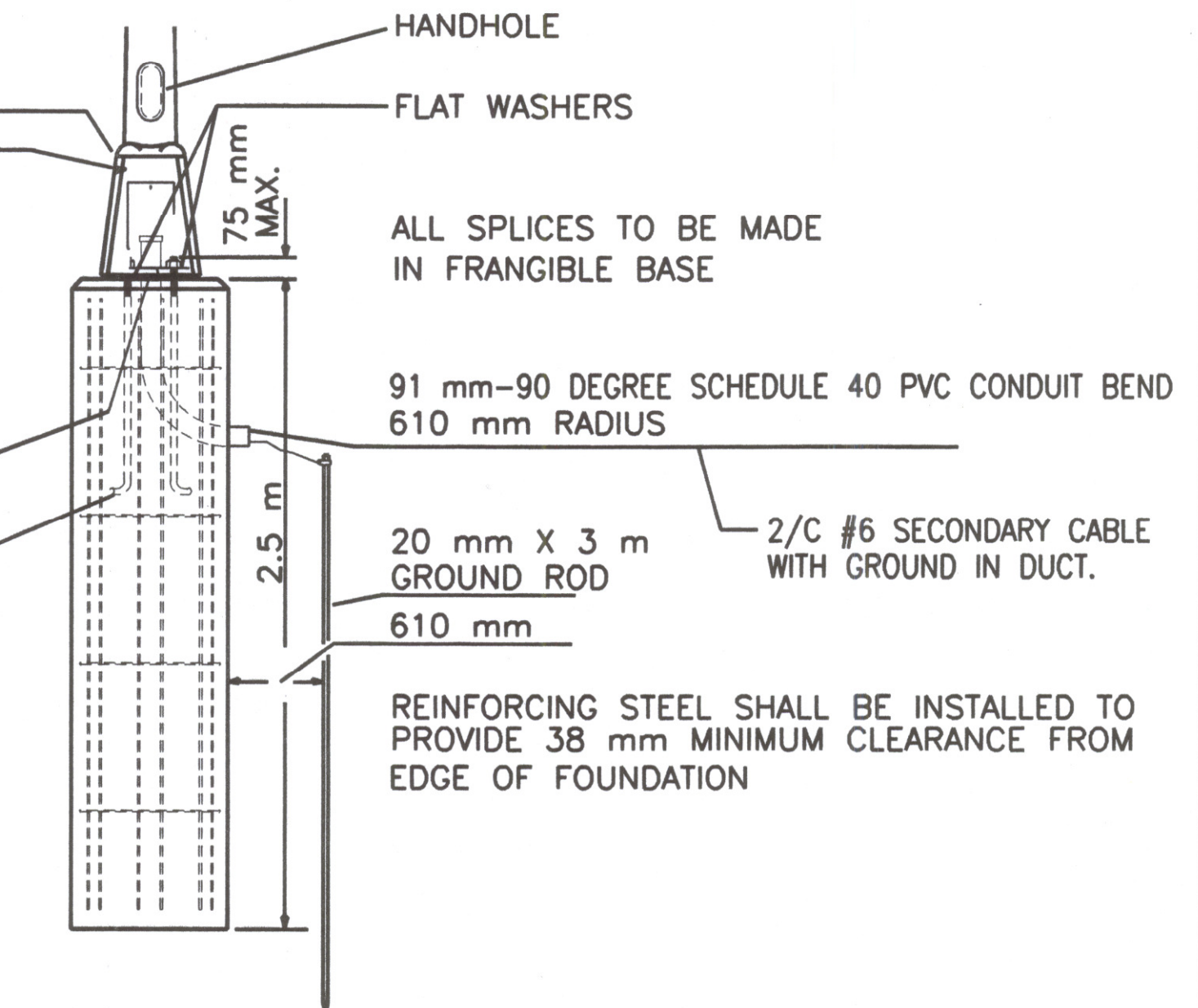

FOUNDATION DETAIL SEE SHEET # 651A

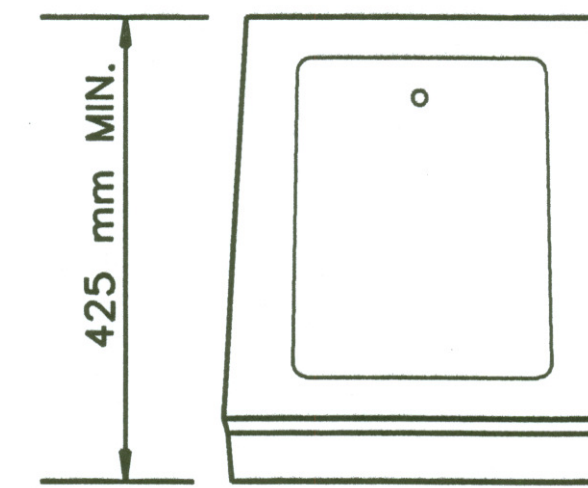
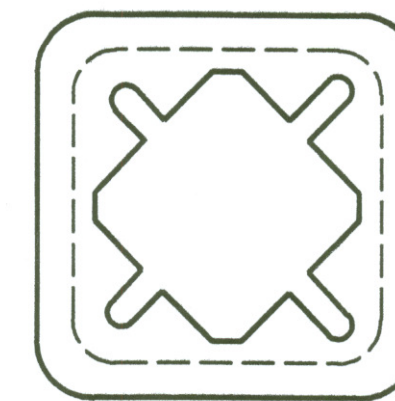

FRANGIBLE BASE

NOTE:
THE FRANGIBLE BASE MUST ACCOMMODATE 320 mm TOP AND BOTTOM BOLT CIRCLE.

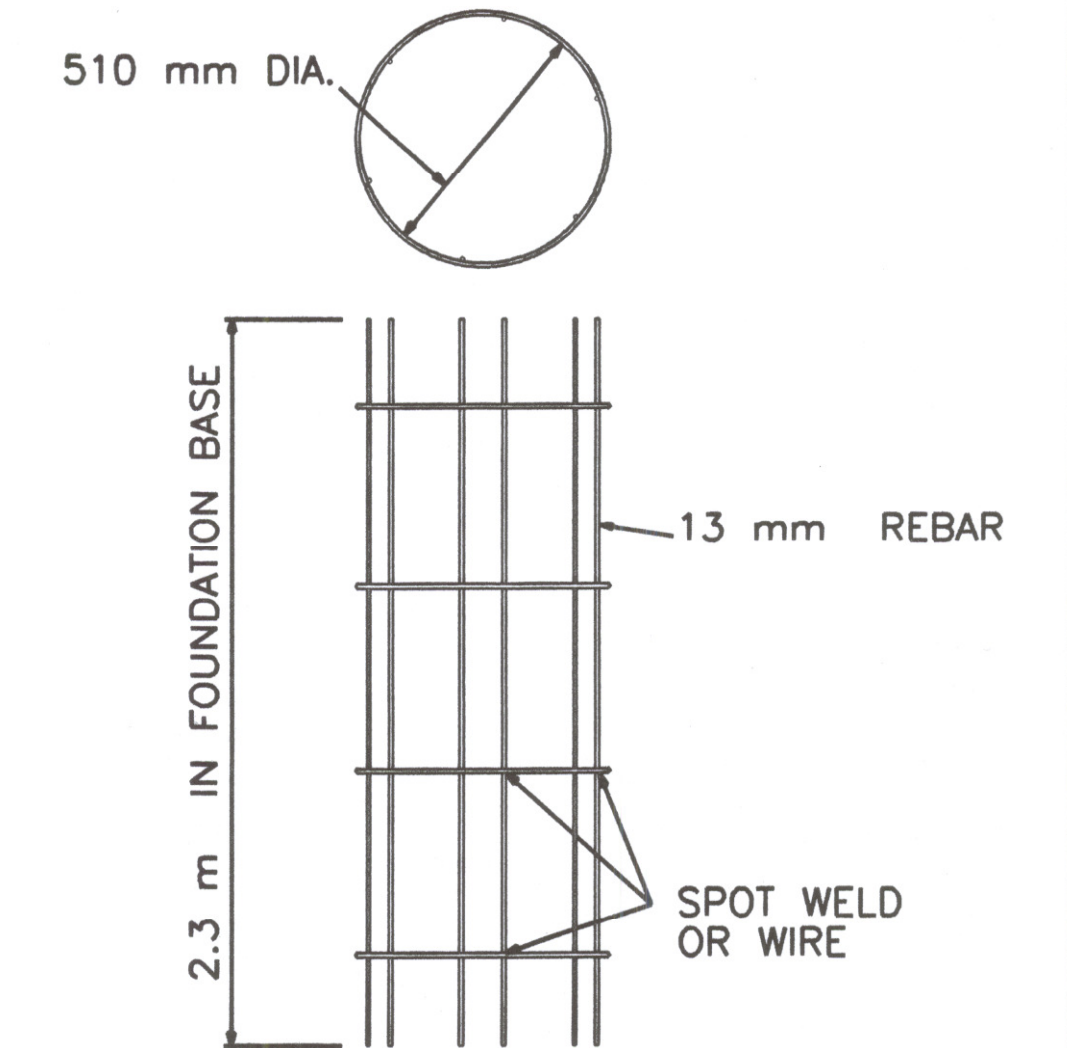
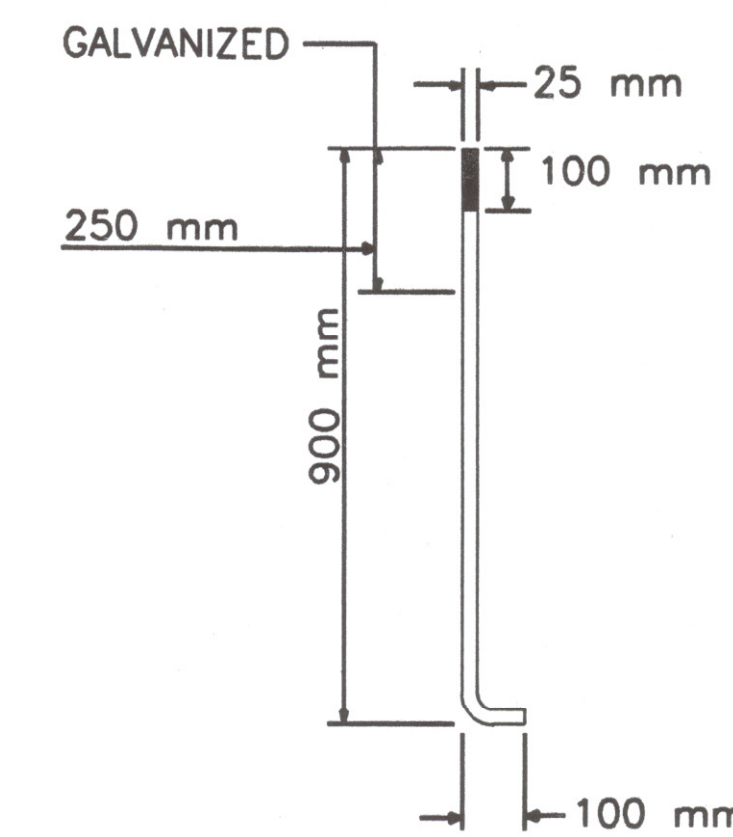

DSNR: WAN OPER: WAN SCALE: 500 E:1997/97362/WKAG5LDGN 4-10-2002 7:39:13 LAST REV: BY:

3					
2					
1					
NO.	DATE	REVISION	BY	APP'D	
KANSAS DEPARTMENT OF TRANSPORTATION					
ROADWAY LIGHTING DETAILS					
DESIGNED: KG					
DETAIL CK.: DETAIL CK. KG					
QUANTITIES: QUAN. CK.					
TRACE CK.: TRACE CK.					