

FHWA REGION NO.	STATE	PROJECT NO.	YEAR	SHEET NO.	TOTAL SHEETS
7	KANSAS	54-87 K-6657-01	2002	705	1122

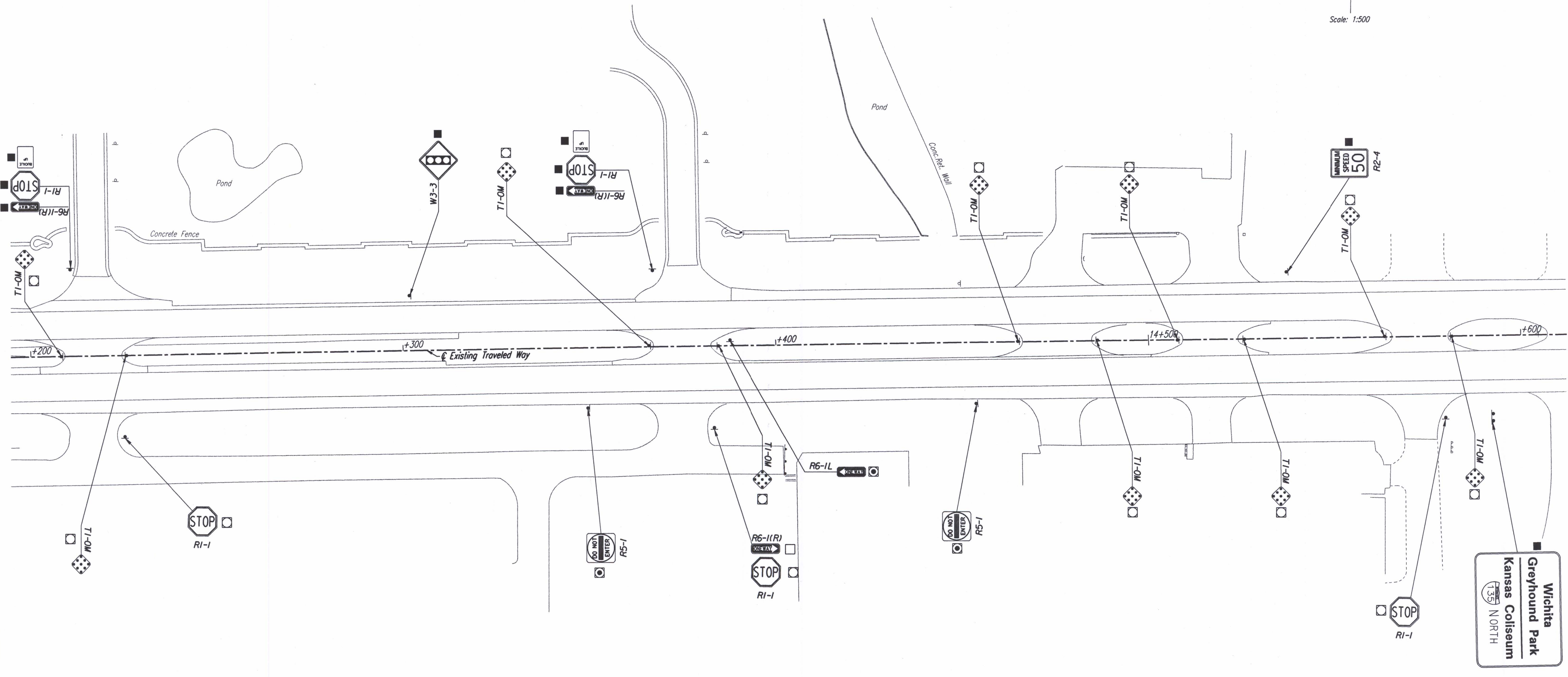

DATE	
BY	
REFERENCES NOTED	
REFERENCES CHECKED	

DSNR: WDH OPER: JGP SCALE: 1:500
 I:/1997/97362/Signing/Existing/PL142.DGN 11-23-1999 7:20:41 LAST REV: 1-25-2002 BY: svb



No.	Revisions	By	Date
CITY OF WICHITA SIGNING REMOVAL KELLOGG STA. 14+200 TO STA. 14+600 SEDGWICK COUNTY			
Professional Engineering Consultants, P.A. <small>303 S. TOPEKA • WICHITA, KANSAS 67202 316-262-2691 • FAX 316-262-3003</small>			
Designed by	RPG	Checked by	WDH
Drawn by	JGP	Date	April, 2002
		Job No.	97362