

FHWA REGION NO.	STATE	PROJECT NO.	YEAR	SHEET NO.	TOTAL SHEETS
7	KANSAS	54-87 K-6657-01	2002	706	1122

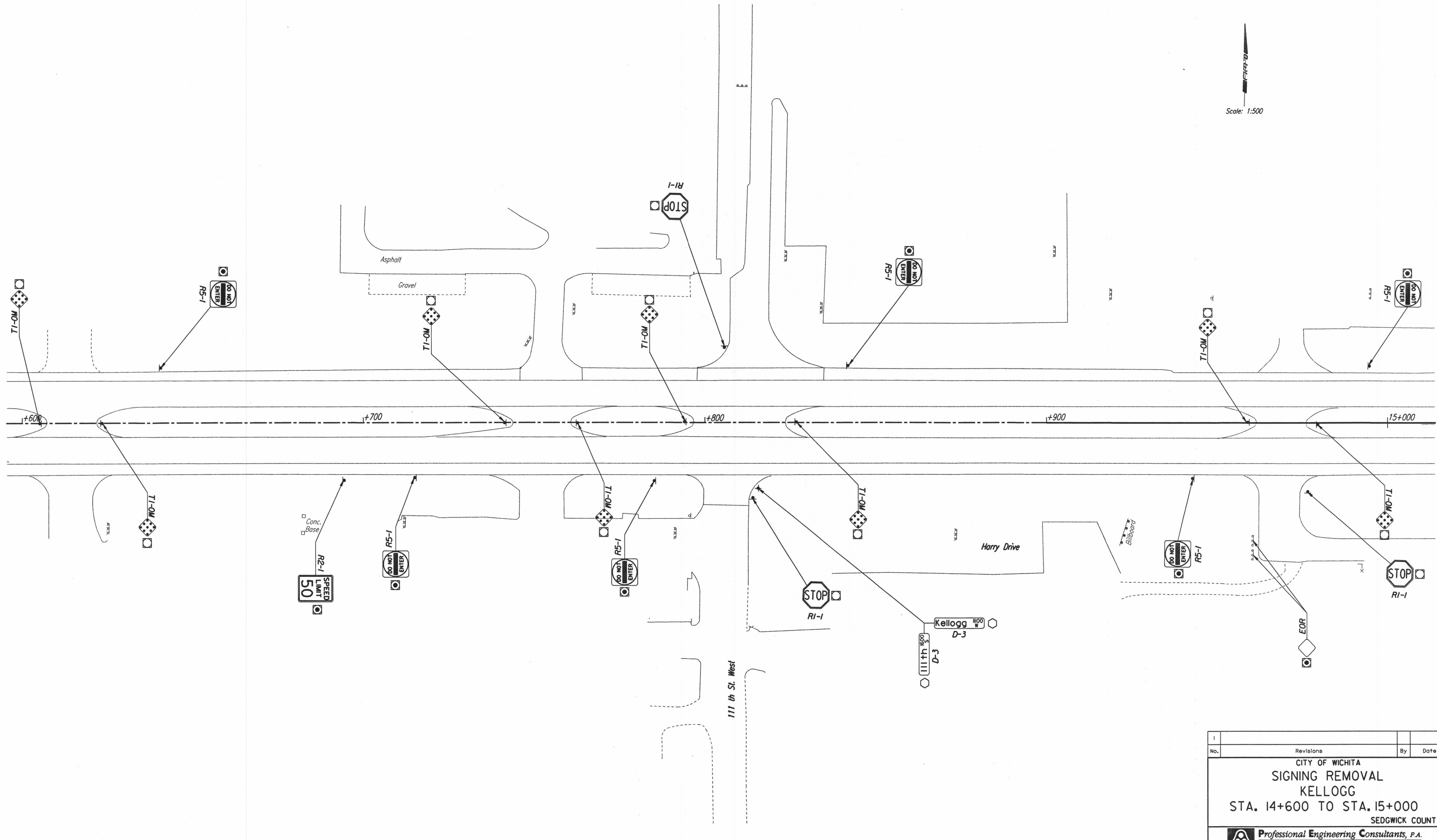

DATE	BY

DSNR: WDH OPER: JGP SCALE: 1:500
 I:/1997/97362/Signing/Existing/PL146.DGN 12-1-1999 7:19:49 LAST REV: 1-25-2002 BY: svb



No.	Revisions	By	Date

CITY OF WICHITA
SIGNING REMOVAL
KELLOGG
STA. 14+600 TO STA. 15+000
SEDGWICK COUNTY

Professional Engineering Consultants, P.A.
303 S. TOPEKA • WICHITA, KANSAS 67202
 316-262-2691 • FAX 316-262-3003

Designed by	RPG	Checked by	WDH
Drawn by	JGP	Date	Apr 11, 2002
		Job No.	97362