

FHWA REGION NO.	STATE	PROJECT NO.	YEAR	SHEET NO.	TOTAL SHEETS
7	KANSAS	54-87 K-6657-01	2002	809	1122

See Sh. Nos. 837 & 842 for Temporary Traffic Signal.
See Sh. Nos. 819-822 for Traffic Control on Tyler Rd.

BY	DATE
REFERENCES NOTED	REFERENCES CHECKED

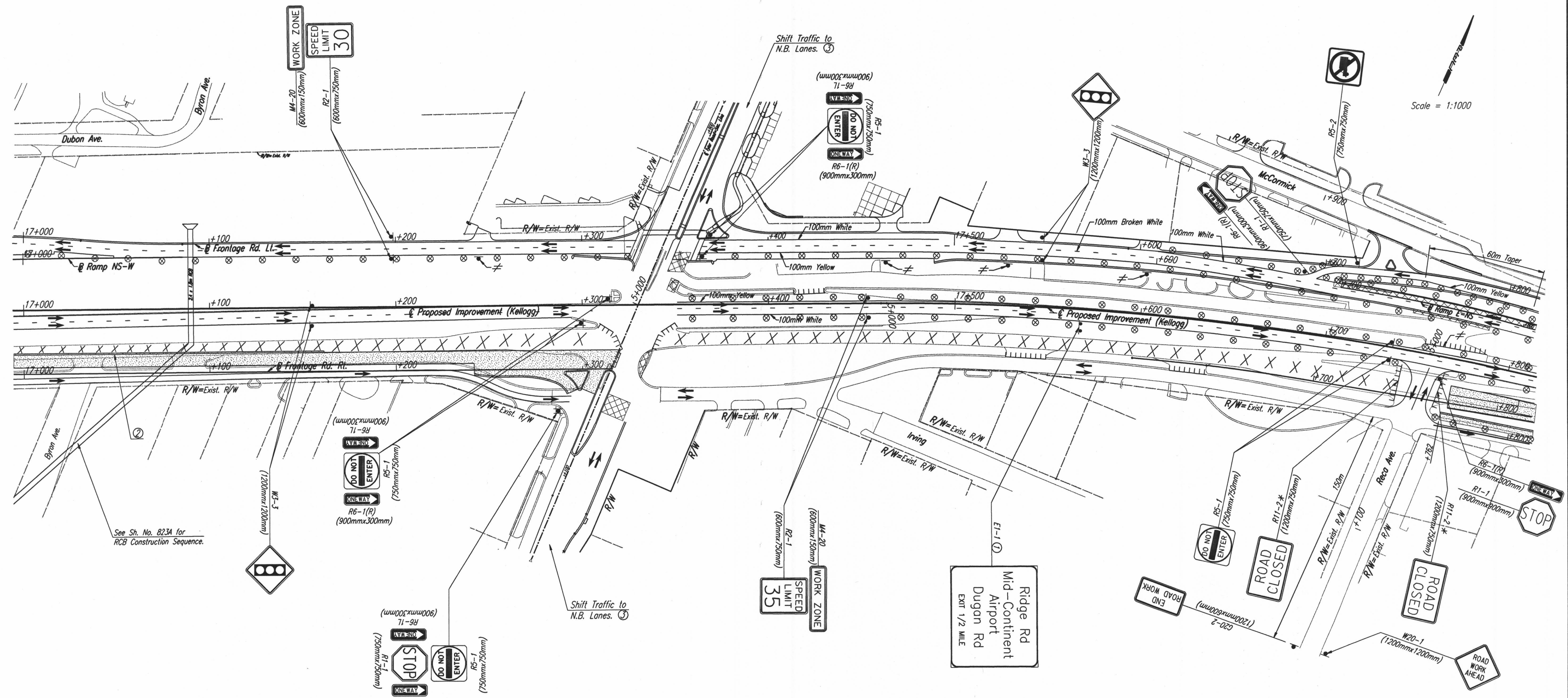

Scale = 1:1000

DSNR: i:/1997/97362/SEQUENCE/STAGE 2A/PL170.DGN 1-18-2002 14:56:19 LAST REV: 4-15-2002 BY: svb
 OPER: JGP SCALE: 1:1000

See Sh. No. 823A for RCB Construction Sequence.

- ① May use existing sign relocated from Sta. 17+460.
- ② Contractor to verify that there is enough room to construct mainline retaining wall prior to constructing inside lane of Fr. Rd. Rt.
- ③ Contractor to submit traffic control plan for approval.

No.	Revisions	By	Date
CITY OF WICHITA TRAFFIC CONTROL STAGE 2A STA. 17+000 TO STA. 17+800 SEDGWICK COUNTY			
Professional Engineering Consultants, P.A. <small>303 S. TOPEKA • WICHITA, KANSAS 67202 316-262-2691 • FAX 316-262-3003</small>			
Designed by	RPC, RWM	Checked by	WDH
Drawn by	JGP	Date	Apr 11, 2002 Job No. 97362