

REFER TO STD. TETIOSI FOR ADDITIONAL INFORMATION ON TRAFFIC CONTROL SIGNS AND SIGN SPACING.
 REFER TO STD. TET02SIFOR INFORMATION ON TAPERS AND CHANNELIZING DEVICES.
 REFER TO STD. TETOOSI FOR LENGTH OF BUFFER SPACE.

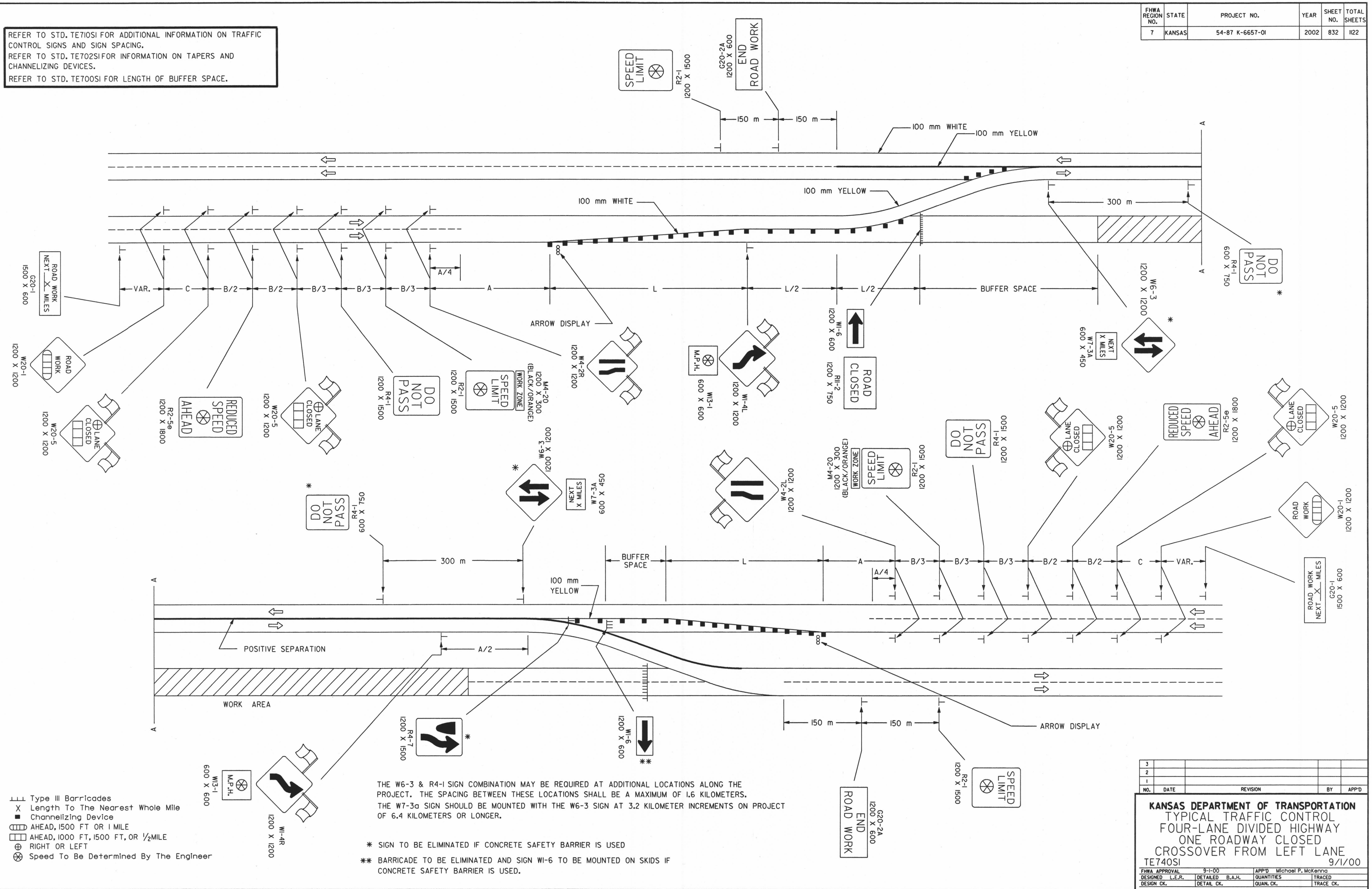

DSNR: DPER: JGP SCALE: 1:1997/97362/SEQUENCE/STANDARDS/TE740SI.DGN 1-30-2002 10:39:19 LAST REV: 3-29-2002 BY: svb

- ||| Type III Barricades
- X Length To The Nearest Whole Mile
- Channelizing Device
- ⊞ AHEAD, 1500 FT OR 1 MILE
- ⊞ AHEAD, 1000 FT, 1500 FT, OR 1/2 MILE
- ⊞ RIGHT OR LEFT
- ⊗ Speed To Be Determined By The Engineer

THE W6-3 & R4-1 SIGN COMBINATION MAY BE REQUIRED AT ADDITIONAL LOCATIONS ALONG THE PROJECT. THE SPACING BETWEEN THESE LOCATIONS SHALL BE A MAXIMUM OF 1.6 KILOMETERS. THE W7-3a SIGN SHOULD BE MOUNTED WITH THE W6-3 SIGN AT 3.2 KILOMETER INCREMENTS ON PROJECT OF 6.4 KILOMETERS OR LONGER.

- * SIGN TO BE ELIMINATED IF CONCRETE SAFETY BARRIER IS USED
- ** BARRICADE TO BE ELIMINATED AND SIGN WI-6 TO BE MOUNTED ON SKIDS IF CONCRETE SAFETY BARRIER IS USED.

NO.	DATE	REVISION	BY	APP'D
3				
2				
1				

KANSAS DEPARTMENT OF TRANSPORTATION
 TYPICAL TRAFFIC CONTROL
 FOUR-LANE DIVIDED HIGHWAY
 ONE ROADWAY CLOSED
 CROSSOVER FROM LEFT LANE
 TE740SI 9/1/00

FHWA APPROVAL	9-1-00	APP'D	Michael P. McKenna
DESIGNED	L.E.P.	DETAILED	B.A.H.
DESIGN CK.	DETAIL CK.	QUANTITIES	TRACED
		QUAN. CK.	TRACE CK.