

SIGNAL HEAD ARRANGEMENT

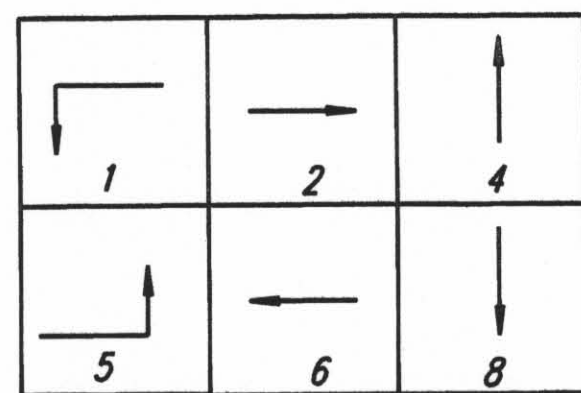

PHASE DIAGRAM
STAGE 1A & 1B

DATE	
BY	
REFERENCES NOTED	
REFERENCES CHECKED	

DSNR: RPG OPER: JGP SCALE: 1:500
 i:/1997/97362/SIGNALS/TEMPYLER.DGN 3-11-2002 10:30:58 LAST REV: 4-15-2002 BY: drp

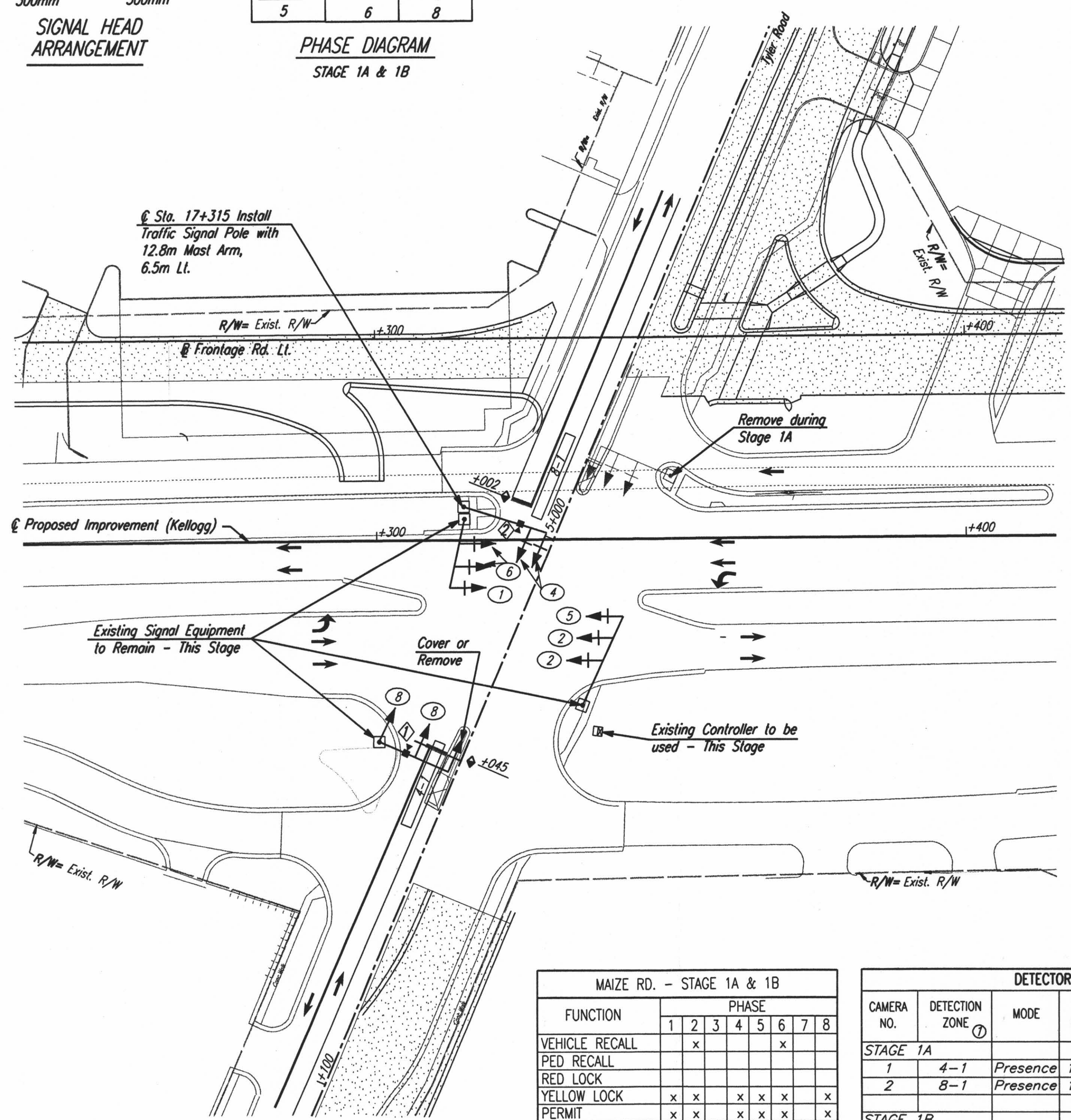

STAGE 1A

FUNCTION	PHASE							
	1	2	3	4	5	6	7	8
VEHICLE RECALL		x						x
PED RECALL								
RED LOCK								
YELLOW LOCK	x	x		x	x	x	x	x
PERMIT	x	x		x	x	x	x	x
PED PHASES								
LEAD PHASES	x		x		x		x	
DOUBLE ENTRY		x						x
SEQUENTIAL TIMING								
START-UP YELLOW					x			
OVERLAP A								
OVERLAP B								
OVERLAP C								
OVERLAP D								
EXCLUSIVE					x			x
SIMULTANEOUS GAP	x						x	

Note: #4 and #8 shall Not Run Concurrently

DETECTOR SUMMARY - STAGE 1A and 1B							
CAMERA NO.	DETECTION ZONE	MODE	SIZE (LxW)	PHASE CALLED	PHASE EXTENDED	DELAY/STRETCH TIMER	INITIAL SETTING (SEC.)
STAGE 1A							
1	4-1	Presence	15x1.8	4	4		
2	8-1	Presence	15x1.8	8	8		
STAGE 1B							
1	4-1	Presence	15x1.8	4	4		
2	8-1	Presence	15x1.8	8	8		

① Detection Zones shall be adjusted to avoid detecting Cross-Traffic
 Note: Existing Detector Loops on Kellogg shall Remain in use during Stages 1A & 1B.

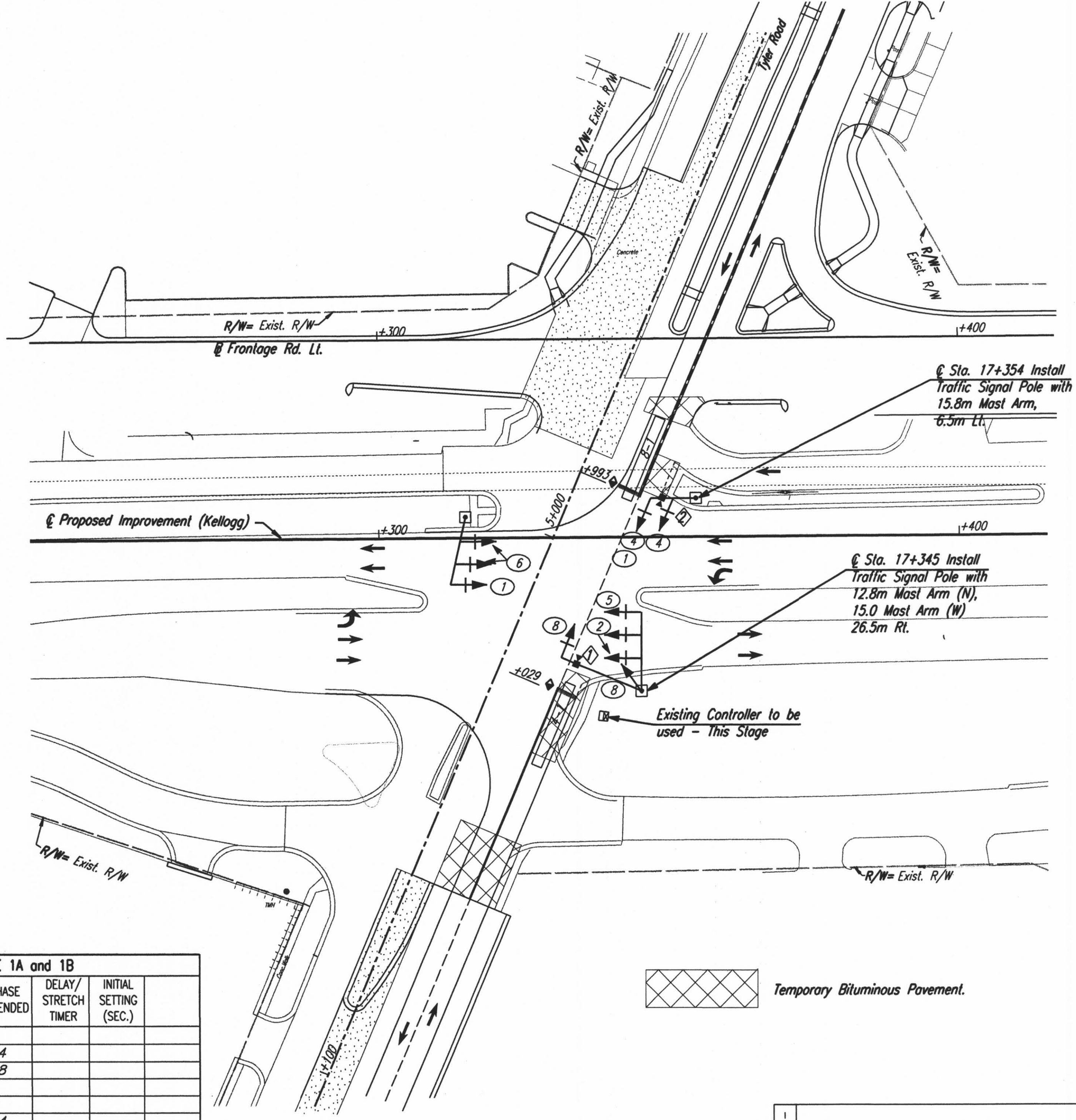

STAGE 1B

Temporary Bituminous Pavement.

UTILITIES
 See Plan Sheet for Utilities.

1			
No.	Revisions	By	Date
CITY OF WICHITA			
TEMPORARY TRAFFIC SIGNAL			
KELLOGG & TYLER RD. STAGE I			
SEDGWICK COUNTY			
 Professional Engineering Consultants, P.A. 303 S. TOPEKA • WICHITA, KANSAS 67202 316-262-2591 • FAX 316-262-3003			
Designed by	RPG	Checked by	BER
Drawn by	JSB	Date	Apr-11, 2002 Job No. 97362