

PHASE DIAGRAM
STAGE 2A & 2B

| | |
|--------------------|--|
| DATE | |
| BY | |
| REFERENCES NOTED | |
| REFERENCES CHECKED | |

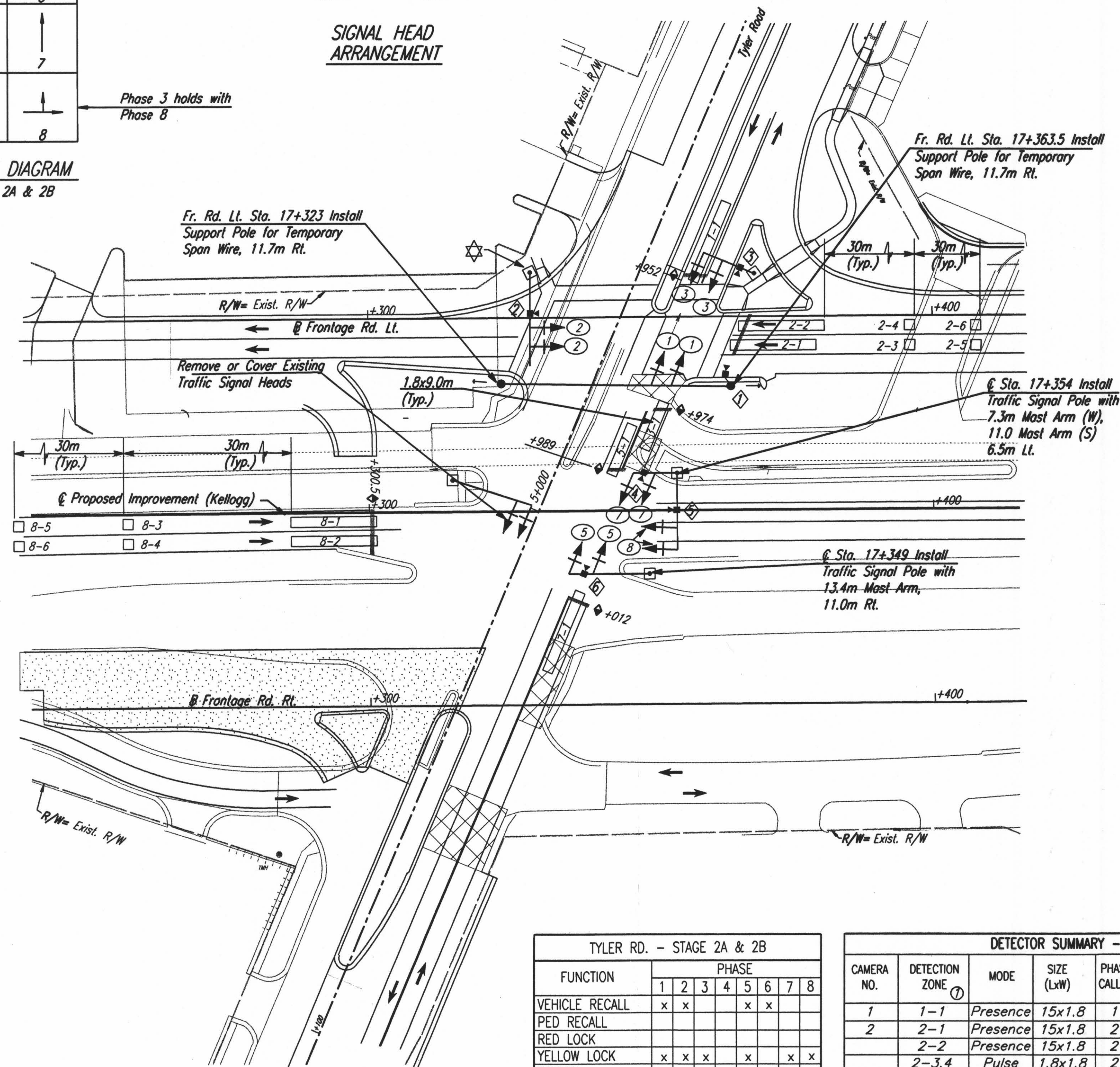

STAGE 2A

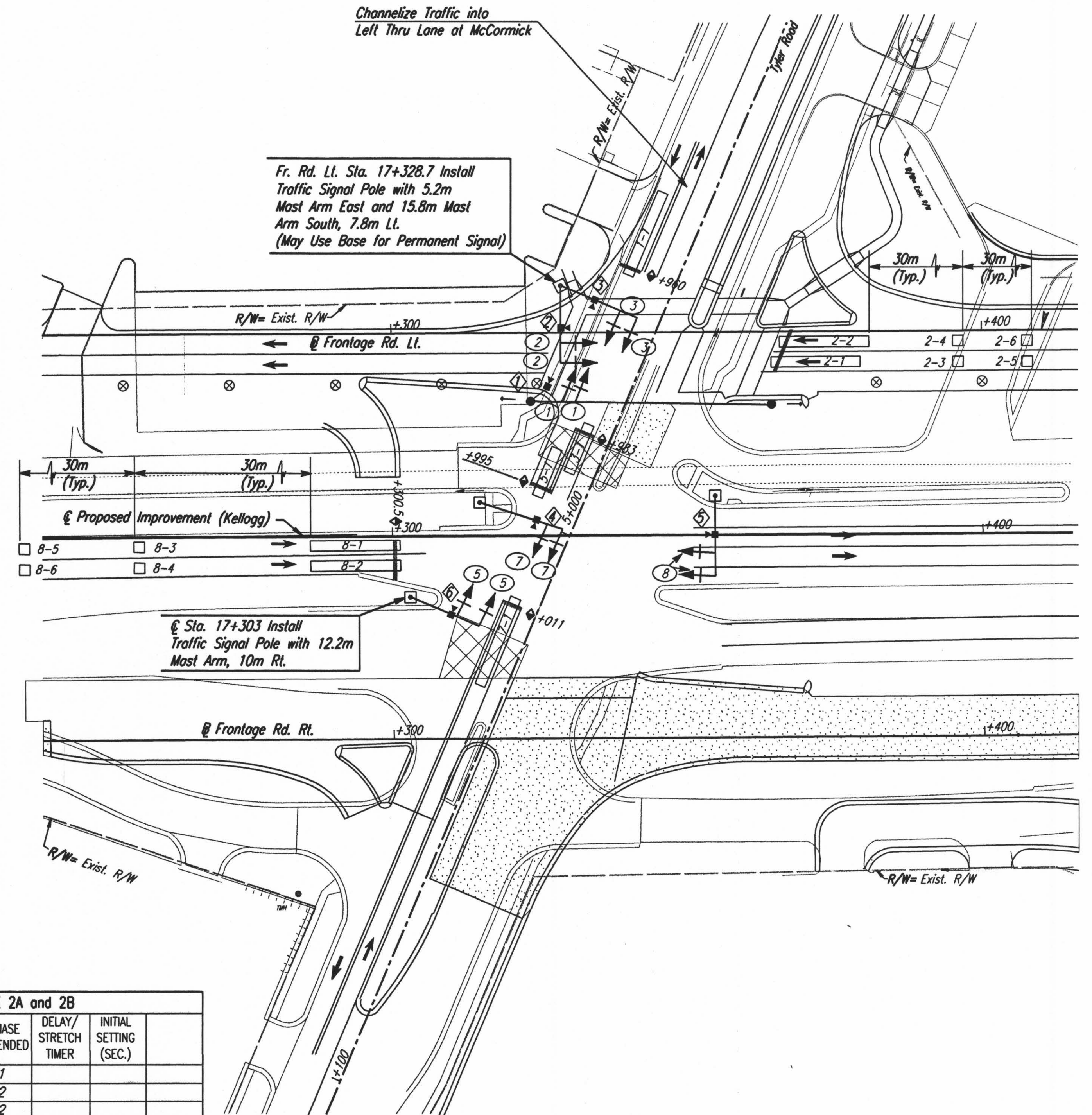

STAGE 2B

| FUNCTION | PHASE | | | | | | | |
|-------------------|-------|---|---|---|---|---|---|---|
| | 1 | 2 | 3 | 4 | 5 | 6 | 7 | 8 |
| VEHICLE RECALL | x | x | | | x | x | | |
| PED RECALL | | | | | | | | |
| RED LOCK | | | | | | | | |
| YELLOW LOCK | x | x | x | | x | | x | x |
| PERMIT | x | x | x | | x | | x | x |
| PED PHASES | | | | | | | | |
| LEAD PHASES | x | | | x | | | x | |
| DOUBLE ENTRY | | | | | | | | |
| SEQUENTIAL TIMING | | | | | | | | |
| START-UP YELLOW | x | | | | x | | | |
| OVERLAP A | | | | | | | | |
| OVERLAP B | | | | | | | | |
| OVERLAP C | | | | | | | | |
| OVERLAP D | | | | | | | | |
| EXCLUSIVE | | | | | | | | |
| SIMULTANEOUS GAP | | | | | | | | |

| CAMERA NO. | DETECTION ZONE | MODE | SIZE (LxW) | PHASE CALLED | PHASE EXTENDED | DELAY/STRETCH TIMER | INITIAL SETTING (SEC.) |
|------------|----------------|----------|------------|--------------|----------------|---------------------|------------------------|
| 1 | 1-1 | Presence | 15x1.8 | 1 | 1 | | |
| 2 | 2-1 | Presence | 15x1.8 | 2 | 2 | | |
| | 2-2 | Presence | 15x1.8 | 2 | 2 | | |
| | 2-3,4 | Pulse | 1.8x1.8 | 2 | 2 | Stretch | 1.0 |
| | 2-5,6 | Pulse | 1.8x1.8 | 2 | 2 | Stretch | 1.0 |
| 3 | 3-1 | Presence | 9x1.8 | 3 | 3 | | |
| 4 | 7-1 | Presence | 15x1.8 | 7 | 7 | | |
| 5 | 8-1,2 | Pulse | 1.8x1.8 | 8 | 8 | Stretch | 1.0 |
| | 8-3,4 | Pulse | 1.8x1.8 | 8 | 8 | Stretch | 1.0 |
| | 8-5 | Presence | 15x1.8 | 8 | 8 | | |
| | 8-6 | Presence | 15x1.8 | 8 | 8 | | |
| 6 | 5-1 | Presence | 9x1.8 | 5 | 5 | | |

① Detection Zones shall be adjusted to avoid detecting Cross-Traffic
Note: Tyler Road Detection Zones to Shift Location for Stage 2b.
Detection Zone Layout based upon a design speed of 30 mph.

DSNR: RPG OPER: JGP SCALE: 1:500
 I:/1997/97362/SIGNALS/TEMP/TYLER.DGN 3-11-2002 10:31:18 LAST REV: 4-15-02 BY:

UTILITIES
See Plan Sheet for Utilities.

| | | | |
|-----|-----------|----|------|
| No. | Revisions | By | Date |
| | | | |

CITY OF WICHITA

TEMPORARY TRAFFIC SIGNAL
KELLOGG & TYLER RD. STAGE 2

SEDGWICK COUNTY

Professional Engineering Consultants, P.A.
303 S. TOPEKA • WICHITA, KANSAS 67202
316-262-2691 • FAX 316-262-3003

| | | | |
|-------------|-----|------------|-------------|
| Designed by | RPG | Checked by | BER |
| Drawn by | JSB | Date | April, 2002 |
| | | Job No. | 97362 |