

FHWA REGION NO.	STATE	PROJECT NO.	YEAR	SHEET NO.	TOTAL SHEETS
7	KANSAS	54-87 K-6657-01	2002	847	1122

NOTE: FOR ACTUAL LOCATION OF IRRIGATION ITEMS, SEE IRRIGATION RECORD DRAWINGS, SHEET NO. 871A TO 871N.

DATE	
BY	
REFERENCES NOTED	
REFERENCES CHECKED	

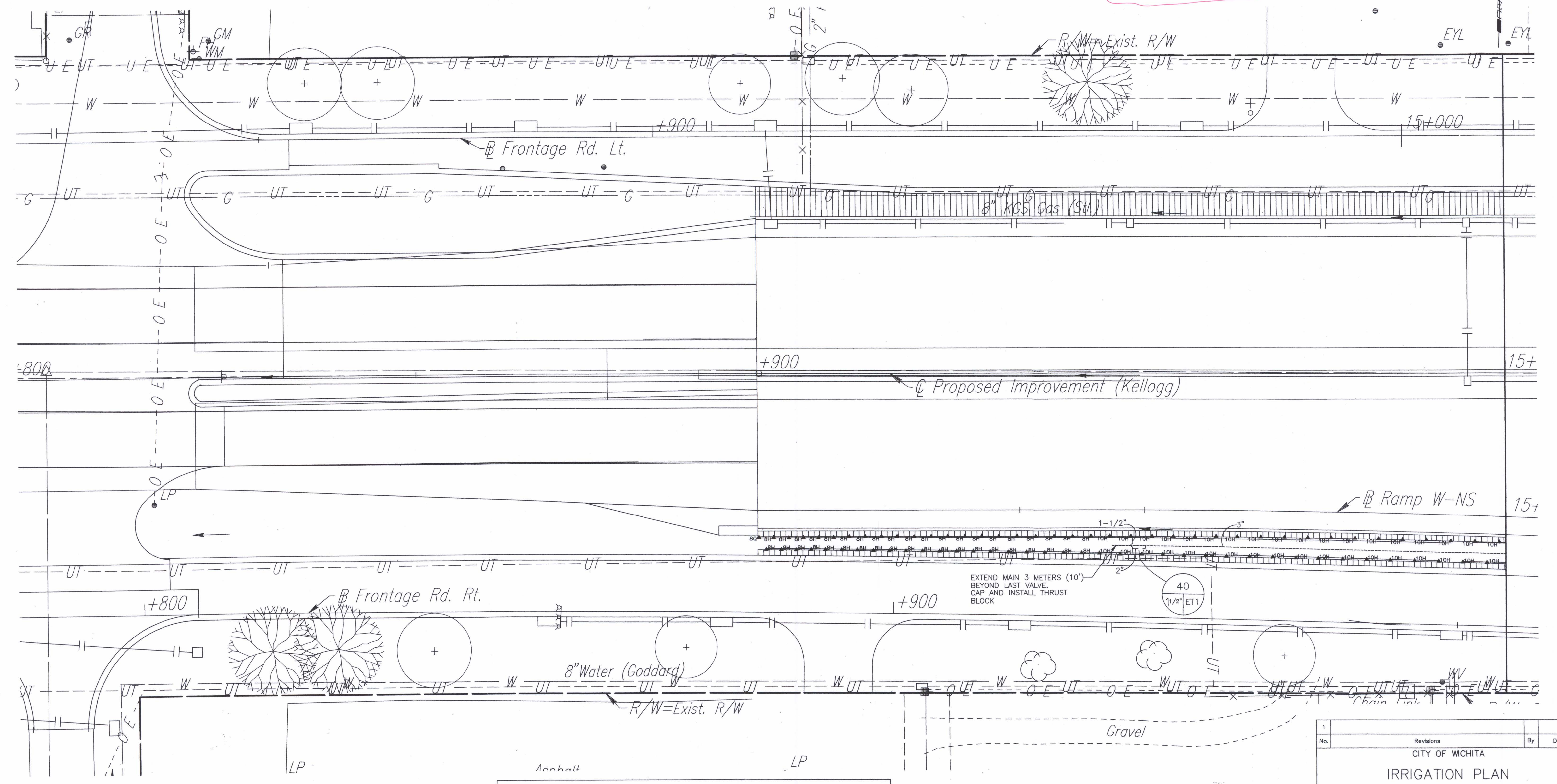

DSNR: OPER: DWR SCALE: 1:500
 F: 9934/15146 BY: DWR



IRRIGATION PLAN
 METRIC SCALE: 1 : 250
 CONVERSION RATIO: 1 METER = 3.28'



NOTE: UTILITIES INDICATED CONSIST OF EXISTING AND PROPOSED. CONTRACTOR SHALL FIELD VERIFY ALL UTILITY INFORMATION. COORDINATE THROUGH KANSAS ONE CALL.

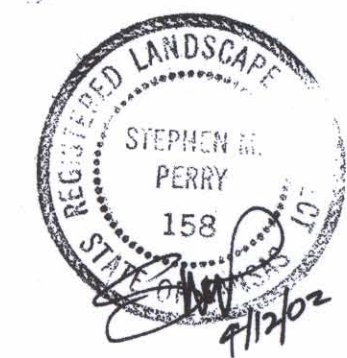

No.	Revisions	By	Date
CITY OF WICHITA			
IRRIGATION PLAN			
STA. 14+800 TO STA. 15+000			
SEDGWICK COUNTY			
Professional Engineering Consultants, P.A.			
303 S. TOPEKA • WICHITA, KANSAS 67202 316-262-2691 • FAX 316-262-3003			
Designed by	SMP	Checked by	
Drawn by	DWR	Date	April, 2002
		Job No.	97362