

FHWA REGION NO.	STATE	PROJECT NO.	YEAR	SHEET NO.	TOTAL SHEETS
7	KANSAS	54-87 K-6657-01	2002	888	1122

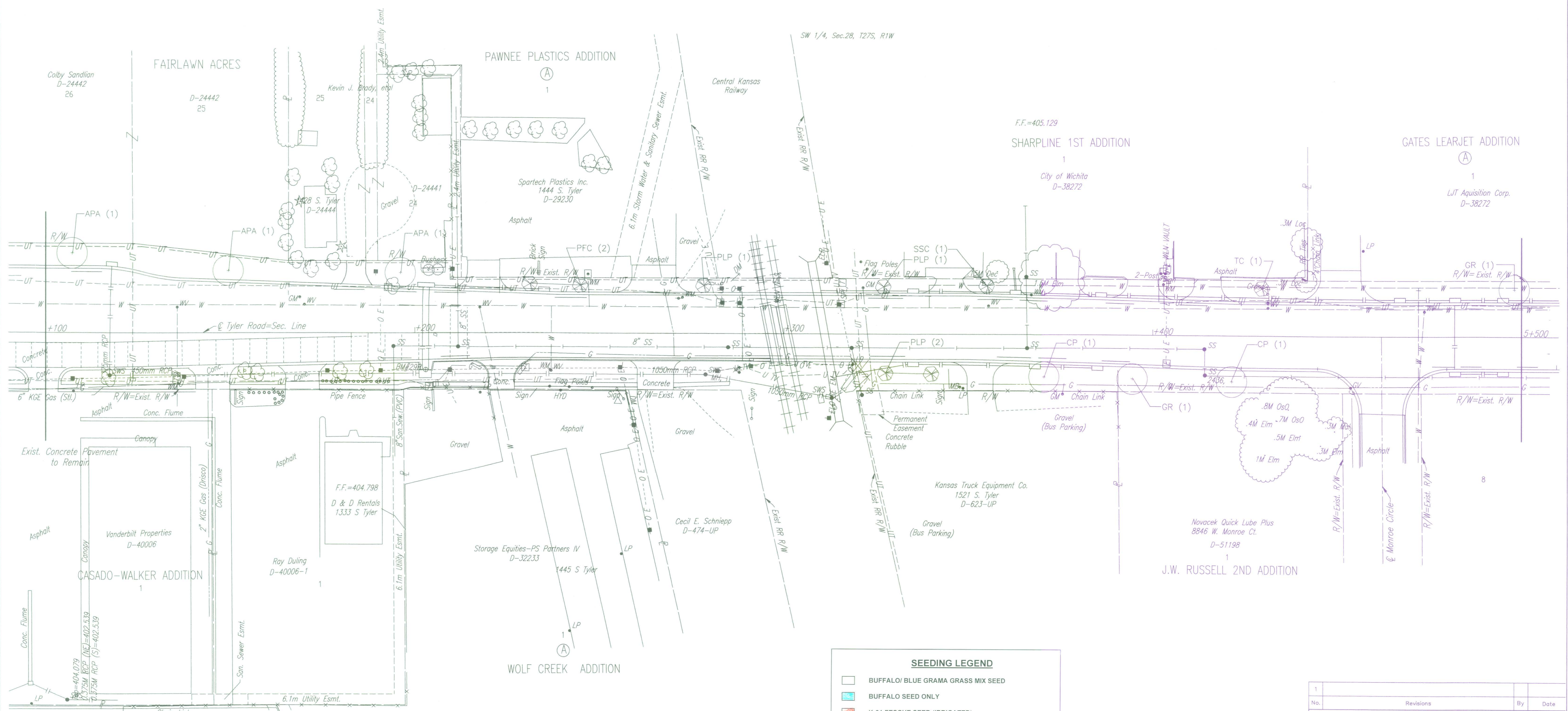

DATE	
BY	
REFERENCES NOTED	
REFERENCES CHECKED	



SEEDING LEGEND	
[Symbol]	BUFFALO/BLUE GRAMA GRASS MIX SEED
[Symbol]	BUFFALO SEED ONLY
[Symbol]	K-31 FESCUE SEED (IRRIGATED)
[Symbol]	K-31 FESCUE SEED (NON-IRRIGATED)
[Symbol]	FESCUE SOD
[Symbol]	COWSKIN CREEK MITIGATION SEEDING
[Symbol]	SOD INSTALLED BY OTHERS (NO-PAY)
[Symbol]	ADDITIONAL AREAS SEED BY CONTRACTOR (NO-PAY)
[Symbol]	AREAS NOT RECEIVING PERMANENT SEEDING

UTILITIES
 Power - K G & E
 Telephone - Southwestern Bell
 Gas - K G & E Gas
 Cable TV - Cox Communications
 Water - City of Wichita Water Dept.
 San. Sewer - City of Wichita Sewer Dept.

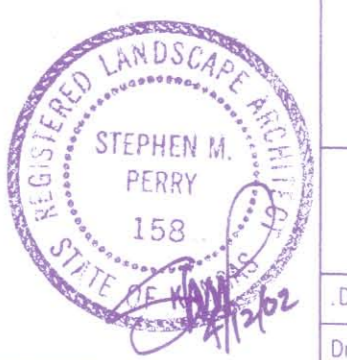

1			
No.	Revisions	By	Date
CITY OF WICHITA LANDSCAPE PLAN TYLER ROAD STA. 5+100 TO STA. 5+500 SEDGWICK COUNTY			
Professional Engineering Consultants, P.A. 303 S. TOPEKA • WICHITA, KANSAS 67202 316-262-2691 • FAX 316-262-3003			
Designed by	SMP	Checked by	
Drawn by	DWR	Date	April, 2002
		Job No.	97362

DSNR: WDH OPER: DWR SCALE: 1:500
 F: 9934/TYLS5100

