

STATE	PROJECT NO.	YEAR	SHEET NO.	TOTAL SHEETS
KANSAS	54-87 K-6657-01	2002	894A	1122

LEGEND

-  AREA I - EMERGENT/WET SPECIES
-  AREA II - WET PRAIRIE SPECIES
-  AREA III - MESIC PRAIRIE SPECIES
-  LIVE STAKES
-  SHRUB/WILDFLOWER MIX

TREES NOT PART OF WETLAND MITIGATION PLAN

TREES NOT PART OF WETLAND MITIGATION PLAN

BID ITEM
WETLAND MITIGATION PLAN: LUMP SUM

NOTES:

- SEED INSTALLATION**
SEEDING SHALL BE DONE IN LATE FALL (PREFERABLE) AFTER NOVEMBER 1, OR IN EARLY SPRING AFTER SOIL IS FROST FREE BUT NO LATER THAN JUNE 15. IF SEED IS SPRING PLANTED IT SHALL HAVE PROPER STRATIFICATION/SCARIFICATION TO BREAK DORMANCY.
PRIOR TO SEEDING THE CONTRACTOR SHALL DISC THE ENTIRE AREA ROTOVATE OR CHISEL PLOW TO REDUCE COMPACTION.
SEED SHALL BE PLANTED USING A GRAIN DRILL OR NO-TILL PLANTER, OR BROADCAST ONTO A LIGHTLY TILLED SOIL SURFACE AND PRESSED IN WITH A CULTIPACKER TYPE ROLLER. IF SOIL IS TO WET TO INSTALL SEED AS DESCRIBED ABOVE, SEED MAY BE BROADCAST AND THEN ROLLED OR DRAGGED PERPENDICULAR TO THE SLOPE WITHIN 24 HRS.
WITHIN 7 DAYS CRIMP STRAW OR PRAIRIE HAY OVER ENTIRE AREA (EXCEPT AREA I) AT A RATIO OF 2,000 LBS/ACRE
- SEED TYPES**
- AREA I**
SPARTINA PECTINATA - PRAIRIE CORD GRASS 2 OZ/ACRE
JUNCUS EFFUSUS - SPIKE RUSH 1
SCIRPUS AMERICANUS - CHAIRMAKERS RUSH 0.5
CALAMAGROSTIS CANADENSIS - BLUE JOINT GRASS 5
CAREX VULPINOIDEA - FOX SEDGE 32
- AREA II**
PANICUM VIRGATUM - SWITCH GRASS 16 OZ/ACRE
ECHINOCHLOA CRUSGALLI - BARNYARD GRASS 6
SPARTINA PECTINATA - PRAIRIE CORD GRASS 2
ELYMUS CANADENSIS - CANADA WILD RYE 8
ELYMUS VIRGINICUS - VIRGINIA WILD RYE 6.4
ANDROPOGON GERARDII - BIG BLUESTEM 80
- AREA III**
ANDROPOGON SCOPARIUS - LITTLE BLUESTEM 120 OZ/ACRE
ELYMUS CANADENSIS - CANADA WILD RYE 8
ELYMUS VIRGINICUS - VIRGINIA WILD RYE 6.4
PANICUM VIRGATUM - SWITCH GRASS 16
SPARTINA PECTINATA - PRAIRIE CORD GRASS 2
BOULETELOUA CURTIPENDULA - SIDE OATS GRAMMA 120
LIVE STAKES - UNROOTED CUTTINGS 18-24" LONG 1/2 DIA. MIN 10 % OF MIX
- NATIVE SEEDLINGS - AREA III ONLY PER ACRE**
ALL SEEDLINGS TO BE 1-02-0 BARE ROOT NURSERY STOCK
POPULUS DELTOIDES - COTTONWOOD 50
CELTIS OCCIDENTALIS - HACKBERRY 50
JUGLANS NIGRA - BLACK WALNUT 50
- SHRUB/WILDFLOWER MIX**
NATIVE SHRUB/WILDFLOWER KANSAS MIX SEEDING AT 1 LBS/ACRE
- NATIVE SEEDLINGS ARE TO BE INSTALLED WITH PROTECTION TUBES**
4" DIA X 24" TALL PHOTODEGRADABLE PLASTIC WITH A TWO YEAR LIFE SPAN SUCH AS PRO/GRO TUBES MANUFACTURED BY PROTEX TUBES ARE TO BE STAKED TO THE GROUND WITH BAMBOO STAKES AND PLASTIC CABLE TIES
- EROSION CONTROL - INSTALL EROSION CONTROL FABRIC OVER SEED**
IN AREA I, UP STREAM SIDE OF ALL FABRIC SHALL BE BURIED IN A TRENCH. STAKE FABRIC PER MFR. RECOMMENDATIONS. EROSION CONTROL FABRIC SHALL BE:
100% BIODEGRADABLE COCONUT FIBER WITH FIBER NETTING
EROSION CONTROL FABRIC SHALL BE C125BN AS AVAILABLE FROM NORTH AMERICAN GREEN (1-800-112-2040) OR AN APPROVED EQUAL.
- POSSIBLE NATIVE SEED AND PLANT SOURCES:**
VALLEY FEED AND SEED FORREST KEELING NURSERY
1903 SOUTH MERIDIAN HWY 79 S. PO BOX 135
WICHITA, KS. 67213 ELSEBERRY, MO 63343
316-942-2278 800-356-2401
SHARP BROTHERS SEED COMPANY MISSOURI WILDFLOWER NURSERY
376 SW DAVIS ST. - LADUE 9814 PLEASANT HILL ROAD
CLINTON, MO 64735 JEFFERSON CITY, MO 65109
816-885-7551 573-496-3492

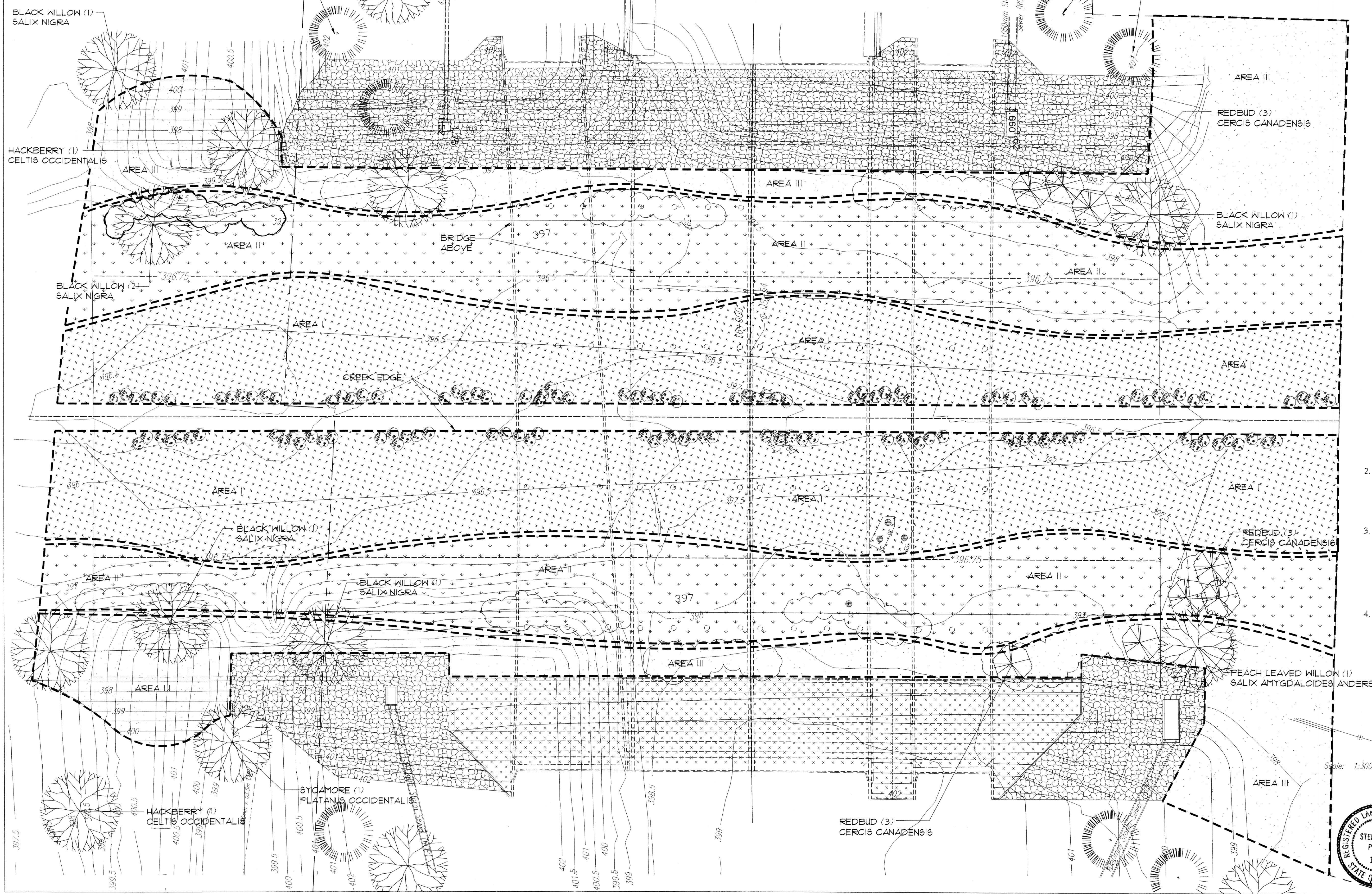

DSNR: OPER: DWR SCALE: 1:300
 I:/1997/97362/001/BRIDGE/CONSKIN/RIPRAP.DGN 11-26-2001 11:42:12 LAST REV: 1-30-2002 BY: ros

No.	Revisions	By	Date

CITY OF WICHITA
COWSKIN CREEK WETLAND MITIGATION PLAN
SEDGWICK COUNTY

Professional Engineering Consultants, P.A.
303 S. TOPEKA • WICHITA, KANSAS 67202
316-262-2691 • FAX 316-262-3003

Designed by	SMP	Checked by	XXX
Drawn by	DWR	Date	April, 2002
		Job No.	97362

