

FHWA REGION NO.	STATE	PROJECT NO.	YEAR	SHEET NO.	TOTAL SHEETS
7	KANSAS	54-87 K-6657-01	2002	86	1122

DATE	
BY	
REFERENCES NOTED	
REFERENCES CHECKED	

DSMR: WDH OPER: JGP SCALE: 1:200
 i:/1997/97362/As-Builts/dgn/s/STL_086-insect.dgn Last Rev: 8-9-07 By: gdr

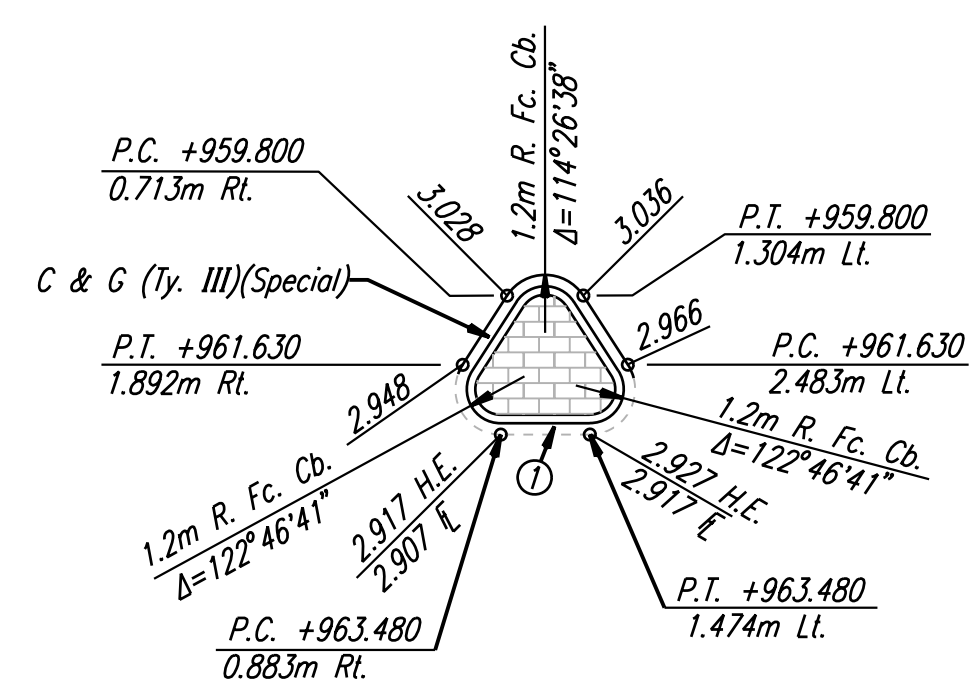
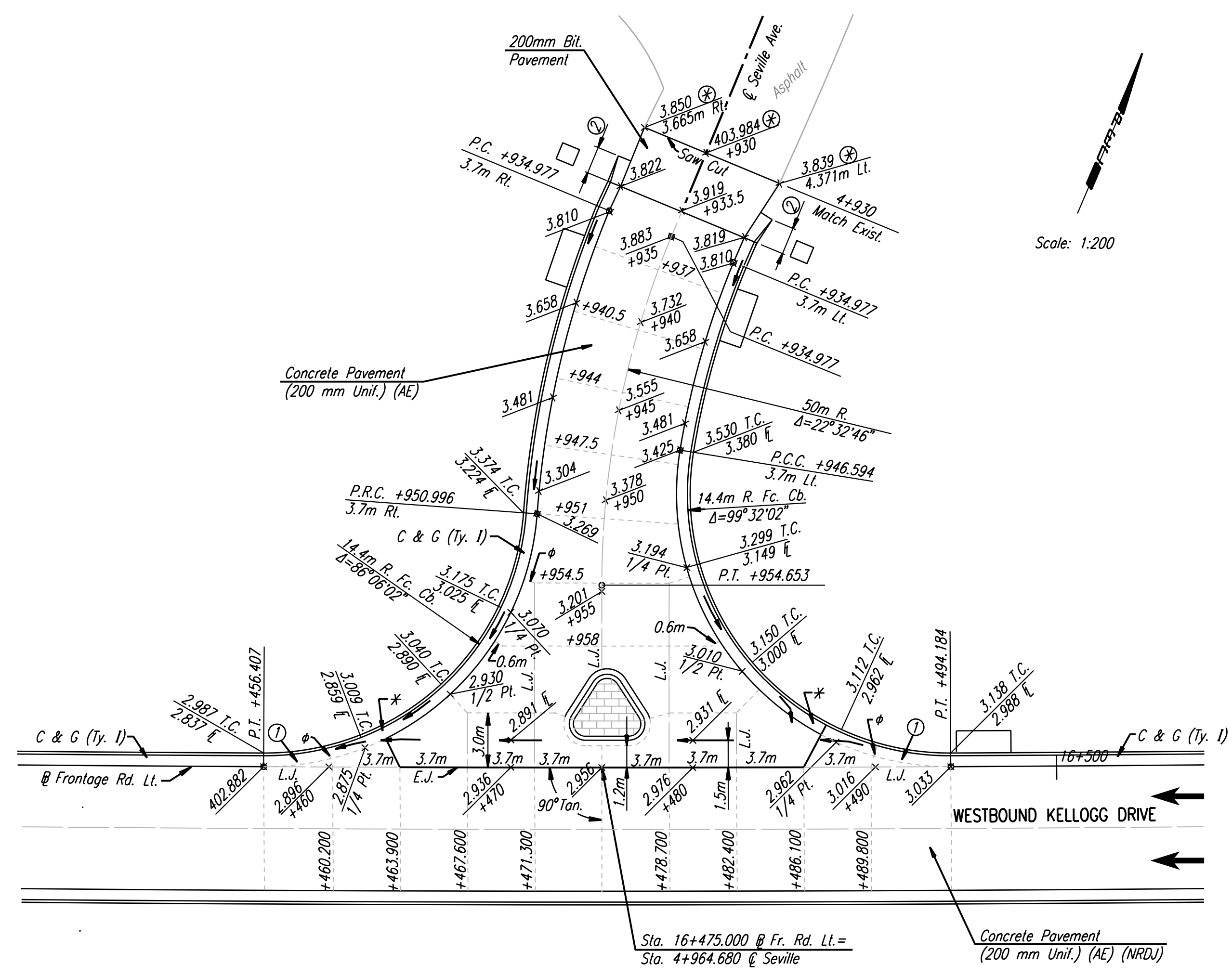

- ⊗ Match Existing
- * Warp gutter to drain. Curb height varies. See spots.
- φ Omit dowel or tie bars (Typ.)
- ① Curb to be cast monolithic with pavement. Paid for as C. & G.
- ② 1.5m Transition from No Curb to 150 mm Curb.
- L.J. Longitudinal Joint (Tied)
- C.J. Transverse Contraction Joint
- E.J. Expansion Joint (Untied)
- Paving Brick (Median)

Note: Spot Elevations are to top of finished pavement.
 See Coordinate Geometry Sheets for ϕ Curve Data.

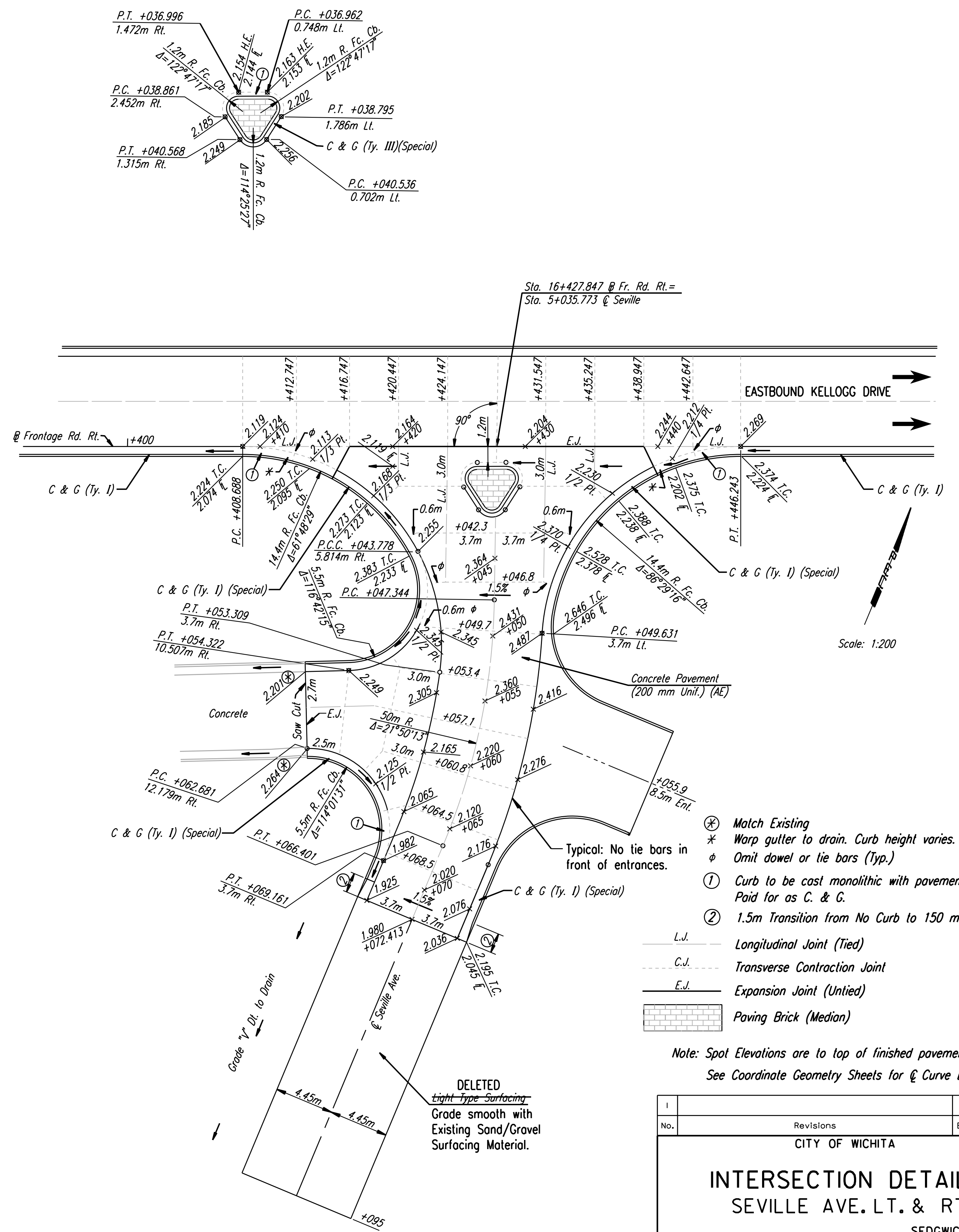

- ⊗ Match Existing
- * Warp gutter to drain. Curb height varies. See spots.
- φ Omit dowel or tie bars (Typ.)
- ① Curb to be cast monolithic with pavement. Paid for as C. & G.
- ② 1.5m Transition from No Curb to 150 mm Curb.
- L.J. Longitudinal Joint (Tied)
- C.J. Transverse Contraction Joint
- E.J. Expansion Joint (Untied)
- Paving Brick (Median)

Note: Spot Elevations are to top of finished pavement.
 See Coordinate Geometry Sheets for ϕ Curve Data.

CITY OF WICHITA			
INTERSECTION DETAILS SEVILLE AVE. LT. & RT.			
SEDGWICK COUNTY			
Professional Engineering Consultants, P.A.			
303 S. TOPEKA • WICHITA, KANSAS 67202 316-262-2691 • FAX 316-262-3003			
Designed by	WDH	Checked by	WDH
Drawn by	JGP	Date	Apr 11, 2002
		Job No.	97362

RECORD DRAWING