

FHWA REGION NO.	STATE	PROJECT NO.	YEAR	SHEET NO.	TOTAL SHEETS
7	KANSAS	54-87 K-6657-01	2002	91	1122

DATE	
BY	
REFERENCES NOTED	
REFERENCES CHECKED	

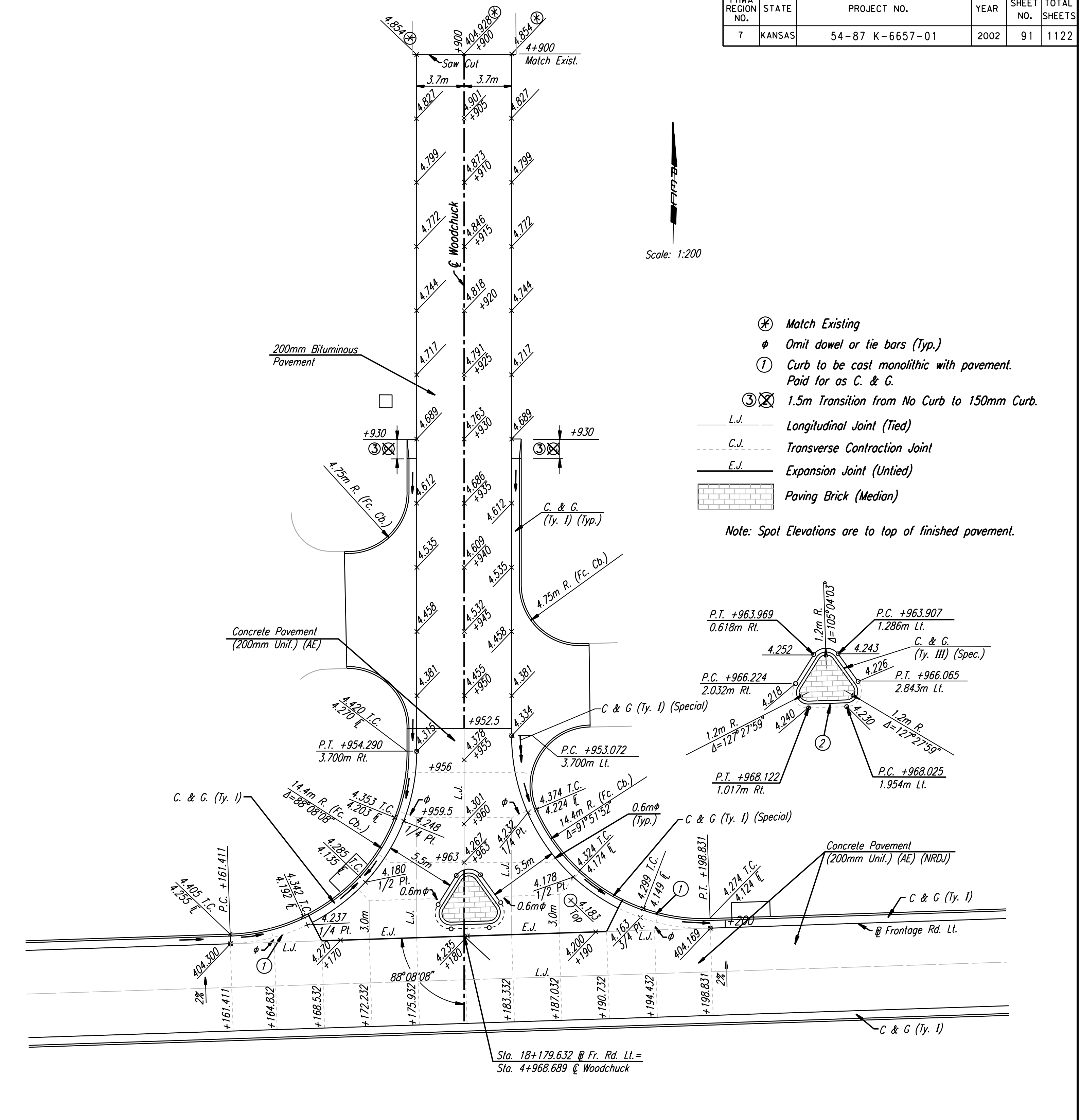
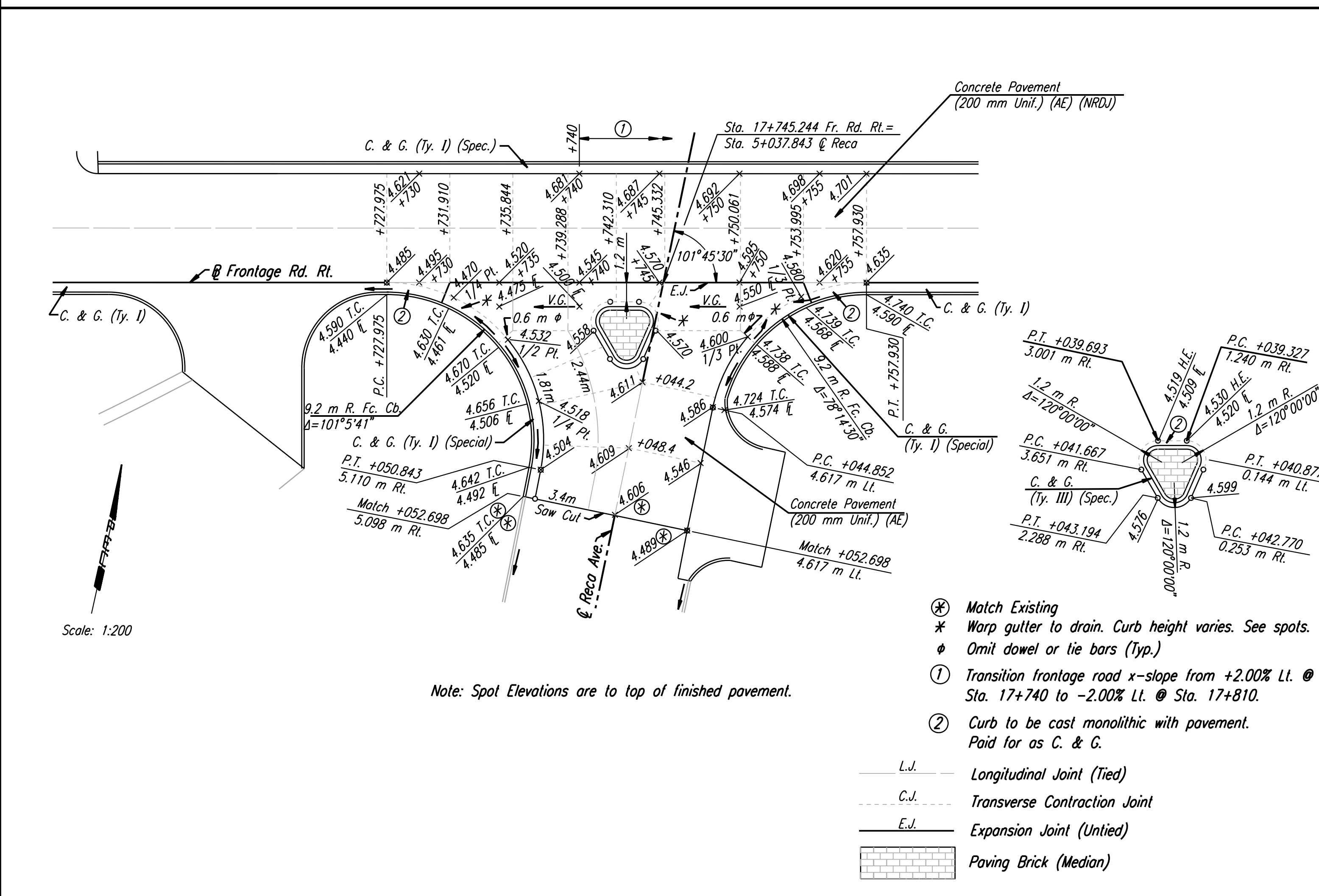
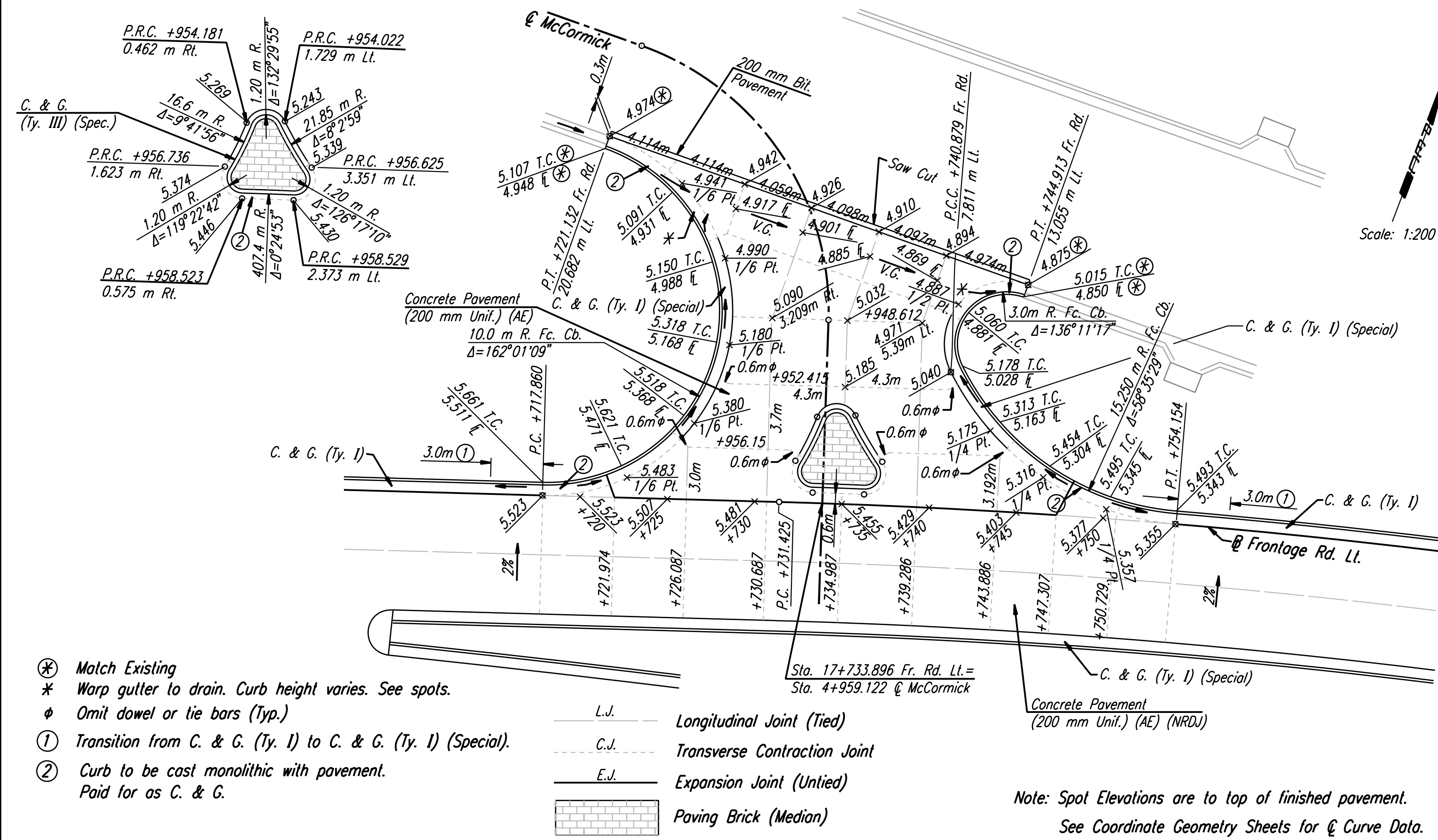

DSNR: WDH OPER: JGP SCALE: 1:200
 i:/1997/97362/As-Builts/dgn/s/SH_091-insect.dgn Last Rev: 8-9-07 By: gdr

No.	Revisions	By	Date

CITY OF WICHITA
INTERSECTION DETAILS
RECA, McCORMICK &
WOODCHUCK LT.
 SEDGWICK COUNTY

Professional Engineering Consultants, P.A.
 303 S. TOPEKA • WICHITA, KANSAS 67202
 316-262-2691 • FAX 316-262-3003

Designed by	WDH	Checked by	WDH
Drawn by	JGP	Date	Apr 11, 2002
		Job No.	97362

RECORD DRAWING