

FHWA REGION NO.	STATE	PROJECT NO.	YEAR	SHEET NO.	TOTAL SHEETS
7	KANSAS	54-87 K-6657-01	2002	94	1122

DATE	
BY	
REFERENCES NOTED	
REFERENCES CHECKED	

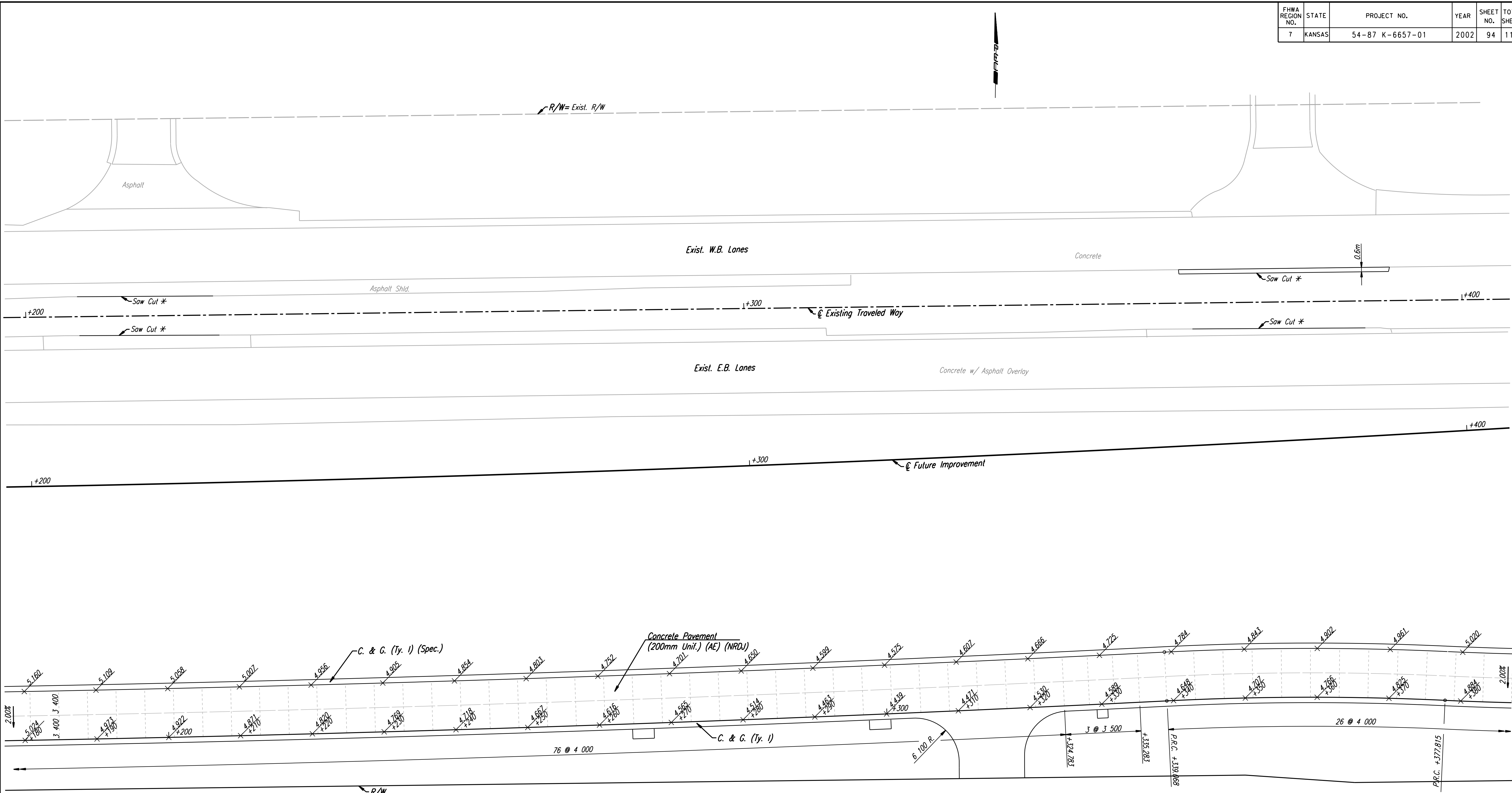

DSNR: WDH OPER: JGP SCALE: 1:250
 i:/1997/97362/As-Builts/dgn/s/SH_094-pav142.dgn Last Rev: 8-10-07 By: gdr

* Saw cut to a neat line at median crossover locations.

RECORD DRAWING

No.	Revisions	By	Date
CITY OF WICHITA			
PAVING PLAN			
STA. 14+200 TO STA. 14+400			
SEDGWICK COUNTY			
Professional Engineering Consultants, P.A. 303 S. TOPEKA • WICHITA, KANSAS 67202 316-262-2691 • FAX 316-262-3003			
Designed by	WDH	Checked by	WDH
Drawn by	JGP	Date	April, 2002
		Job No.	97362