

DATE	
BY	
REFERENCES NOTED	
REFERENCES CHECKED	

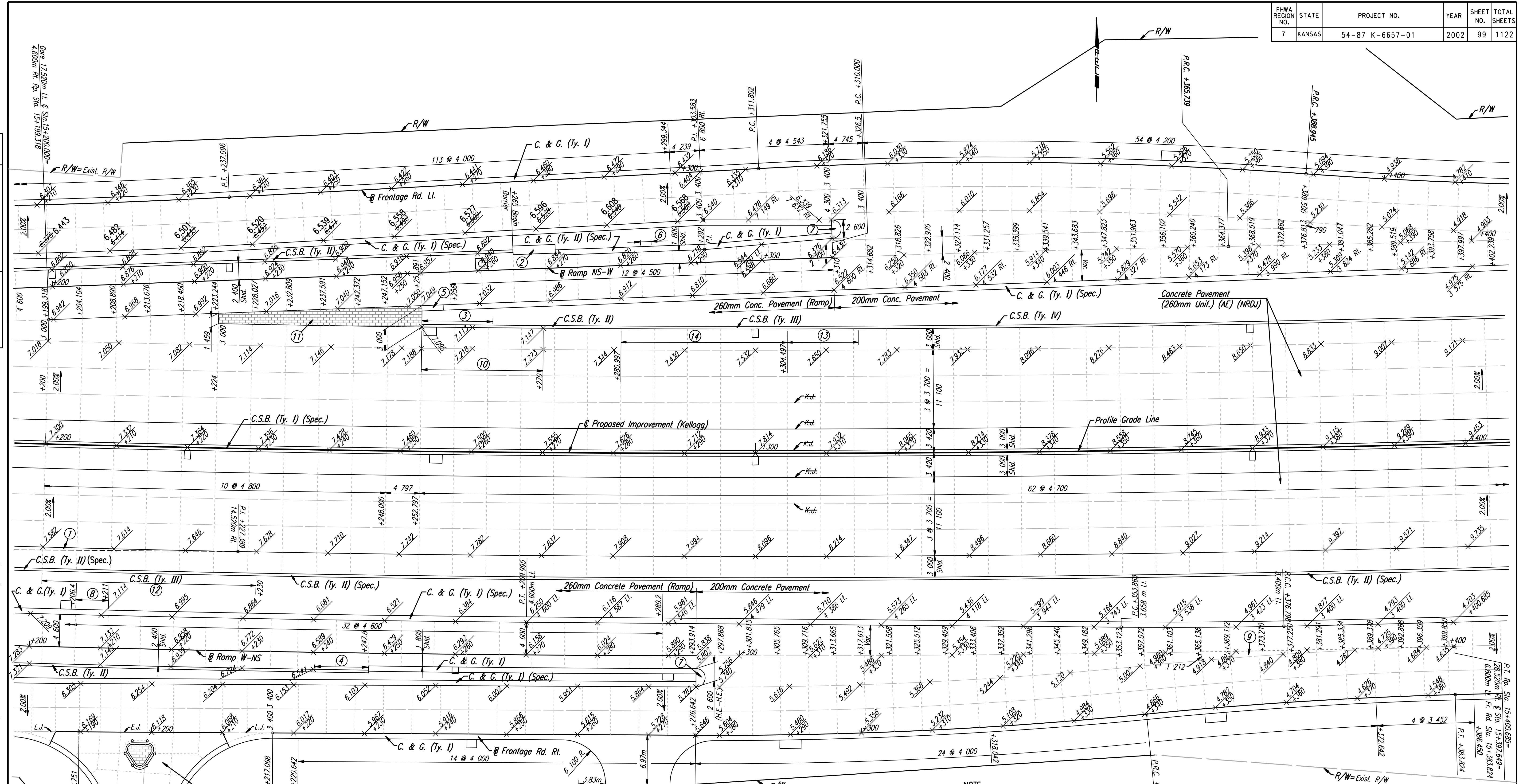

DSNR: WDH OPER: JGP SCALE: 1:250
 i:/1997/97362/As-Builts/dgn's/Sh 099-pav152.dgn Last Rev: 8-13-07 By: gdr

NOTE:
Tie bars were omitted across all Side Roads along Frontage Road Pavement.

- ① To be placed monolithic with shoulder pavement. Paid for as "Concrete Pavement (260 mm Unit.) (AE) (NRDU).
- ② Impact Attenuator. See Sh. No. 234 for Concrete Pad & Backup Wall Details.
- ③ 10.0 m transition from No Barrier to C.S.B. (Ty. II). To be paid for as C.S.B. (Ty. II).
- ④ 7.6 m transition from C.S.B. (Ty. II) to C. & G. (Ty. I). (See Sh. No. 232A)
- ⑤ 3.0 m transition from no curb to 150 mm curb.
- ⑥ 1.5 m transition from C. & G. (Ty. II) (Spec.) to C. & G. (Ty. I).
- ⑦ See Sh. No. 130 for Median Nose Detail.
- ⑧ 4.6 m transition from C. & G. (Ty. I) to C. & G. (Ty. I) (Spec.).
- ⑨ Place monolithic with ramp pavement.
- ⑩ Transition outside shoulder slope from -3.0% @ Sta. 15+252.8 to -4.2% @ Sta. 15+270.
- ⑪ Integrally Colored Cement Concrete Pavement (D=260mm) See Landscape Plans.
- ⑫ C.S.B. (Ty. III) Sta. 15+200 to Sta. 15+230.
- ⑬ 10.0m transition from 815mm tall barrier to 1300mm tall barrier. Paid for as C.S.B. (Ty. IV).
- ⑭ C.S.B. (Ty. III) Sta. 15+280.997 to Sta. 15+304.497.

CITY OF WICHITA			
PAVING PLAN			
STA. 15+200 TO STA. 15+400			
SEDGWICK COUNTY			
<small>303 S. TOPEKA • WICHITA, KANSAS 67202 316-262-2691 • FAX 316-262-3003</small>			
Designed by	WDH	Checked by	WDH
Drawn by	JGP	Date	Apr 11, 2002
		Job No.	97362

RECORD DRAWING