

FHWA REGION NO.	STATE	PROJECT NO.	YEAR	SHEET NO.	TOTAL SHEETS
7	KANSAS	54-87 K-6657-01	2002	100	1122

DATE	
BY	
REFERENCES NOTED	
REFERENCES CHECKED	

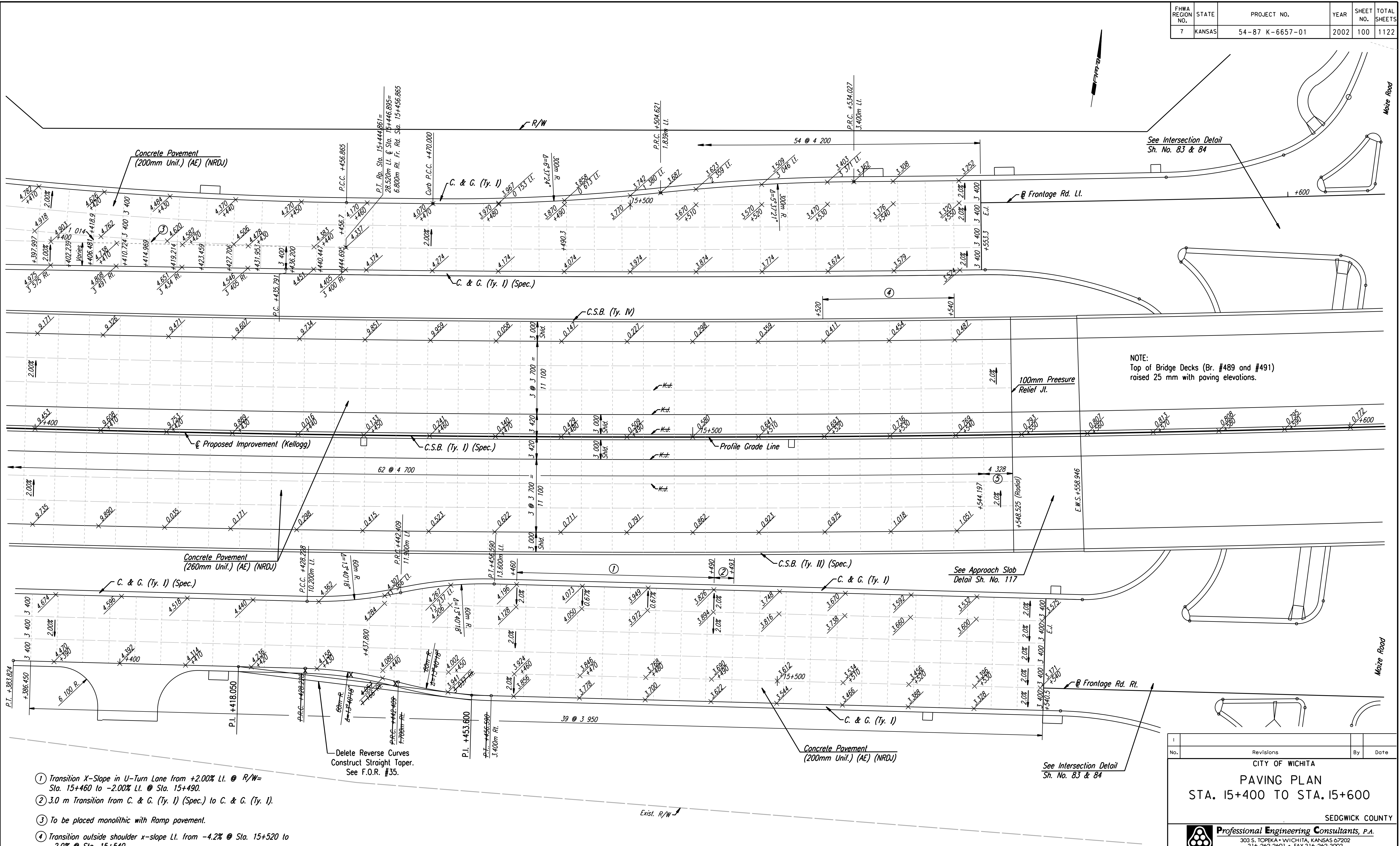

NOTE:
Top of Bridge Decks (Br. #489 and #491)
raised 25 mm with paving elevations.

- ① Transition X-Slope in U-Turn Lane from +2.00% Lt. @ R/W= Sta. 15+460 to -2.00% Lt. @ Sta. 15+490.
- ② 3.0 m Transition from C. & G. (Ty. I) (Spec.) to C. & G. (Ty. I).
- ③ To be placed monolithic with Ramp pavement.
- ④ Transition outside shoulder x-slope Lt. from -4.2% @ Sta. 15+520 to -2.0% @ Sta. 15+540.
- ⑤ Length includes 100mm Pressure Relief Joint.

No.	Revisions	By	Date

CITY OF WICHITA
PAVING PLAN
STA. 15+400 TO STA. 15+600

SEDGWICK COUNTY

Professional Engineering Consultants, P.A.
303 S. TOPEKA • WICHITA, KANSAS 67202
316-262-2691 • FAX 316-262-3003

Designed by	WDH	Checked by	WDH
Drawn by	JGP	Date	April, 2002
		Job No.	97362

RECORD DRAWING

DSNR: WDH OPER: JGP SCALE: 1:500
 I:/1997/97362/As-Builts/dgn s/Sh 100-pav154.dgn Last Rev: 8-13-07 By: gdr