

FHWA REGION NO.	STATE	PROJECT NO.	YEAR	SHEET NO.	TOTAL SHEETS
7	KANSAS	54-87 K-6657-01	2002	161	1122

DATE	
BY	
REFERENCES NOTED	
REFERENCES CHECKED	

**NOTE:**  
Additional SWS Gutter Inlet (#763-A) installed to accommodate increased local drainage area created by surrounding PC Concrete pavement not being constructed exactly to plan grade and cross-slope. Slotted Drain deleted. See Change Order #2.

S.R. Sta. 4+927 Construct Inlet Manhole (Special) 6.100m Rt. Install 375mm x 36.58m Storm Sewer (RCP) (S) See Sh. Nos. 141, 179, & 194

S.R. Sta. 4+930 Install 600mm End Section 8.300m Lt. Install 600mm x 35.66m Storm Sewer (RCP) (S) See Sh. Nos. 179, & 194

Sta. 18+171.843 Construct Curb Inlet (Type 22) (Radius) 4.222m Lt. Install 450mm x 16.76m Storm Sewer (RCP) (E) See Sh. Nos. 137, 179, & 194

Sta. 18+188 Construct R.C. Manhole 2.5m Lt. Install 600mm x 12.50m Storm Sewer (RCP) (E) See Sh. Nos. 142, 179, & 194

Sta. 18+202 Construct Curb Inlet (Type 22) Lt. Install 750mm x 67.97m Storm Sewer (RCP) (E) See Sh. Nos. 138, 179, & 194

Sta. 18+170 Construct Gutter Inlet Lt. Install 375 mm x 39.5 m Storm Sewer (RCP)(W) Added in lieu of Slotted Drain

Sta. 18+170 Construct Drainage Slot in Bottom of Type I (Special) Concrete Safety Barrier to facilitate drainage of E. Bd. Kellogg(US-54/400) inside Shld. See Field Order 7-22-04.

Sta. 18+160 Construct R.C. Manhole Lt. Install 600mm x 28.35m Storm Sewer (RCP) (E) See Sh. Nos. 142, 179, & 194

Sta. 5+043 Construct Curb Inlet (Type 22) Lt. Install 375mm x 20.73m Storm Sewer (RCP) (N) See Sh. Nos. 138, 179, & 194

Sta. 18+060 Construct Curb Inlet (Type 22) Lt. Install 375mm x 38.10m Storm Sewer (RCP) (E) See Sh. Nos. 138, 179, & 194

Sta. 18+154 Construct Gutter Inlet Rt. Install 375mm x 47.55m Storm Sewer (RCP) (E) See Sh. Nos. 139, 179, & 194

Sta. 18+100 Construct Curb Inlet (Type 22) Lt. Install 600mm x 59.44m Storm Sewer (RCP) (E) See Sh. Nos. 138, 179, & 194

Sta. 5+043 Construct Curb Inlet (Type 22) Rt. Install 375mm x 9.75m Storm Sewer (RCP) (E) See Sh. Nos. 138, 179, & 194

Sta. 18+050 Construct Gutter Inlet Rt. Install 375mm x 2.13m Storm Sewer (RCP) (S) See Sh. Nos. 139, 179, & 194

Sta. 18+037.5 Construct Curb Inlet (Type 22) Lt. Install 375mm x 20.12m Storm Sewer (RCP) (E) See Sh. Nos. 138, 179, & 194

Sta. 17+995 Construct Gutter Inlet Lt. Install 375mm x 45.11m Storm Sewer (RCP) (W) See Sh. Nos. 139, 178, & 193

Sta. 18+050 Construct Gutter Inlet Lt. Install 375mm x 54.56m Storm Sewer (RCP) (W) See Sh. Nos. 139, 178, & 193

Sta. 18+010 Construct Curb Inlet (Type 22) Lt. Install 375mm x 45.42m Storm Sewer (RCP) (W) See Sh. Nos. 138, 178, & 193

Sta. 17+962 Construct Curb Inlet (Type 22) Lt. Install 1050mm x 34.44m Storm Sewer (RCP) (W) Install 375mm x 6.10m Storm Sewer (RCP) (N) Connect to Inlet 770A See Sh. Nos. 138, 178, & 193

Sta. 17+949 Construct Gutter Inlet (Special) Lt. Install 1050mm x 29.87m Storm Sewer (RCP) (N) See Sh. Nos. 139, 178, & 193

Sta. 17+925 Construct Curb Inlet (Type 22) Lt. Install 1050mm x 73.15m Storm Sewer (RCP) (W) See Sh. Nos. 138, 178, & 193

Sta. 17+905 Construct Gutter Inlet Lt. Install 450mm x 43.28m Storm Sewer (RCP) (E) See Sh. Nos. 139, 178, & 193

Sta. 17+850 Construct Gutter Inlet Lt. Install 375m x 54.56m Storm Sewer (RCP) (E) See Sh. Nos. 139, 178, & 193

Sta. 17+850 Construct Curb Inlet (Type 22) Lt. Install 1050m x 67.06m Storm Sewer (RCP) (W) Connect to RCB 773 See Sh. Nos. 138, 178, & 193

Sta. 17+833 Construct Curb Inlet (Type 22) Lt. Install 375mm x 31.70m Storm Sewer (RCP) (E) See Sh. Nos. 138, 178, & 193

Sta. 17+882 Construct Gutter Inlet Rt. Install 450mm x 32.61m Storm Sewer (RCP) (E) See Sh. Nos. 139, 178, & 193

Sta. 17+940 Construct Curb Inlet (Type 22) Lt. Install 750mm x 3.66m Storm Sewer (RCP) (N) See Sh. Nos. 138, 178, & 193

Sta. 17+962 Construct Curb Inlet (Type 22) Lt. Install 375mm x 19.51m Storm Sewer (RCP) (W) See Sh. Nos. 138, 178, & 193

Sta. 17+995 Construct Gutter Inlet Rt. Install 375mm x 44.50m Storm Sewer (RCP) (W) See Sh. Nos. 139, 178, & 193

Sta. 17+912 Construct Curb Inlet (Type 22) Lt. Install 450mm x 25.60m Storm Sewer (RCP) (E) See Sh. Nos. 138, 178, & 193

Sta. 17+915 Construct Gutter Inlet Rt. Install 600mm x 33.22m Storm Sewer (RCP) (E) See Sh. Nos. 139, 178, & 193

Sta. 17+867 Construct Curb Inlet (Type 22) Lt. Install 375mm x 42.98m Storm Sewer (RCP) (E) See Sh. Nos. 138, 178, & 193

Sta. 17+850 Construct Gutter Inlet Rt. Install 375mm x 31.39m Storm Sewer (RCP) (E) See Sh. Nos. 139, 178, & 193

**EXTRA - WORK:**  
Sta. 17+864 Construct PC Concrete Drainage Flume Rt. (0.75 m width x 6.2 m length) to drain water from north-south drainage swale on private property to the south. See Change Order #3.

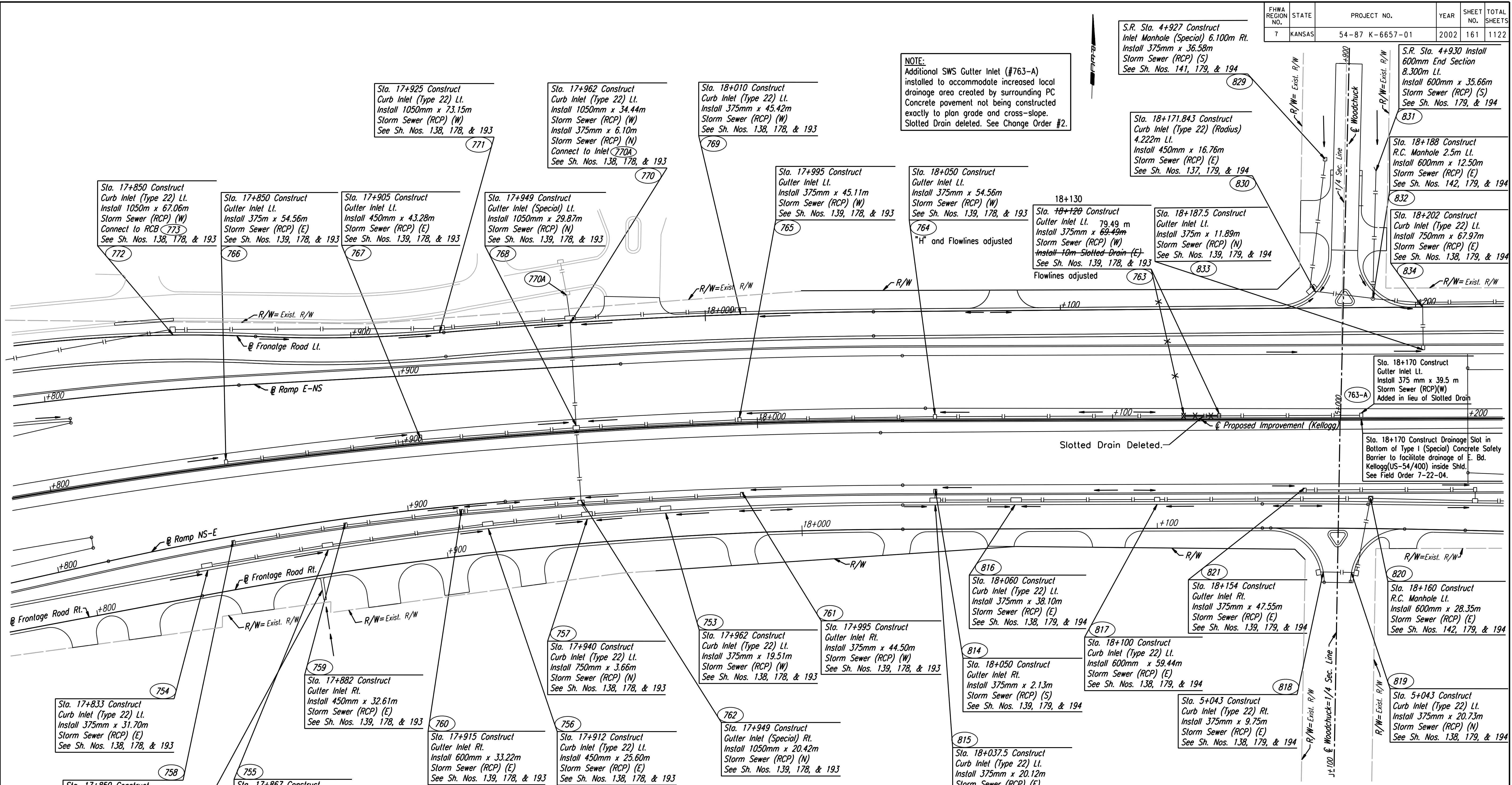

DSNR: JPS OPER: JGP SCALE: 1:500  
 I:/1997/97362/As-Built/dgn/s/161-sws178.dgn Last Rev: 8-2-07 By: gdr

**RECORD DRAWING**

No.	Revisions	By	Date

CITY OF WICHITA

**STORM WATER SEWER**  
STA. 17+800 TO STA. 18+200

SEDGWICK COUNTY

**Professional Engineering Consultants, P.A.**  
303 S. TOPEKA • WICHITA, KANSAS 67202  
316-262-2691 • FAX 316-262-3003

Designed by	RCH	Checked by	WDH
Drawn by	JGP	Date	April, 2002
		Job No.	97362