

FHWA REGION NO.	STATE	PROJECT NO.	YEAR	SHEET NO.	TOTAL SHEETS
7	KANSAS	54-87 K-6657-01	2002	162	1122

DATE	
BY	
REFERENCES NOTED	
REFERENCES CHECKED	

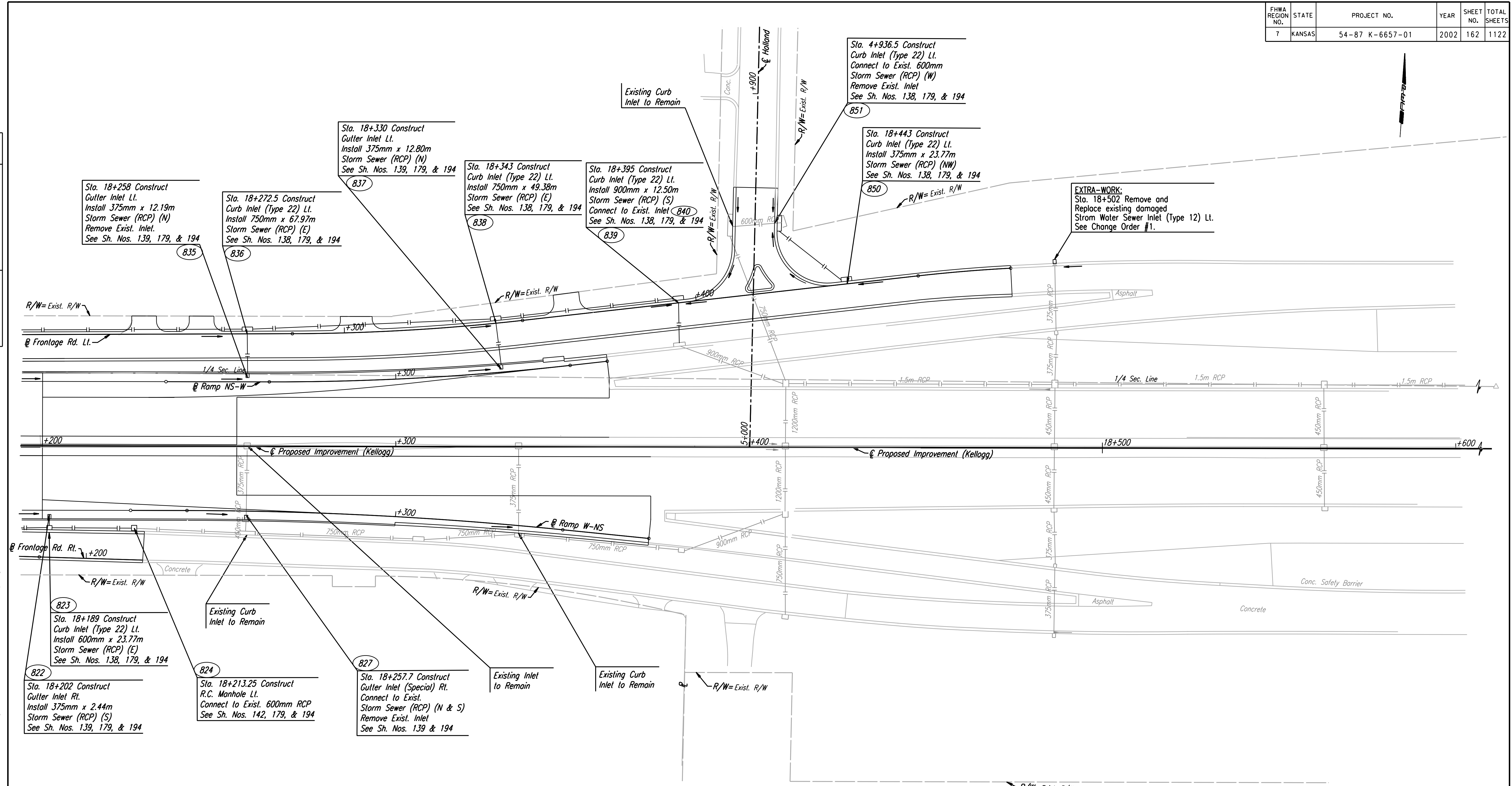

DSNR: JPS OPER: JGP SCALE: 1:500
 i:/1997/97362/As-Builts/dgn's/Sh 162-sws182.dgn Last Rev: 8-2-07 By: gdr

822
 Sta. 18+202 Construct
 Gutter Inlet Rt.
 Install 375mm x 2.44m
 Storm Sewer (RCP) (S)
 See Sh. Nos. 139, 179, & 194

824
 Sta. 18+213.25 Construct
 R.C. Manhole Lt.
 Connect to Exist. 600mm RCP
 See Sh. Nos. 142, 179, & 194

827
 Sta. 18+257.7 Construct
 Gutter Inlet (Special) Rt.
 Connect to Exist.
 Storm Sewer (RCP) (N & S)
 Remove Exist. Inlet
 See Sh. Nos. 139 & 194

823
 Sta. 18+189 Construct
 Curb Inlet (Type 22) Lt.
 Install 600mm x 23.77m
 Storm Sewer (RCP) (E)
 See Sh. Nos. 138, 179, & 194

835
 Sta. 18+258 Construct
 Gutter Inlet Lt.
 Install 375mm x 12.19m
 Storm Sewer (RCP) (N)
 Remove Exist. Inlet.
 See Sh. Nos. 139, 179, & 194

836
 Sta. 18+272.5 Construct
 Curb Inlet (Type 22) Lt.
 Install 750mm x 67.97m
 Storm Sewer (RCP) (E)
 See Sh. Nos. 138, 179, & 194

837
 Sta. 18+330 Construct
 Gutter Inlet Lt.
 Install 375mm x 12.80m
 Storm Sewer (RCP) (N)
 See Sh. Nos. 139, 179, & 194

838
 Sta. 18+343 Construct
 Curb Inlet (Type 22) Lt.
 Install 750mm x 49.38m
 Storm Sewer (RCP) (E)
 See Sh. Nos. 138, 179, & 194

839
 Sta. 18+395 Construct
 Curb Inlet (Type 22) Lt.
 Install 900mm x 12.50m
 Storm Sewer (RCP) (S)
 Connect to Exist. Inlet (840)
 See Sh. Nos. 138, 179, & 194

850
 Sta. 18+443 Construct
 Curb Inlet (Type 22) Lt.
 Install 375mm x 23.77m
 Storm Sewer (RCP) (NW)
 See Sh. Nos. 138, 179, & 194

851
 Sta. 4+936.5 Construct
 Curb Inlet (Type 22) Lt.
 Connect to Exist. 600mm
 Storm Sewer (RCP) (W)
 Remove Exist. Inlet
 See Sh. Nos. 138, 179, & 194

EXTRA-WORK:
 Sta. 18+502 Remove and
 Replace existing damaged
 Storm Water Sewer Inlet (Type 12) Lt.
 See Change Order #1.

RECORD DRAWING

1			
No.	Revisions	By	Date
CITY OF WICHITA			
STORM WATER SEWER STA. 18+200 TO STA. 18+600			
SEDGWICK COUNTY			
Professional Engineering Consultants, P.A. <small>303 S. TOPEKA • WICHITA, KANSAS 67202 316-262-2691 • FAX 316-262-3003</small>			
Designed by	RCH	Checked by	WDH
Drawn by	JGP	Date	April, 2002
		Job No.	97362