

STATE	PROJECT NO.	YEAR	SHEET NO.	TOTAL SHEETS
KANSAS	54-87 K-6657-01	2002	276	1122

LAYOUT INFORMATION				
Point No.	North Coordinate	East Coordinate	Station	Offset
1	511368.597	491402.969	15+401.617	15.995 Lt.
2	511371.968	491402.526	15+401.617	19.395 Lt.
3	511374.558	491421.849	15+421.215	19.395 Lt.
4	511371.190	491422.310	15+421.215	15.995 Lt.

REINFORCING STEEL							
Straight Bars				Bent Bars			
Mark	Size	Number	Length	Mark	Size	Number	Length
FI-1	*25	164	3320	FI-3	*22	130	3110
FI-2	*25	44	10 670	FI-4	*22	66	2320
FI-6	*19	130	3510	FI-5	*19	130	1500
FI-7	*13	66	3200	FI-9	*16	66	1350
FI-8	*16	74	9650				
FI-10	*19	66	2790				
FI-11	*13	66	2890				
FI-12	*29	36	4000				

WALL QUANTITIES		
Item	Quantity	Unit
Pressure Grouted Pile (406 mm)	336.0	m
Concrete (Grade 30)(AE)	117.0	m ³
Reinforcing Steel (Grade 420)	9966	kg
Class III Excavation	105.8	m ³

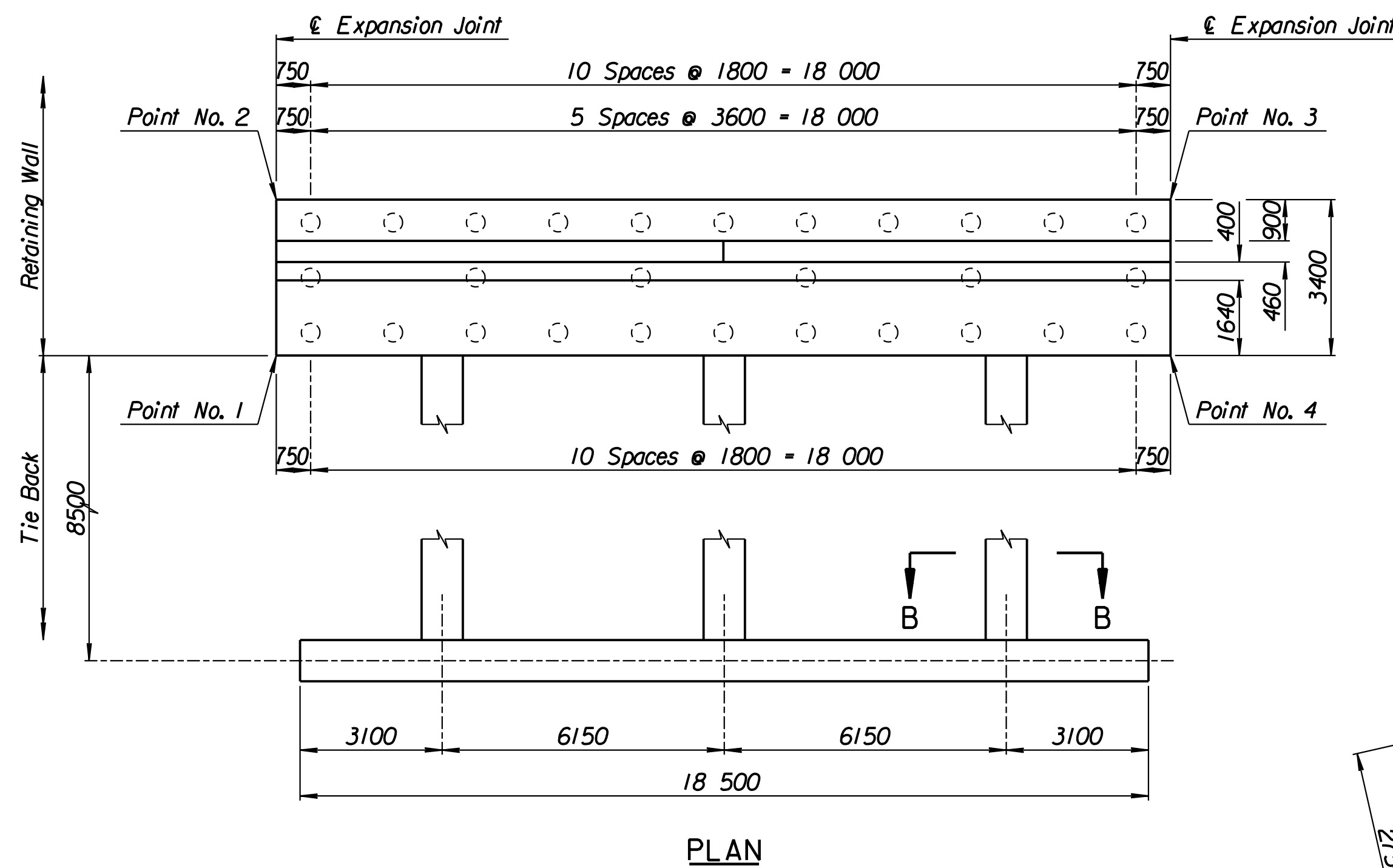
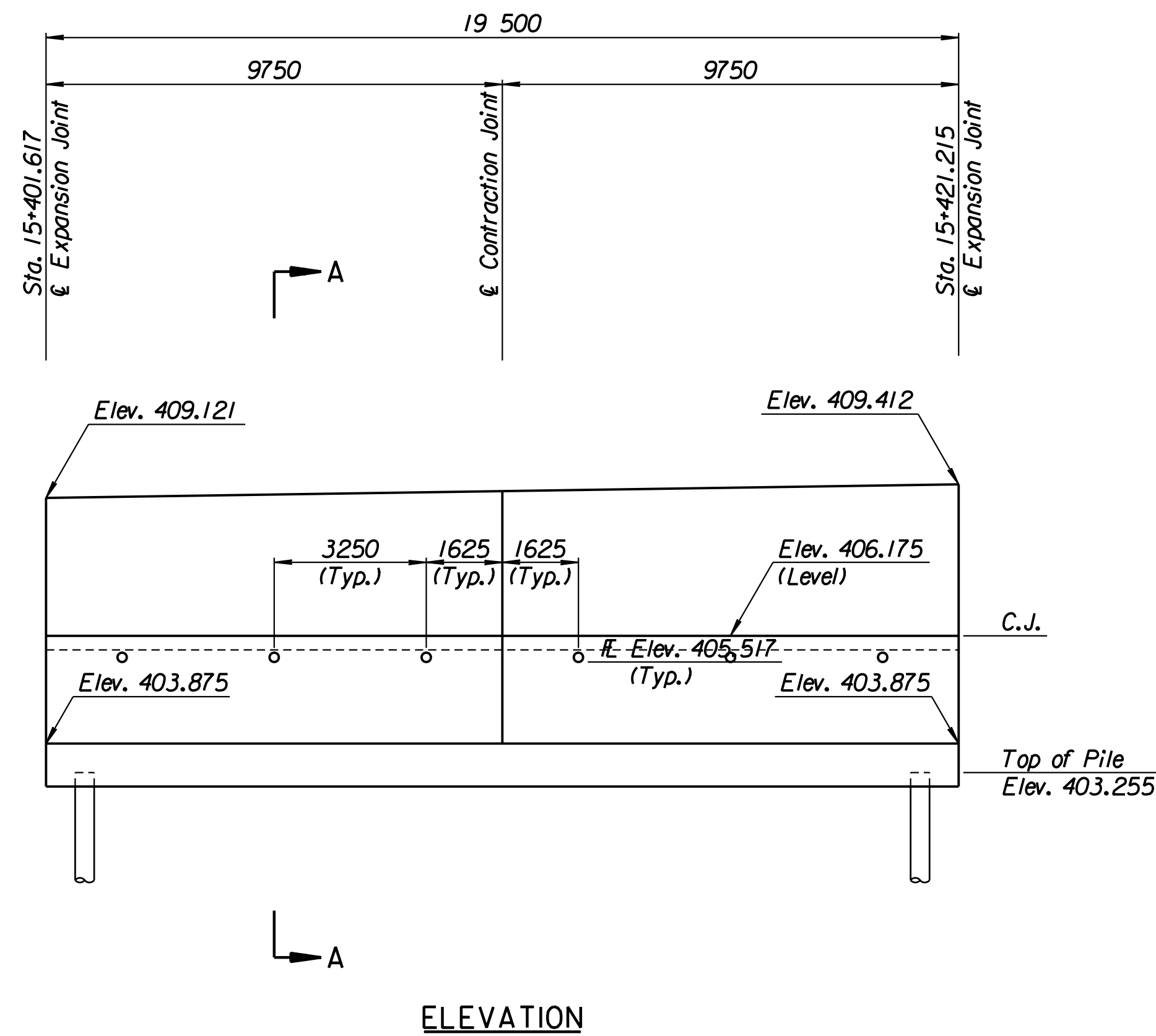

TIE BACK REINFORCING STEEL							
Straight Bars			Bent Bars				
Mark	Size	Number	Length	Mark	Size	Number	Length
FI-16	*25	28	10 170	FI-13	*13	81	2740
				FI-14	*29	36	9000
				FI-15	*13	63	4500

TIE BACK QUANTITIES		
Item	Quantity	Unit
Concrete (Grade 30)(AE)	38.5	m ³
Reinforcing Steel (Grade 420)	3273	kg

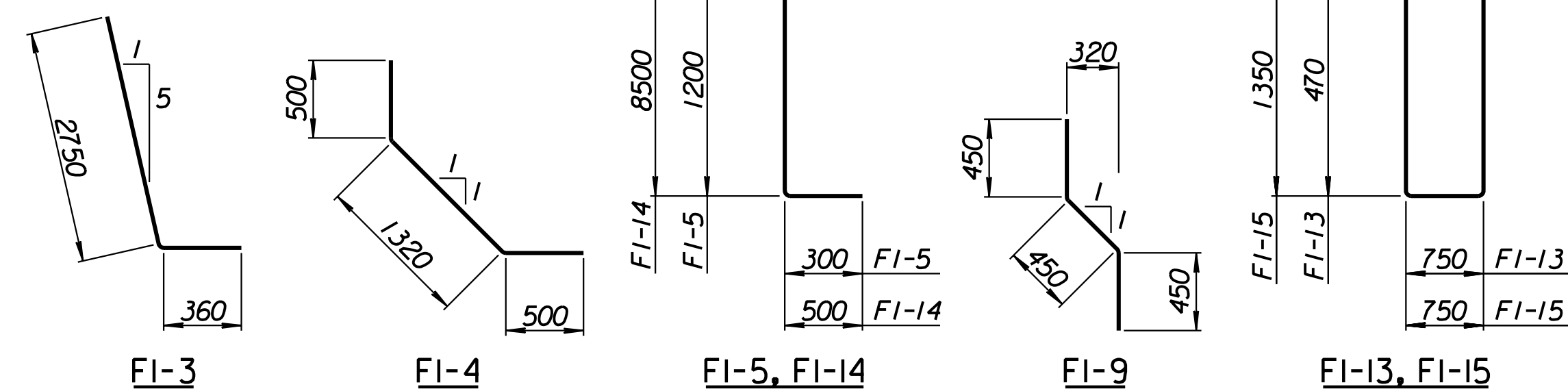
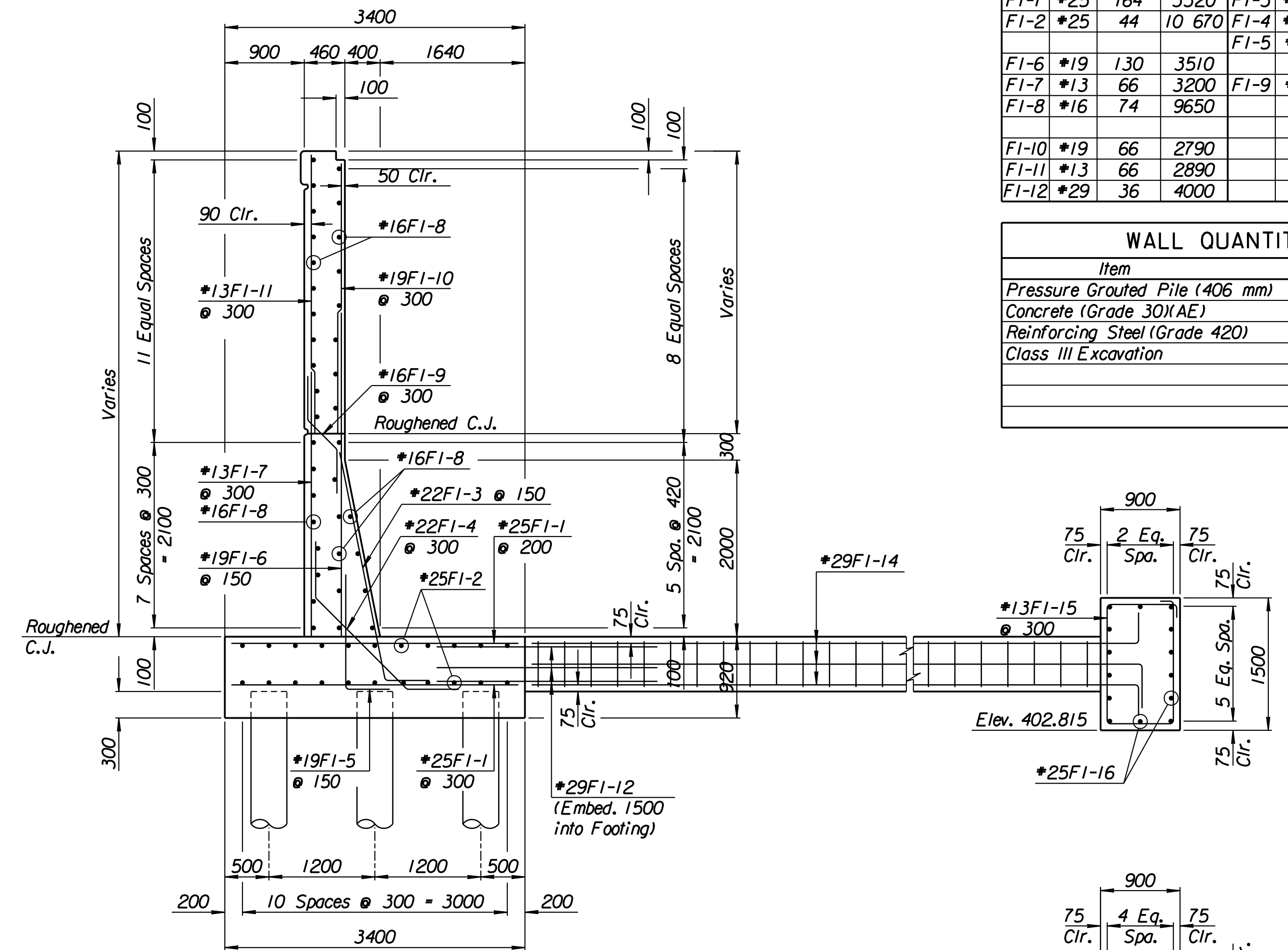

BENDING DIAGRAMS
All dimensions are out to out of bars.

RECORD DRAWING

1			
No.	Revisions	By	Date
CITY OF WICHITA			
MAIZE NORTHWEST WALL			
STA. 15+401.617 TO STA. 15+421.215			
SEDGWICK COUNTY			
Professional Engineering Consultants, P.A. 303 S. TOPEKA • WICHITA, KANSAS 67202 316-262-2691 • FAX 316-262-3003			
Designed by	P.D.F.	Checked by	R.A.S.
Drawn by	W.L.L.	Date	Apr. 2002
		Job No.	97362

Drawn by: wil
 Plotted by: drp
 3-25-2002
 1:1997/97362/As-Built/dgn/s/Vol 2/Sh 276-Maize-NWwall-6.dgn Last Rev: 8-22-07 By: gdr