

STATE	PROJECT NO.	YEAR	SHEET NO.	TOTAL SHEETS
KANSAS	54-87 K-6675-01	2002	412	1122

BY	DATE
REFERENCES NOTED	REFERENCES CHECKED

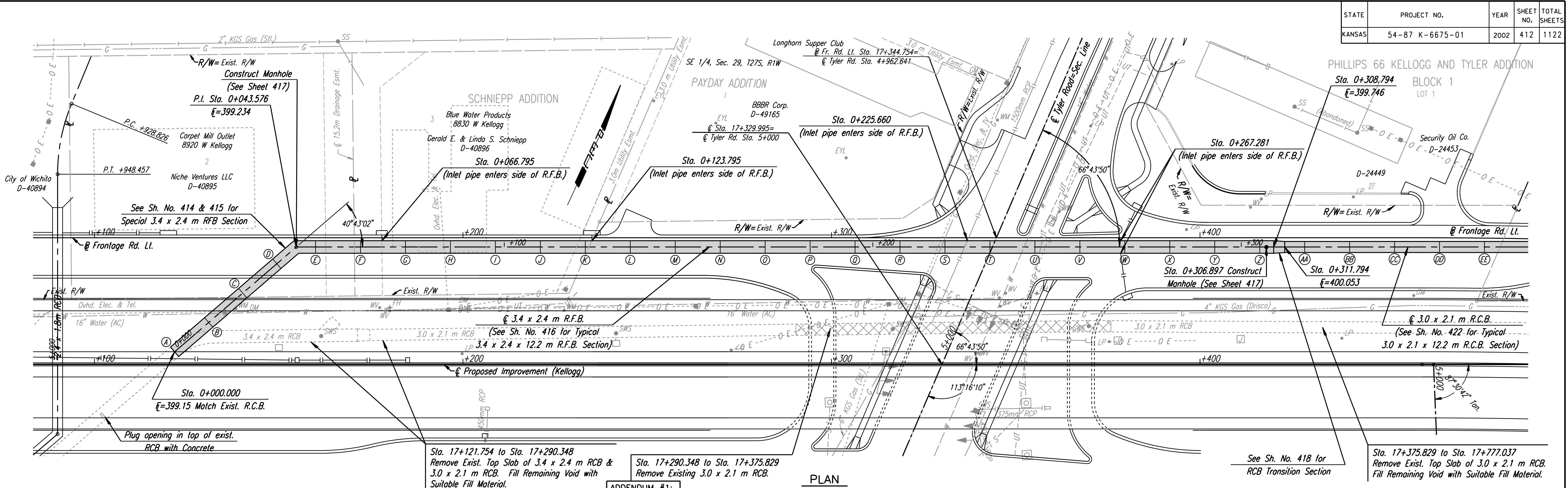

PLAN

ADDENDUM #1:
 Sheet 412 Add the following notes:
 1. The existing RCB shall be entirely removed where it conflicts with construction of the proposed RFB/RCB and the abutments and piers of the Tyler Road Bridge. The RCB may remain in place under Tyler Road where it does not conflict with proposed construction however, it shall be plugged and sand or grout filled using methods approved by the Engineer. All work associated with removal and/or abandonment of the existing RCB including tools, materials, excavation, backfilling, labor and incidentals necessary to complete the work, shall be included in the Lump Sum contract price for "Removal of Existing Structures".



PROFILE

RECORD DRAWING

PLAN AND PROFILE - 3.4 x 2.4 m R.F.B.

OPER: GDR SCALE: 1:500
 1/1997/97162/As-Built/dgn/NoL_2/54_412-RCB11.rdg Last Rev.: 8-28-07 By: gar