

STATE	PROJECT NO.	YEAR	SHEET NO.	TOTAL SHEETS
KANSAS	54-87 K-6657-01	2002	571	1122

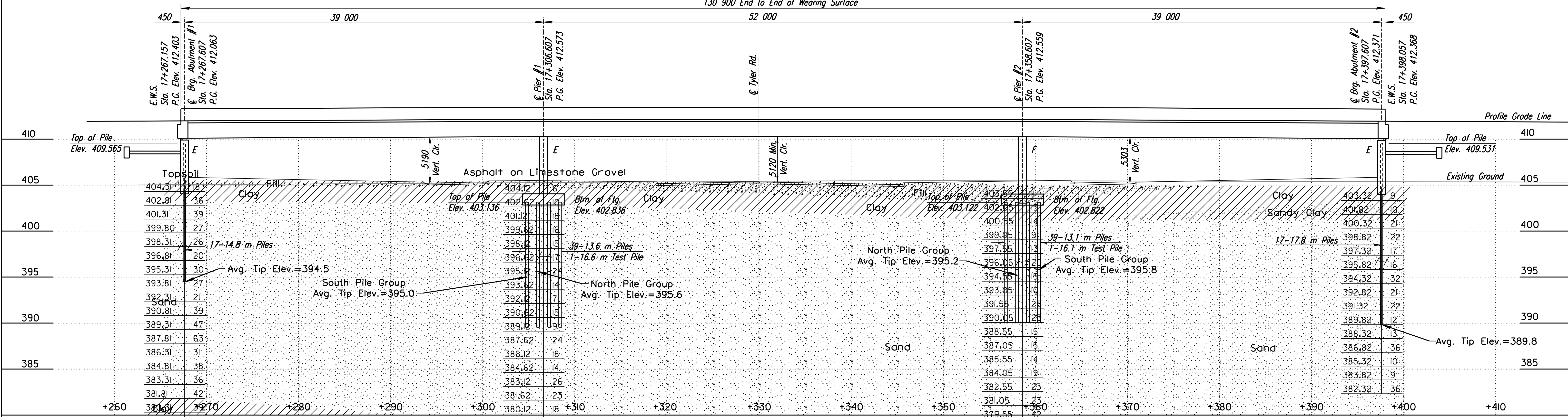

STANDARD GEOLOGIC SYMBOLS

SOUNDINGS

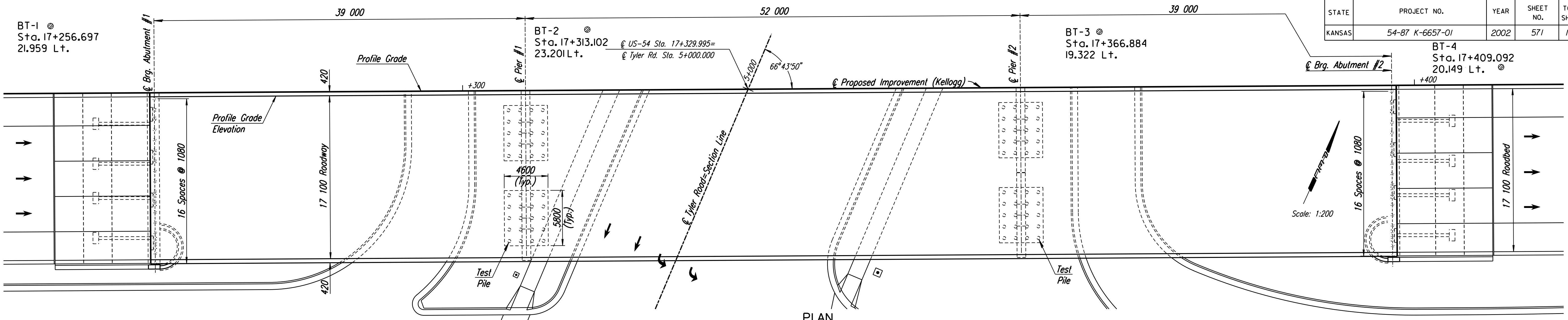
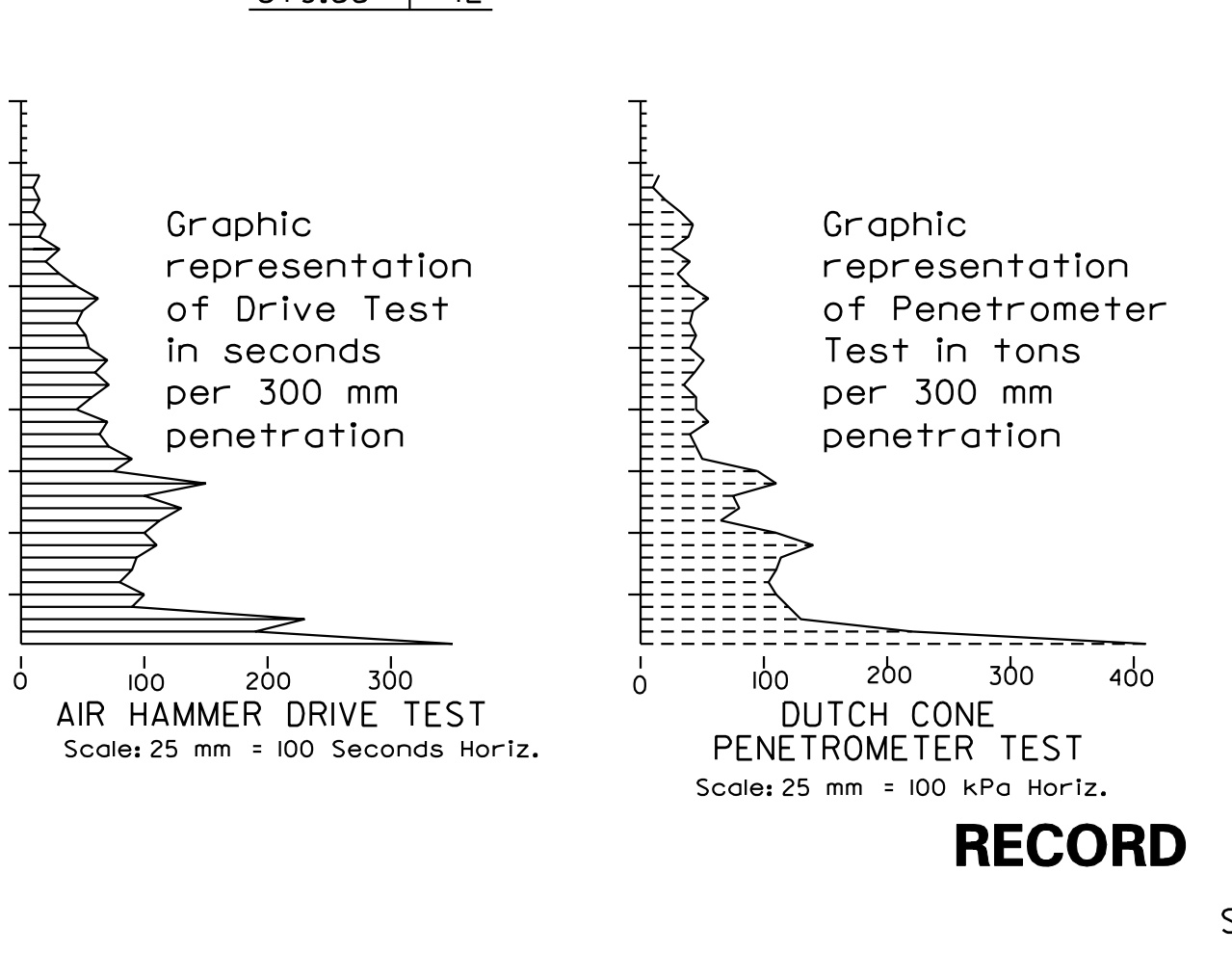

NOTE: The soundings shown on these plans are taken from notes obtained in the field and represent the best information available. The logs of these soundings are in the files of Allied Laboratories and are available at their offices at Wichita, Kansas for inspection by interested and qualified bidders.

Revisions		By	Date
CITY OF WICHITA BR. NO. 54-87-20.12 (497) E.B. Sta. 17+332.607			
ENGINEERING GEOLOGY KELLOGG (US-54) OVER TYLER RD. SEDGWICK COUNTY			
Professional Engineering Consultants, P.A.			
303 S. TOPEKA • WICHITA, KANSAS 67202 316-262-2691 • FAX 316-262-3003			
Designed by	P.D.F.	Checked by	R.A.S.
Drawn by	W.L.L.	Date	April, 2002
		Job No.	97362

RECORD DRAWING

SCALE: 1:200

i:\1997\97362\As-Builts\dgn\sh_571-geology.EB.dgn
 Last Rev: 9-6-07 By: gdr
 drawn by: will
 plotted by: gdr
 Sept. 07