

Scale = 1:1000

DATE	
BY	
REFERENCES NOTED	
REFERENCES CHECKED	

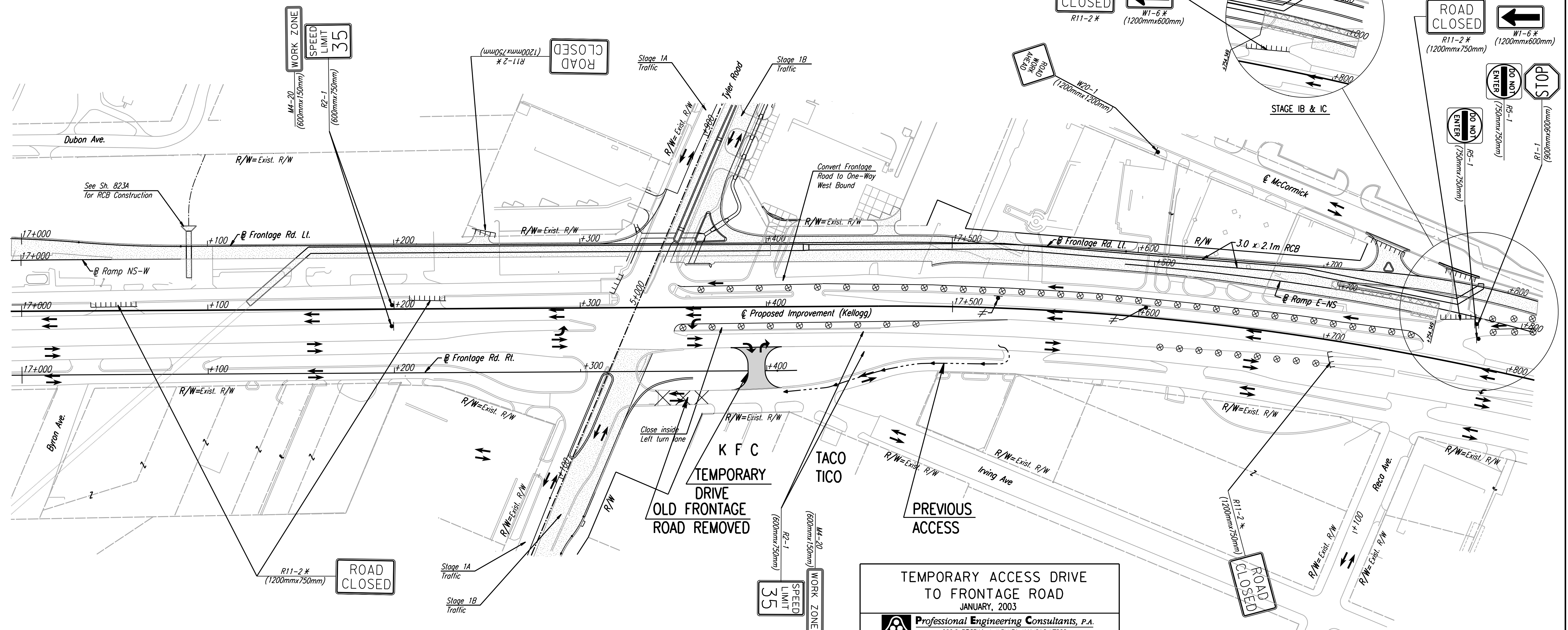

TEMPORARY ACCESS DRIVE TO FRONTAGE ROAD
 JANUARY, 2003
 Professional Engineering Consultants, P.A.
 303 S. TOPEKA • WICHITA, KANSAS 67202
 316-262-2691 • FAX 316-262-3003

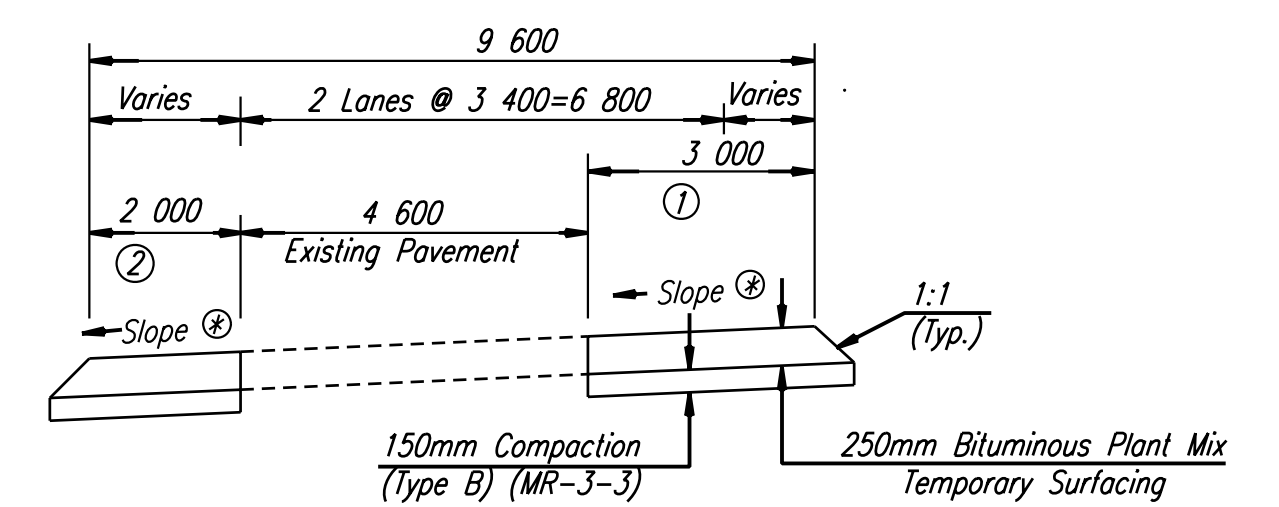

See Sh. Nos. 819-822 for Traffic Control on Tyler Rd.
 See Sheet Nos. 837 & 841 for Temporary Signal.

No.	Revisions	By	Date

CITY OF WICHITA
TRAFFIC CONTROL
STAGE IA, IB, & IC
STA. 17+000 TO STA. 17+800
 SEDGWICK COUNTY

Professional Engineering Consultants, P.A.
 303 S. TOPEKA • WICHITA, KANSAS 67202
 316-262-2691 • FAX 316-262-3003

Designed by	RPC, RWM	Checked by	WDH
Drawn by	JGP	Date	April, 2002
		Job No.	97362

DSWR: RCH OPER: JGP Scale: 1:1000
 1/1997/97362/As-Built.dgn's/vol 4/Sh 800-TC Stage 1a-pl170.dgn Last Rev: 10-4-07 By: gdr