

FHWA REGION NO.	STATE	PROJECT NO.	YEAR	SHEET NO.	TOTAL SHEETS
7	KANSAS	54-87 K-6657-01	2002	883	1122

Max L. Cole, et al
c/o Daniel M. Carney
D-38863

DATE	
BY	
REFERENCES NOTED	
REFERENCES CHECKED	

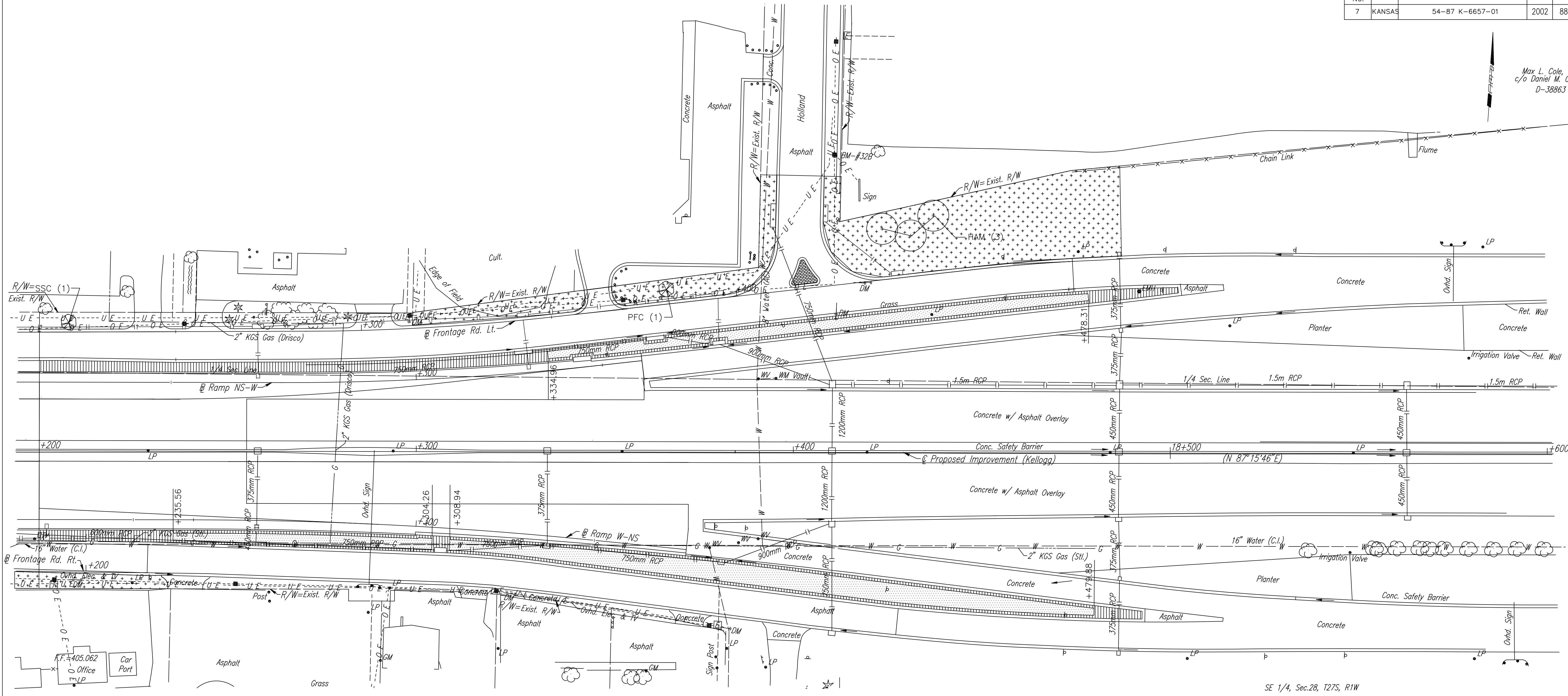

SE 1/4, Sec. 28, T27S, R1W

DSNR: OPER: DWR SCALE: 1:500
F/9934/15182



AS-BUILT DRAWINGS
THESE DOCUMENTS INCLUDE RECORD INFORMATION PROVIDED BY THE CONTRACTOR. THIS INFORMATION HAS NOT BEEN VERIFIED IN ITS ENTIRETY BY THE DESIGN PROFESSIONAL DATE: SEPTEMBER 2006

1			
No.	Revisions	By	Date
CITY OF WICHITA			
LANDSCAPE PLAN			
STA. 18+200 TO STA. 18+600			
SEDGWICK COUNTY			
Professional Engineering Consultants, P.A.			
303 S. TOPEKA • WICHITA, KANSAS 67202 316-262-2691 • FAX 316-262-3003			
Designed by	SMP	Checked by	
Drawn by	DWR	Date	April, 2002
		Job No.	97362