

FHWA REGION NO.	STATE	PROJECT NO.	YEAR	SHEET NO.	TOTAL SHEETS
7	KANSAS	54-87 K-6657-01	2002	706	1122

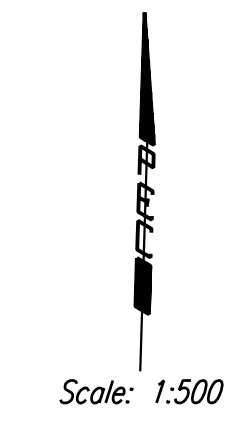

DATE	BY
REFERENCES NOTED	REFERENCES CHECKED

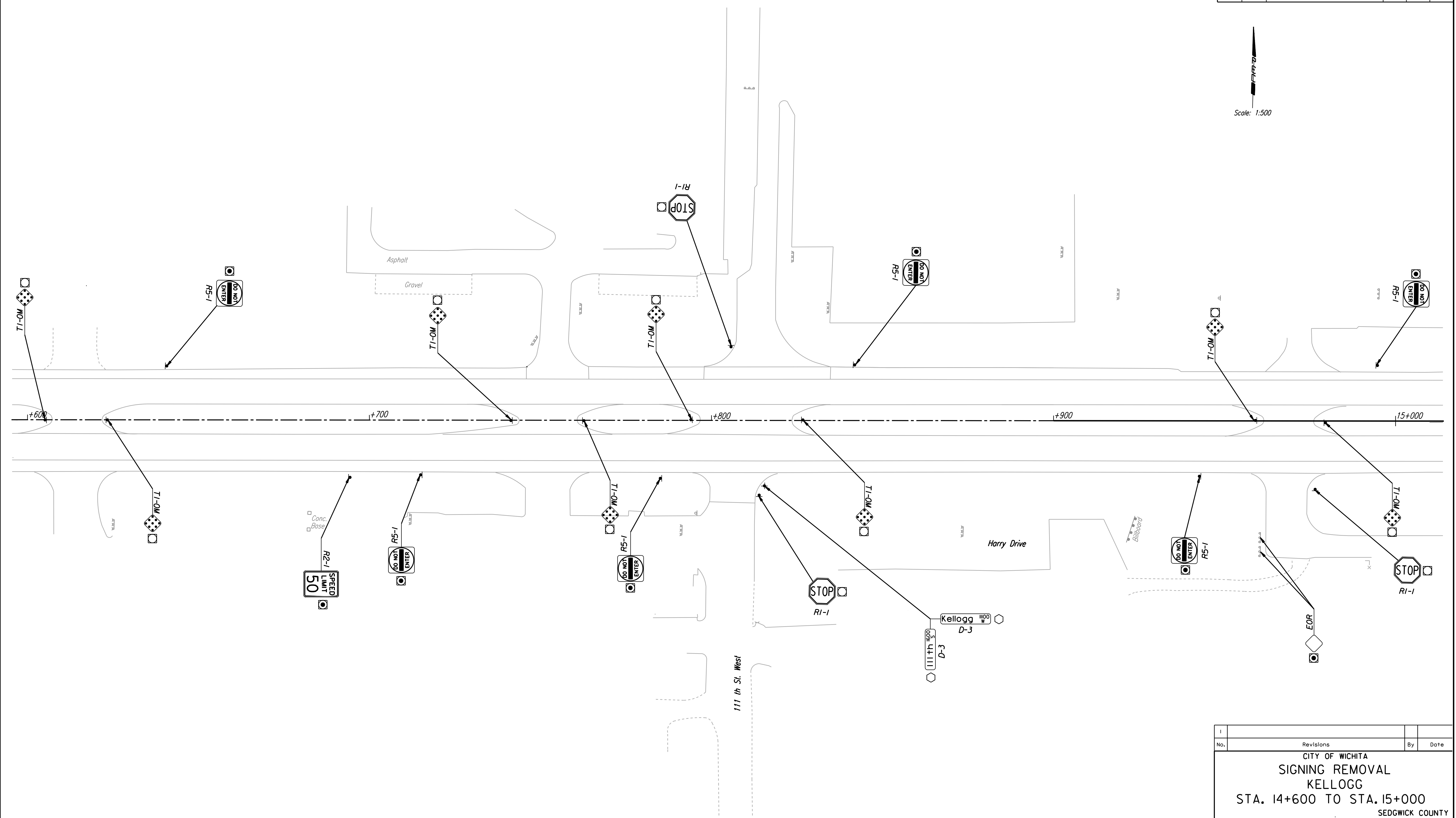

DSNR: WDH OPER: JGP SCALE: 1:500  
 I:\1997\97362\As-Builts\agnt's\Vol\_4\Sh 706-Sign\_Removal.plt\46.dgn Last Rev: 10-2-07 By: gdr

**RECORD DRAWING**

No.	Revisions	By	Date

CITY OF WICHITA  
 SIGNING REMOVAL  
 KELLOGG  
 STA. 14+600 TO STA. 15+000  
 SEDGWICK COUNTY

**Professional Engineering Consultants, P.A.**  
303 S. TOPEKA • WICHITA, KANSAS 67202  
 316-262-2691 • FAX 316-262-3003

Designed by	RPG	Checked by	WDH
Drawn by	JGP	Date	April, 2002
		Job No.	97362