

DATE	
BY	
REFERENCES NOTED	
REFERENCES CHECKED	

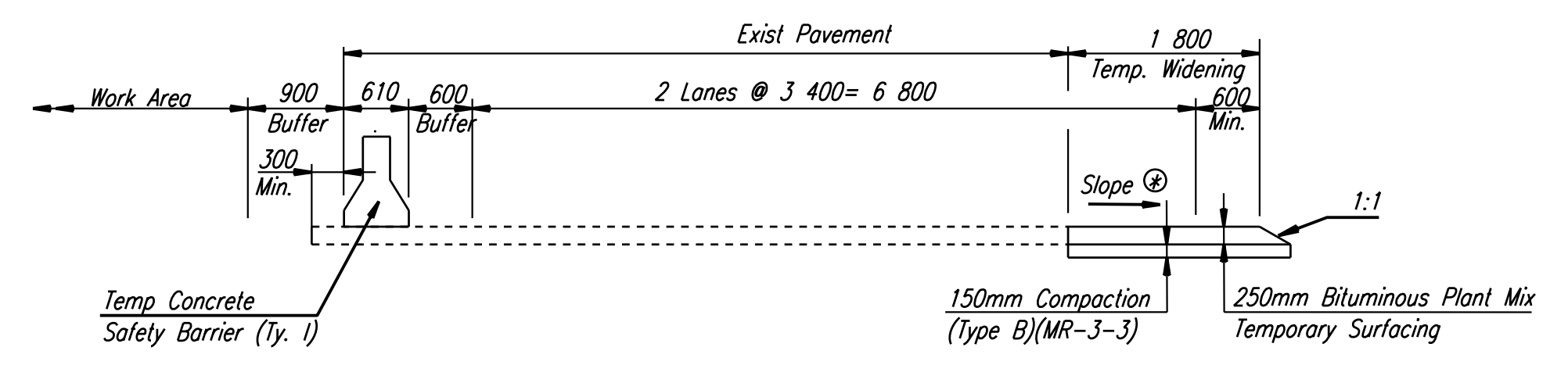
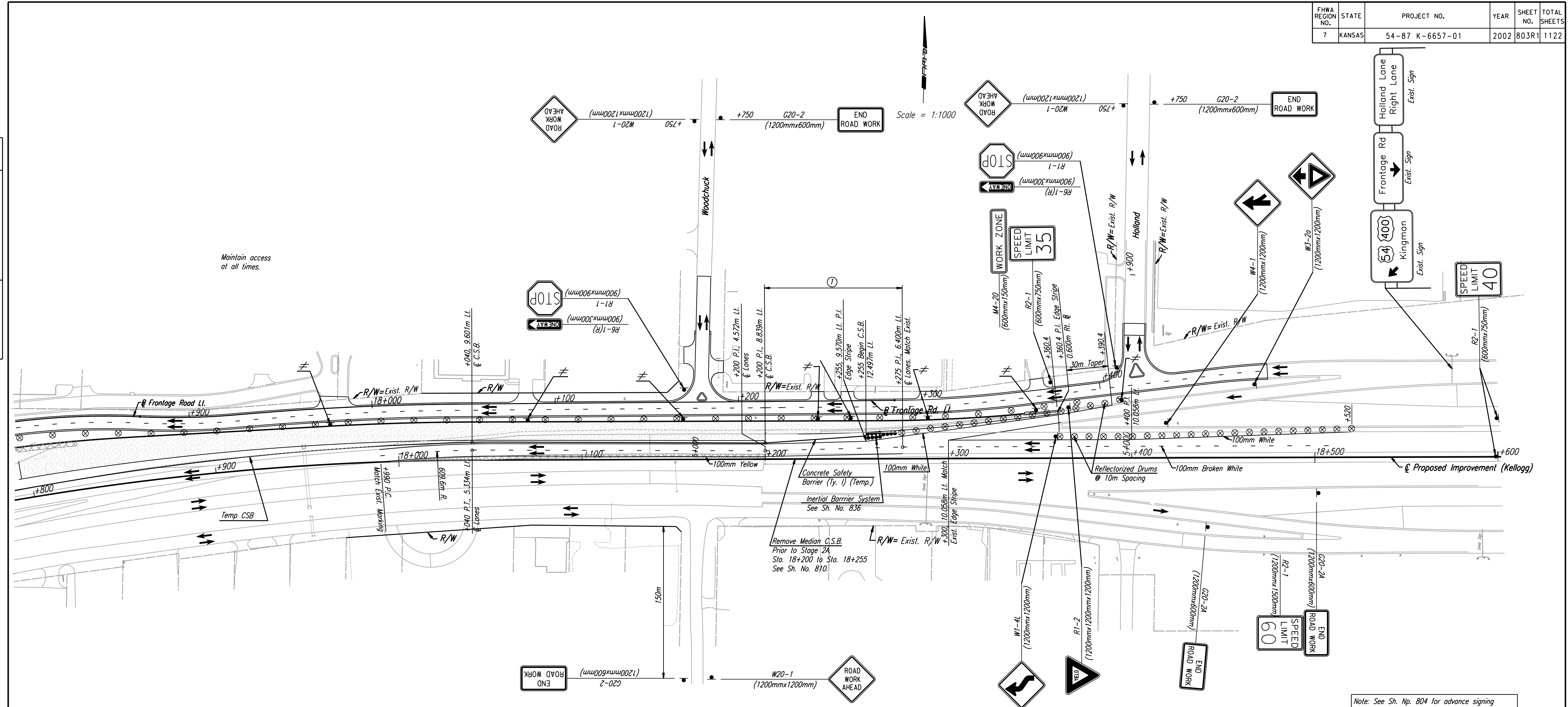

TYPICAL SECTION-PAVEMENT WIDENING  
Sta. 18+000 to Sta. 18+200  
② Match Existing Pavement Slope

Lane closure permitted during non-peak hours while constructing temporary widening. See Std. Sh. No. 833.

Note: See Sh. No. 804 for advance signing for W.B. Kellogg, Speed Limit for Stage 1C to be posted at 40 MPH.

① 75m Taper  
Transition from 3.6m Lanes @ Sta. 18+275 to 3.4m Lanes @ Sta. 18+200.

1	Revised Taper @ East End	WDH	1-16-03
No.	Revisions	By	Date
CITY OF WICHITA <b>TRAFFIC CONTROL</b> <b>STAGE 1C</b> <b>STA. 17+800 TO STA. 18+600</b> SEDGWICK COUNTY			
<b>Professional Engineering Consultants, P.A.</b> 303 S. TOPEKA • WICHITA, KANSAS 67202 316-262-2691 • FAX 316-262-3003			
Designed by	RPG, RWM	Checked by	WDH
Drawn by	JGP	Date	April, 2002
		Job No.	97362

DSWR: OPR: JGP Scale: 1:1000  
 11/1997/97362/As-Builts/dgns/Val 4/Sh 803-TC Stage 1c-pl/178rev.dgn Last Rev: 10-4-07 By: gdr