

Sta. 23+05 thru 26+95  
 Concrete Base (6 inch)  
 Commercial Asphalt Surface (2 inch)

Remove pavement, construct temporary pavement in overlay area.  
 Note: Permanent pavement will be installed with Street Project.

1. PRIOR TO CONSTRUCTION, THE CONTRACTOR SHALL EXCAVATE THE EXISTING 6" WATERLINE AT STA. 0+00 TO VERIFY PIPE SIZE HORIZONTAL AND VERTICAL LOCATION. ANY ADDITIONAL LABOR OR MATERIALS NECESSARY TO COMPLETE THE CONNECTION SHALL BE CONSIDERED SUBSIDIARY TO THE PROJECT.

NEW 1" WATER SERVICE AND SET SUMMARY					
NO.	BL STATION	LT./RT.	SERVICE (LONG OR SHORT)	METER SIZE	ADDRESS
1	23+84.50	LT.	SHORT	958	1303 N. BROADWAY
2	23+85.63	RT.	LONG	375	1302 N. BROADWAY
3	24+48.94	LT.	SHORT	425	1315 N. BROADWAY
4	25+15.15	RT.	LONG	ABANDON	DO NOT REPLACE
5	25+45.28	LT.	SHORT	2777	1321 N. BROADWAY

NEW 1" WATER SERVICE AND SET SUMMARY					
NO.	BL STATION	LT./RT.	SERVICE (LONG OR SHORT)	ACCOUNT	ADDRESS
6	26+29.77	LT.	SHORT	3153	1327 N. BROADWAY
7	26+45.47	LT.	SHORT	4943	1336 N. BROADWAY
8	27+80.59	LT.	SHORT	3385	1333 N. BROADWAY
9	28+36.03	LT.	SHORT	1532	1339 N. BROADWAY

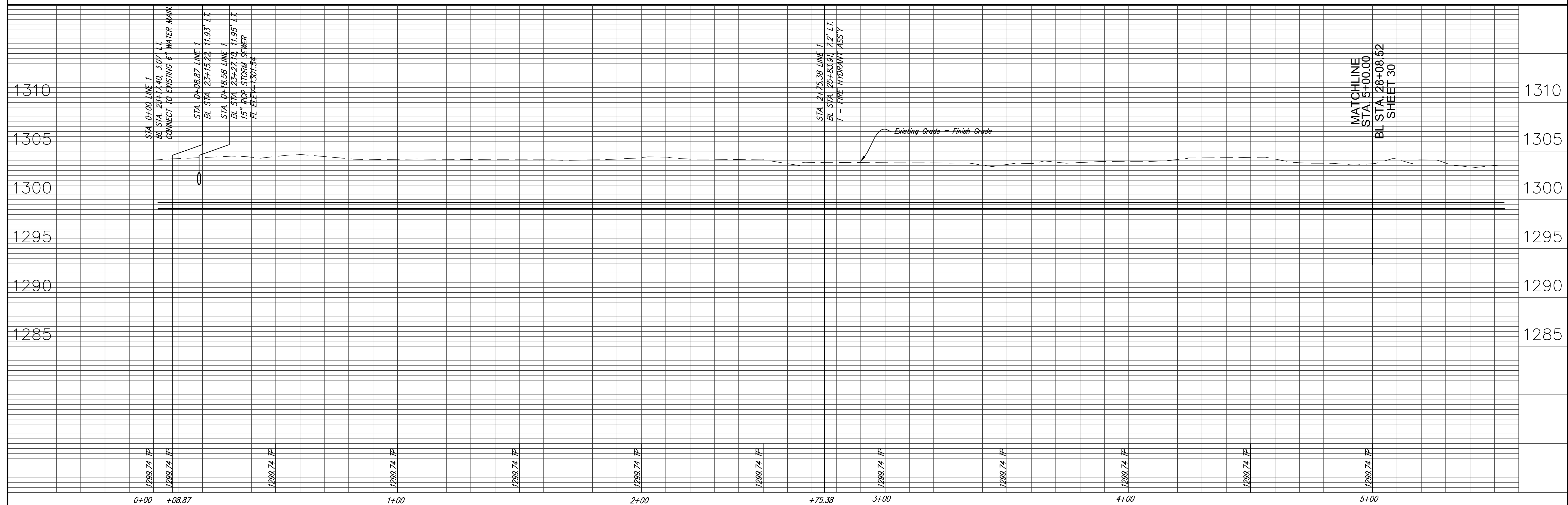
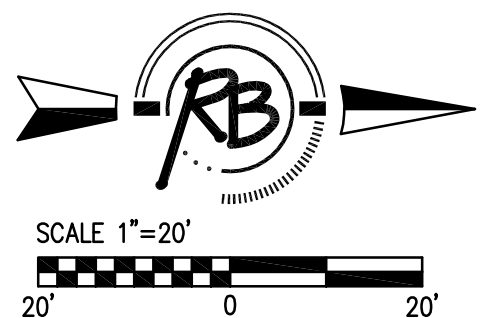

REVISED: 10/16/07

Ruggles & Bohm, P.A.  
 Engineering, Surveying, Land Planning  
 1010 N. Broadway, Suite 100  
 Wichita, Kansas 67202  
 Phone: 316.261.4000  
 Fax: 316.261.4001  
 Email: info@ruggles.com

DESIGN	PCD	UTILITY	DATE	REVIEW
PROJECT NUMBER	448-88345	DRAWING FILE	water cover Water P&P 1	

8" Water Main Replacement  
 WICHITA, KANSAS

RB JOB	1219W
SHEET	29
OF	55