

NEW 1" WATER SERVICE AND SET SUMMARY

NO.	BL STATION	LT./RT.	SERVICE (LONG OR SHORT)	ACCOUNT	ADDRESS
17	32+82.53	LT.	SHORT	46226	1421 N. BROADWAY
18	33+05.35	RT.	LONG	17243	1426 N. BROADWAY
18.5	33+06.35	RT.	LONG	17242	1426 N. BROADWAY
19	33+55.32	LT.	SHORT	15798	1428 N. BROADWAY
20	33+58.31	RT.	LONG	1337	1425 N. BROADWAY
21	34+08.61	RT.	SHORT	15799	1434 N. BROADWAY
22	34+32.02	LT.	LONG	ABANDON	DO NOT REPLACE
23	34+77.42	RT.	LONG	14367	1442 N. BROADWAY
24	34+11.38	LT.	SHORT	46376	1446 N. BROADWAY
25	35+36.30	RT.	LONG	80134	1451 N. BROADWAY
26	35+63.48	RT.	SHORT	15971	1450 N. BROADWAY
28	35+80.25	LT.	SHORT	2574	1459 N. BROADWAY
29	35+81.11	LT.	SHORT	72806	1457 N. BROADWAY
30	36+33.61	RT.	LONG	51406	1460 N. BROADWAY
21.5	34+09.61	RT.	LONG	101279	1436 N. BROADWAY

Sta. 33+00 thru 36+88
Concrete Base (6 inch)
Commercial Asphalt Surface (2 inch)

Remove pavement, construct temporary pavement in overlay area.
Note: Permanent pavement will be installed with Street Project.

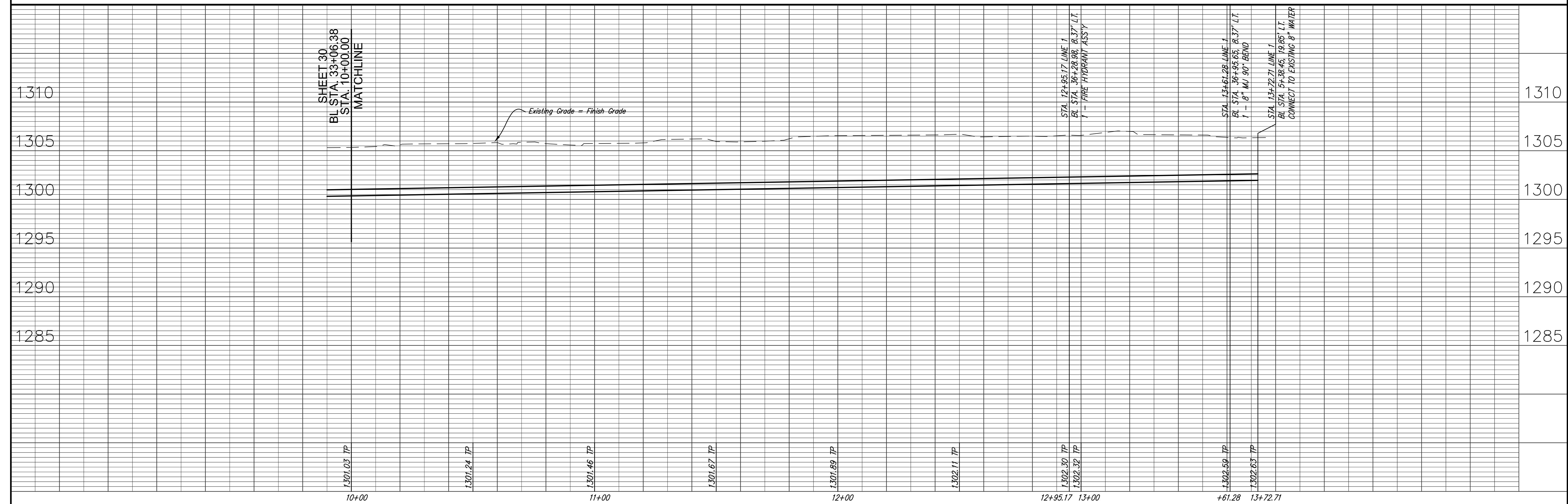

REVISION: 10/08/07

Ruggles & Bohm, P.A.
Engineering, Surveying, Land Planning
1010 West 10th St.
Wichita, Kansas 67202
www.rugglesandbohm.com



DESIGN PDC
DRAWN PDC
REVIEW PDC
DATE
Sept. 15, 2004

PROJECT NUMBER: 448-89345
DRAWING FILE: water cover Water P&P 3

8" Water Main Replacement
WICHITA, KANSAS

RB JOB: 1219W
SHEET: 31 OF 55