

FHWA REGION NO.	STATE	PROJECT NUMBER	FISCAL YEAR	SHEET NUMBER	TOTAL SHEETS
7	KANSAS	87N-0245-01	2007	32	55

ALL UTILITY LINES EXPOSED DURING CONSTRUCTION SHALL BE SUPPORTED WHILE EXPOSED. METHOD TO BE APPROVED BY FIELD ENGINEER.

STA. 0+00.00 LINE 1
 STA. 0+51.50 LINE 2
 BL STA. 3+23.04, 17.93' LT.
 REMOVE EXISTING MANHOLE.
 CONSTRUCT SPECIAL SHALLOW TYPE 'P' MANHOLE.
 TOP ELEV = 1304.47
 FLOWLINE NORTH = 1299.45
 FLOWLINE SOUTH = 1299.45
 FLOWLINE EAST = 1299.49
 FLOWLINE WEST = 1299.50

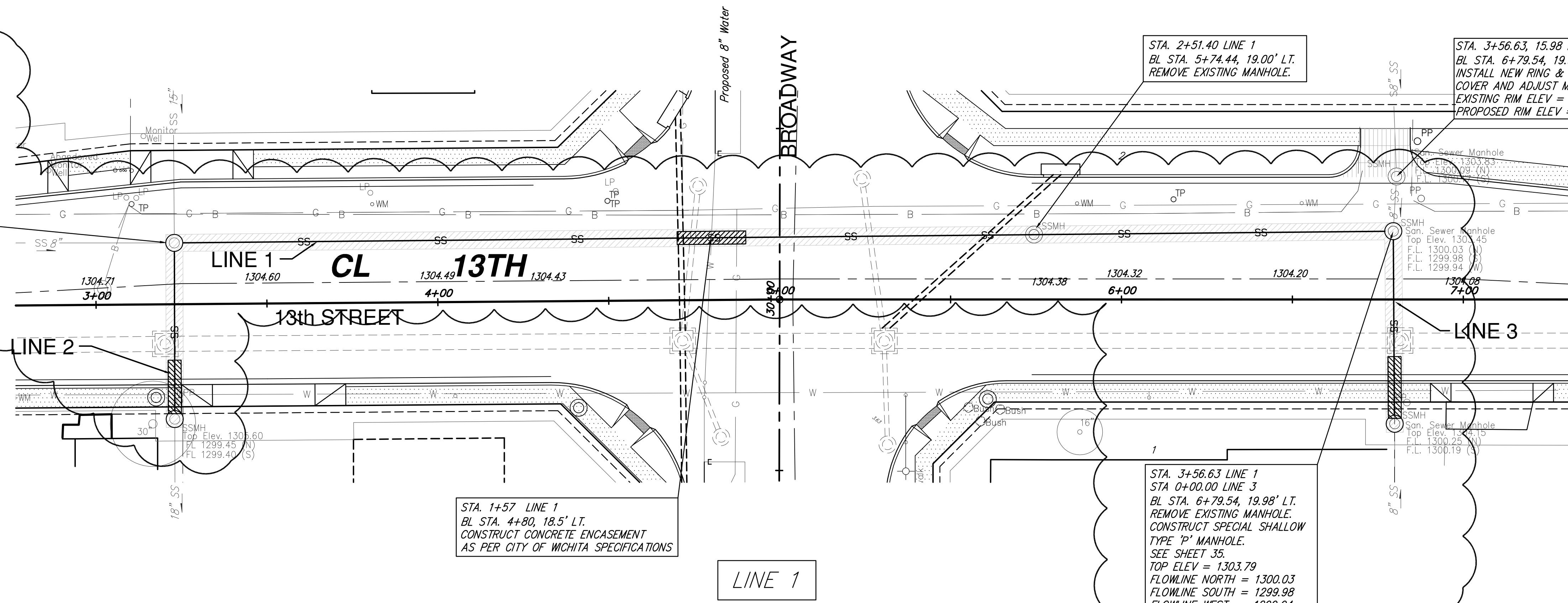

Remove pavement, construct temporary pavement.
 Note: Permanent pavement will be installed with Street Project.

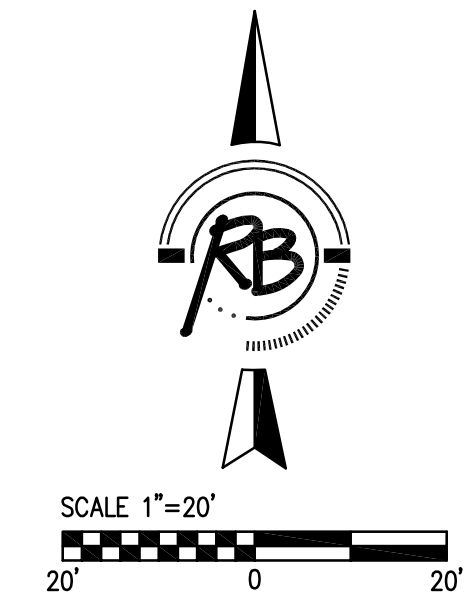

REVISED: 12/14/07

Kuegel & Bohm, P.A.
 Engineering, Surveying, Land Planning
 525 North Main
 Wichita, Kansas 67203
 Phone: 316.262.0008
 Fax: 316.262.0009
 Email: k&b@kuegel.com

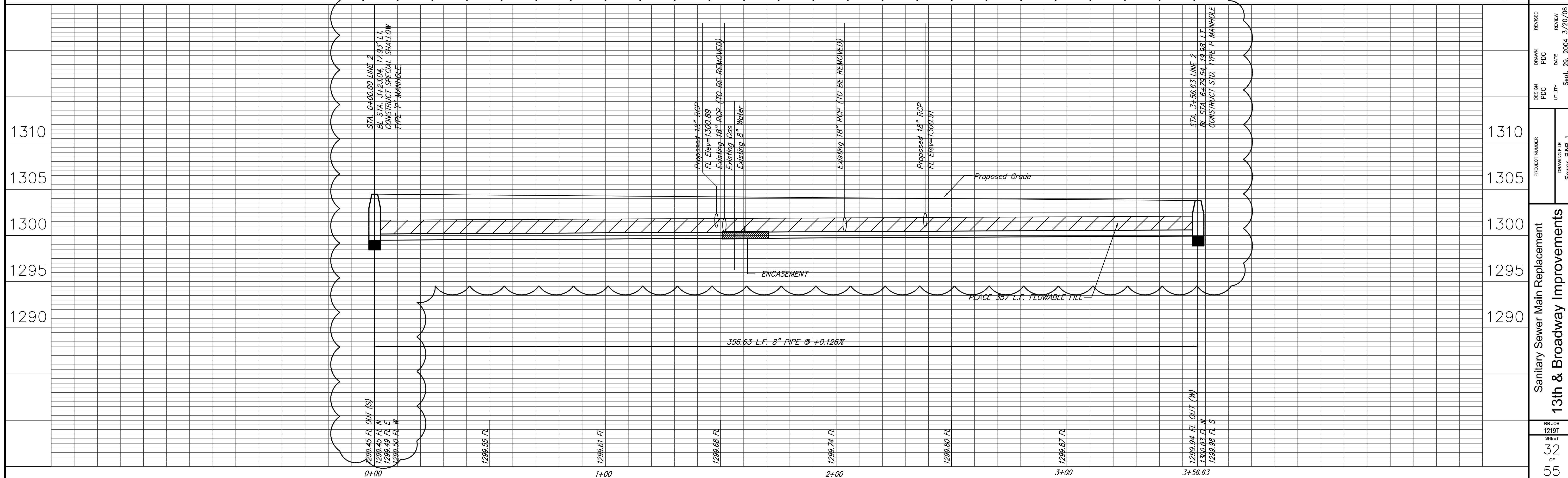

PROJECT NUMBER	Sanitary Sewer Main Replacement 13th & Broadway Improvements
DRAWING FILE	Sewer P&P 1
DESIGN	PDC
REVISION	PDC
DATE	Sept. 29, 2004
REVIEW	3/20/06