

BENCHMARKS:
 BM #1: "C" Cut on Top of Curb at West Line of Lot 7, Block A, Auburn Hills 5th Addition. Elev. = 207.73 (City Datum)

BM #2: Disc in Back of Curb, North of Front Corner Common to Lots 23 and 24, Block D, Auburn Hills 12th Addition. Elev. = 191.84 (City Datum)

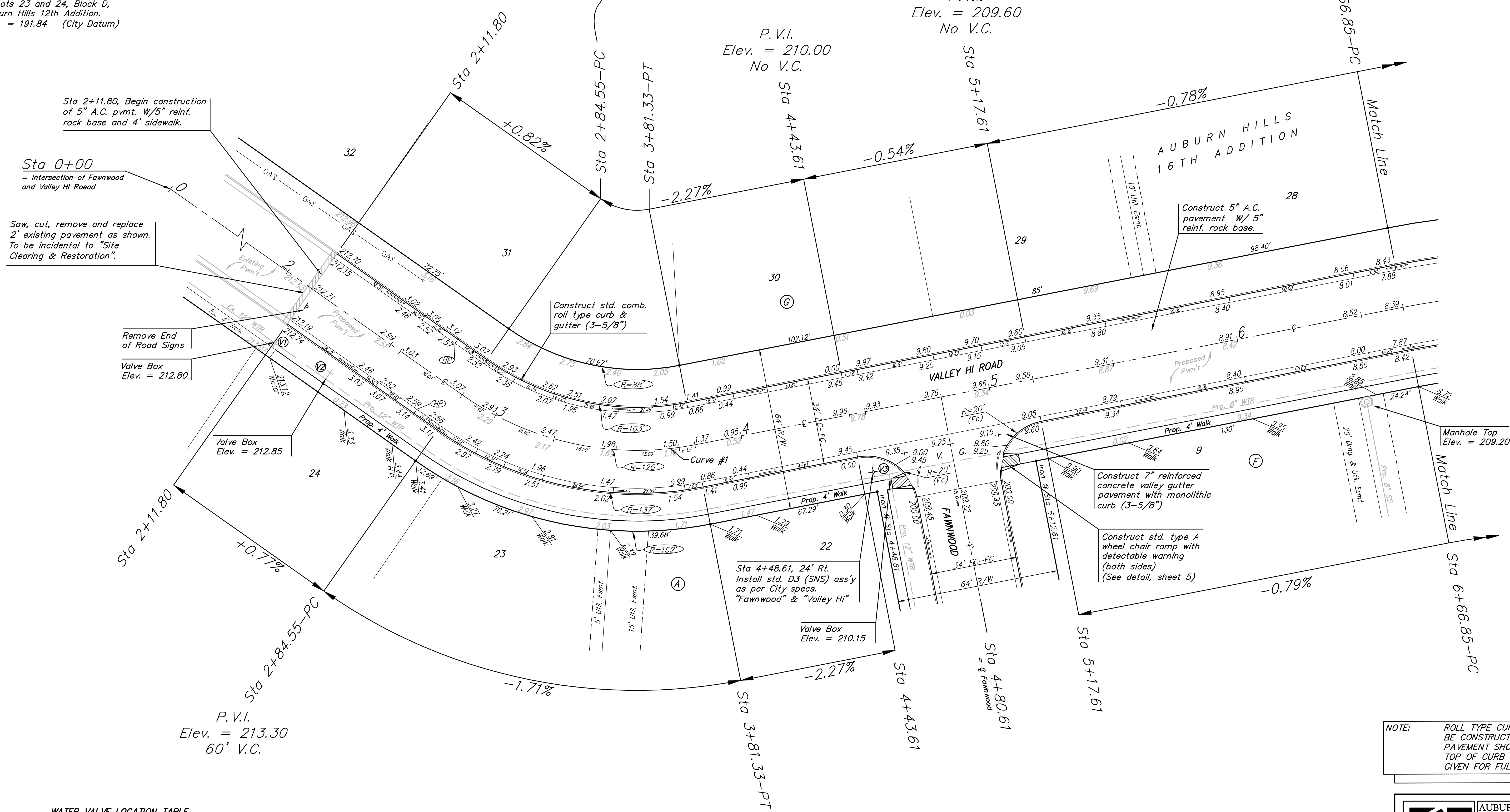
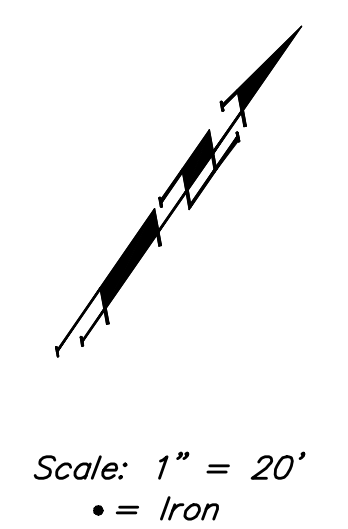

Sta 2+11.80, Begin construction of 5" A.C. pmt. W/5" reinf. rock base and 4' sidewalk.

Sta 0+00 = Intersection of Fawnwood and Valley Hi Road

Saw, cut, remove and replace 2' existing pavement as shown. To be incidental to "Site Clearing & Restoration".

Remove End of Road Signs
 Valve Box Elev. = 212.80

Valve Box Elev. = 212.85

P.V.I. Elev. = 213.30
 60' V.C.

P.V.I. Elev. = 211.41
 No V.C.

NOTE: ROLL TYPE CURB & GUTTER TO BE CONSTRUCTED ON THE PAVEMENT SHOWN ON THIS SHEET. TOP OF CURB ELEVATIONS ARE GIVEN FOR FULL HEIGHT CURB.

WATER VALVE LOCATION TABLE

VALVE NUMBER	BASELINE STATION	OFFSET DISTANCE	OFFSET DIRECTION
V1	2+12.44	26'	Rt.
V2	2+36.80	26'	Rt.
V3	4+54.61	26'	Rt.

Paving contractor will be responsible to operate all water valves on the project, in the presence of the inspector, to ensure accessibility to the valves, and that all valves are left in the "ON" position when the project is completed.

Trees and shrubs in public right-of-way which are in direct conflict with proposed new construction shall be removed by the Contractor ONLY with the Developer or Baughman Company approval. Trees and shrubs which are not in direct conflict with proposed new construction shall be saved and protected from damage.

Curve #1
 Curve Data Based on Centerline
 Rad. = 120' Delta = 46°12'21" Tangent = 51.19'
 Arc = 96.78' L.C. = 94.17' Def./Ft. = 14.32295 Min.

Station	Arc	Face Chord Lengths		Defl.	Total Defl.
		8' Left	8' Right		
2+84.55	-	-	-	0°00'00"	0°00'00"
3+00.00	15.45'	12.22'	18.65'	3°41'17"	3°41'17"
3+25.00	25.00'	19.75'	30.15'	5°58'05"	9°39'22"
3+50.00	25.00'	19.75'	30.15'	5°58'04"	15°37'26"
3+75.00	25.00'	19.75'	30.15'	5°58'05"	21°35'31"
3+81.33	6.33'	5.01'	7.65'	1°30'39"	23°06'10"

Baughman AUBURN HILLS 16TH ADD. - PH. III
VALLEY HI ROAD
 Sta 2+11.80 to Sta 6+66.85

Baughman Company, P.A. 315 Ellis St. Wichita, KS 67211 P 316-262-7271 F 316-262-0149
 ENGINEERING | SURVEYING | PLANNING | LANDSCAPE ARCHITECTURE

PROJECT NUMBER: 47284292
 DESIGN: AEG DRAWN: JRW
 APPROVED: AEG DATE: 12-05-07

REVISIONS:

SCALE: Noted
 SHEET: 7 OF 52

AuburnHills16th\Phase3\Str1 07-09-E928