

BENCHMARKS:
 BM #1: "C" Cut on Top of Curb at West Line of Lot 7, Block A, Auburn Hills 5th Addition. Elev. = 207.73 (City Datum)

BM #2: Disc in Back of Curb, North of Front Corner Common to Lots 23 and 24, Block D, Auburn Hills 12th Addition. Elev. = 191.84 (City Datum)

Scale: 1" = 20'
 • = Iron

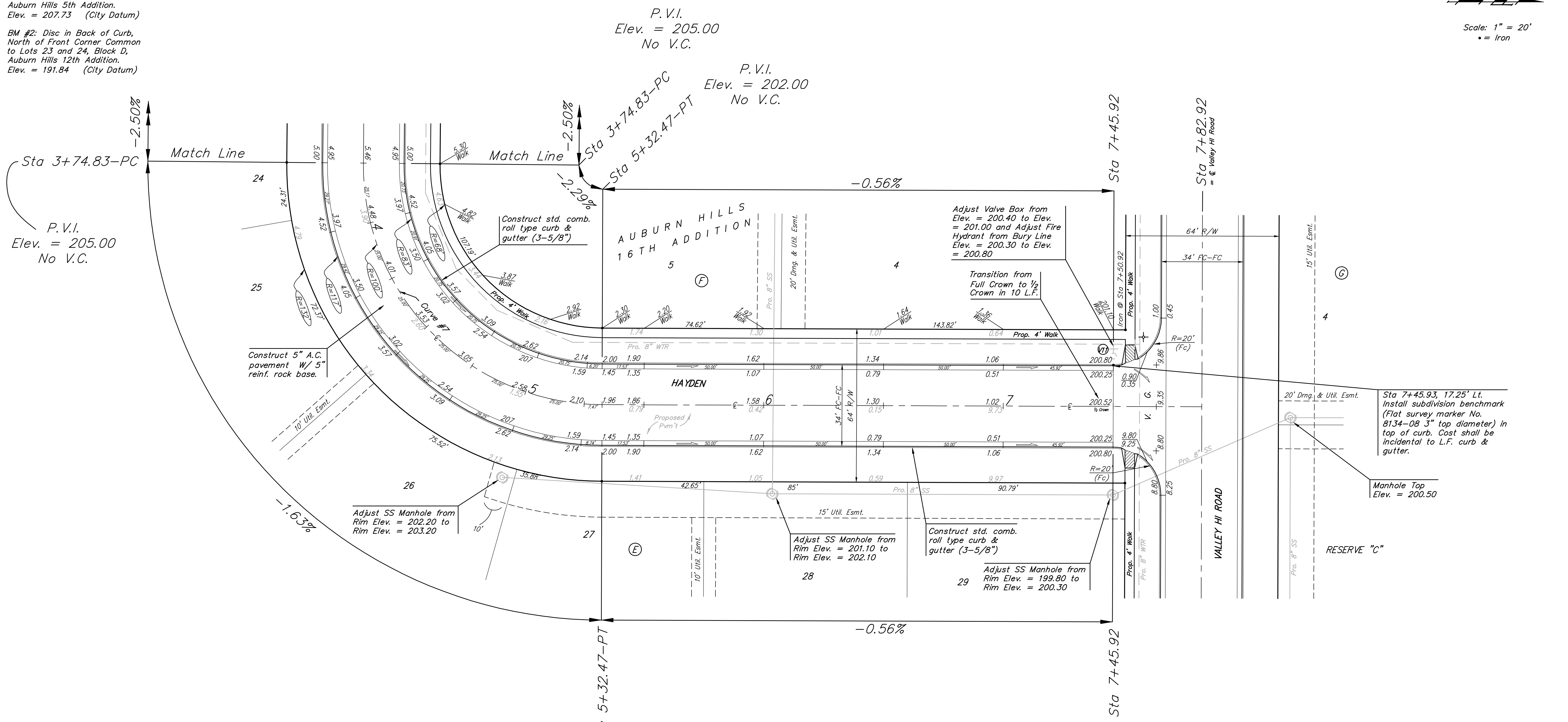

P.V.I.
 Elev. = 205.00
 No V.C.

P.V.I.
 Elev. = 205.00
 No V.C.

P.V.I.
 Elev. = 202.00
 No V.C.

P.V.I.
 Elev. = 202.00
 No V.C.

NOTE: ROLL TYPE CURB & GUTTER TO BE CONSTRUCTED ON THE PAVEMENT SHOWN ON THIS SHEET. TOP OF CURB ELEVATIONS ARE GIVEN FOR FULL HEIGHT CURB.

Curve #7

Curve Data Based on Centerline
 Rad. = 100' Delta = 90°19'11" Tangent = 100.56'
 Arc = 157.64' L.C. = 141.82' Def./Ft. = 17.18848 Min.

| Station | Arc | Face Chord Lengths | | Defl. | Total Defl. |
|---------|--------|--------------------|----------|-----------|-------------|
| | | 8' Left | 8' Right | | |
| 3+74.83 | - | - | - | 0'00"00" | 0'00"00" |
| 3+75.00 | 0.17" | 0.13" | 0.21" | 0'02"55" | 0'02"55" |
| 4+00.00 | 25.00' | 18.70' | 31.17' | 7'09"43" | 7'12"38" |
| 4+25.00 | 25.00' | 18.70' | 31.17' | 7'09"43" | 14'22"21" |
| 4+50.00 | 25.00' | 18.70' | 31.17' | 7'09"42" | 21'32"03" |
| 5+00.00 | 50.00' | 37.11' | 61.85' | 14'19"26" | 35'51"29" |
| 5+25.00 | 25.00' | 18.70' | 31.17' | 7'09"43" | 43'01"12" |
| 5+32.47 | 7.47' | 5.60' | 9.34' | 2'08"24" | 45'09"36" |

Trees and shrubs in public right-of-way which are in direct conflict with proposed new construction shall be removed by the Contractor ONLY with the Developer or Baughman Company approval. Trees and shrubs which are not in direct conflict with proposed new construction shall be saved and protected from damage.

WATER VALVE LOCATION TABLE

| VALVE NUMBER | BASELINE STATION | OFFSET DISTANCE | OFFSET DIRECTION |
|--------------|------------------|-----------------|------------------|
| V11 | 7+75.92 | 35' | Lt. |

Paving contractor will be responsible to operate all water valves on the project, in the presence of the inspector, to ensure accessibility to the valves, and that all valves are left in the "ON" position when the project is completed.

Baughman HAYDEN
 Auburn Hills 16th Add. - PH. III
 Sta 3+74.83 to Sta 7+82.92

Baughman Company, P.A. 315 Ellis St. Wichita, KS 67211 P 316-262-7271 F 316-262-0149
 ENGINEERING | SURVEYING | PLANNING | LANDSCAPE ARCHITECTURE

PROJECT NUMBER: 41284292
 DESIGN: AEG DRAWN: JRW
 APPROVED: AEG DATE: 12-05-07
 SCALE: Noted
 SHEET: 11 OF 52

AuburnHills16th\Phase3\Sr1 07-09-E928