

**BENCHMARKS:**  
 BM #1: "C" Cut on Top of Curb at West Line of Lot 7, Block A, Auburn Hills 5th Addition. Elev. = 207.73 (City Datum)

BM #2: Disc in Back of Curb, North of Front Corner Common to Lots 23 and 24, Block D, Auburn Hills 12th Addition. Elev. = 191.84 (City Datum)

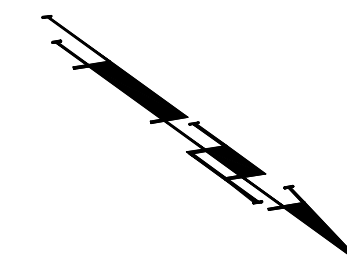

Scale: 1" = 20'  
 • = Iron

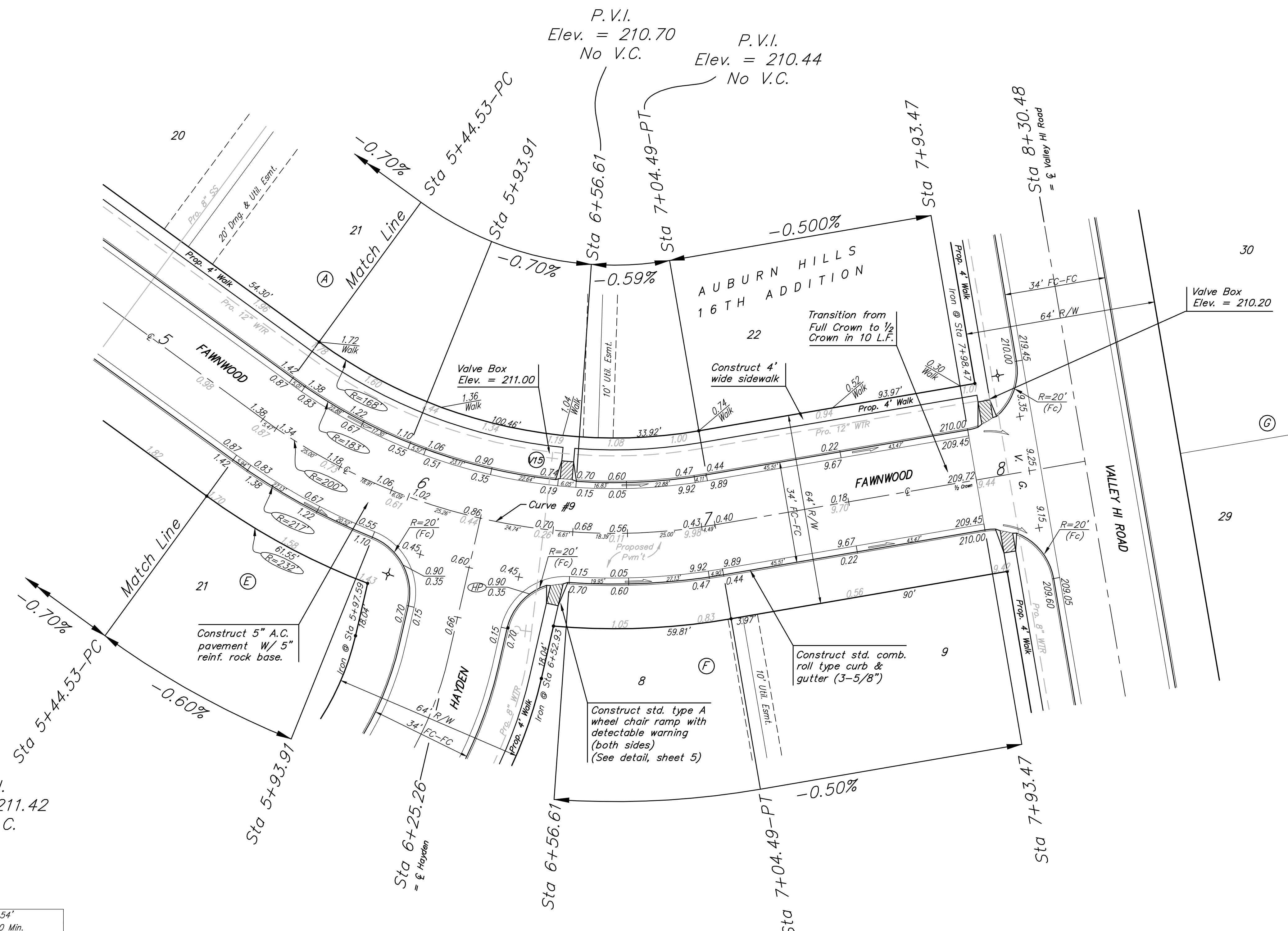

P.V.I.  
 Elev. = 211.42  
 No V.C.

Curve #9  
 Curve Data Based on Centerline

Rad. = 200' Delta = 45°49'39" Tangent = 84.54'  
 Arc = 159.96' L.C. = 155.74' Def./Ft. = 8.59480 Min.

Station	Arc	Face Chord Lengths		Defl.	Total Defl.
		8' Left	8' Right		
5+44.53	-	-	-	0°00'00"	0°00'00"
5+50.00	5.47'	4.79'	6.15'	0°47'01"	0°47'01"
5+75.00	25.00'	21.86'	28.11'	3°34'52"	4°21'53"
5+93.91	18.91'	16.54'	21.27'	2°42'32"	7°04'25"
6+00.00	6.09'	5.33'	6.85'	0°52'20"	7°56'45"
6+25.26	25.26'	22.09'	28.40'	3°37'07"	11°33'52"
6+50.00	24.74'	21.63'	27.82'	3°32'38"	15°06'30"
6+56.61	6.61'	5.78'	7.44'	0°56'48"	16°03'18"
6+75.00	18.39'	16.09'	20.68'	2°38'04"	18°41'22"
7+00.00	25.00'	21.86'	28.11'	3°34'52"	22°16'14"
7+04.49	4.49'	3.93'	5.05'	0°38'36"	22°54'50"

Trees and shrubs in public right-of-way which are in direct conflict with proposed new construction shall be removed by the Contractor ONLY with the Developer or Baughman Company approval. Trees and shrubs which are not in direct conflict with proposed new construction shall be saved and protected from damage.

**WATER VALVE LOCATION TABLE**

VALVE NUMBER	BASELINE STATION	OFFSET DISTANCE	OFFSET DIRECTION
V15	6+46.80	26'	Lt.

Paving contractor will be responsible to operate all water valves on the project, in the presence of the inspector, to ensure accessibility to the valves, and that all valves are left in the "ON" position when the project is completed.

NOTE: ROLL TYPE CURB & GUTTER TO BE CONSTRUCTED ON THE PAVEMENT SHOWN ON THIS SHEET. TOP OF CURB ELEVATIONS ARE GIVEN FOR FULL HEIGHT CURB.

	<b>AUBURN HILLS 16TH ADD. - PH. III</b> <b>FAWNWOOD</b> Sta 5+44.53 to Sta 8+30.48	
	<small>Baughman Company, P.A. 315 Ellis St., Wichita, KS 67211 P 316-262-7271 F 316-262-0149          ENGINEERING   SURVEYING   PLANNING   LANDSCAPE ARCHITECTURE</small>	
PROJECT NUMBER <b>47284292</b>	DESIGN AEG	DRAWN JRW
REVISIONS:	APPROVED AEG	DATE 12-05-07
SCALE Noted		SHEET <b>13 OF 52</b>
<small>AuburnHills16th\Phase3\Str1</small>		<small>07-09-E928</small>