

**RECORD DRAWING**  
1/9/2008 MLT

**CURVE TABLE BASED ON CL RADIUS**

STATION	CL	CHORD LENGTH	R.T. DEFLECTION	TOTAL DEFLECTION
0+98.23 P.C.	1.77	1.17	1.77	0.5549°
1+00.00	0.00	0.00	0.00	0.5549°
1+25.00	25.00	16.37	24.78	1.3528°
1+41.64 P.T.	16.64	10.95	16.58	2.2498°
DEFLECTION/FOOT = 0.325649353 DEGREES				

**CURVE TABLE BASED ON CL RADIUS**

STATION	CL	CHORD LENGTH	R.T. DEFLECTION	TOTAL DEFLECTION
2+87.48 P.C.	12.82	9.40	12.51	4.4854°
3+00.00	0.00	0.00	0.00	4.4854°
3+28.00	25.00	18.70	24.88	9.5653°
3+45.37 P.T.	20.57	15.41	20.50	14.2547°
DEFLECTION/FOOT = 0.384587055 DEGREES				

**CURVE TABLE BASED ON CL RADIUS**

STATION	CL	CHORD LENGTH	R.T. DEFLECTION	TOTAL DEFLECTION
1+11.96 P.C.	13.04	7.78	13.00	8.60°
1+25.00	16.64	9.91	16.55	23.19
1+41.64 P.T.	7.06	4.22	7.05	9.88
DEFLECTION/FOOT = 0.621159795 DEGREES				

**CURVE TABLE BASED ON CL RADIUS**

STATION	CL	CHORD LENGTH	R.T. DEFLECTION	TOTAL DEFLECTION
0+98.23 P.C.	1.77	1.17	1.77	0.5549°
1+00.00	0.00	0.00	0.00	0.5549°
1+25.00	25.00	16.37	24.78	1.3528°
1+41.64 P.T.	16.64	10.95	16.58	2.2498°
DEFLECTION/FOOT = 0.325649353 DEGREES				

**CURVE TABLE BASED ON CB RADIUS**

STATION	ARC	CHORD LENGTH	R.T. DEFLECTION	TOTAL DEFLECTION
0+98.23 P.C.	1.77	0.99	1.77	0.4710°
1+00.00	0.00	0.00	0.00	0.4710°
1+25.00	25.00	13.87	24.84	11.5324°
1+47.51 P.T.	22.51	12.50	22.40	9.5951°
DEFLECTION/FOOT = 0.444153330 DEGREES				

**CURVE TABLE BASED ON CB RADIUS**

STATION	ARC	CHORD LENGTH	R.T. DEFLECTION	TOTAL DEFLECTION
0+98.23 P.C.	1.77	0.99	1.77	0.4710°
1+00.00	0.00	0.00	0.00	0.4710°
1+25.00	25.00	13.87	24.84	11.5324°
1+47.51 P.T.	22.51	12.50	22.40	9.5951°
DEFLECTION/FOOT = 0.444153330 DEGREES				

**CURVE TABLE BASED ON CB RADIUS**

STATION	ARC	CHORD LENGTH	R.T. DEFLECTION	TOTAL DEFLECTION
0+98.23 P.C.	1.77	0.99	1.77	0.4710°
1+00.00	0.00	0.00	0.00	0.4710°
1+25.00	25.00	13.87	24.84	11.5324°
1+47.51 P.T.	22.51	12.50	22.40	9.5951°
DEFLECTION/FOOT = 0.444153330 DEGREES				

**CURVE TABLE BASED ON CB RADIUS**

STATION	ARC	CHORD LENGTH	R.T. DEFLECTION	TOTAL DEFLECTION
0+98.23 P.C.	1.77	0.99	1.77	0.4710°
1+00.00	0.00	0.00	0.00	0.4710°
1+25.00	25.00	13.87	24.84	11.5324°
1+47.51 P.T.	22.51	12.50	22.40	9.5951°
DEFLECTION/FOOT = 0.444153330 DEGREES				

**CURVE TABLE BASED ON CB RADIUS**

STATION	ARC	CHORD LENGTH	R.T. DEFLECTION	TOTAL DEFLECTION
0+98.23 P.C.	1.77	0.99	1.77	0.4710°
1+00.00	0.00	0.00	0.00	0.4710°
1+25.00	25.00	13.87	24.84	11.5324°
1+47.51 P.T.	22.51	12.50	22.40	9.5951°
DEFLECTION/FOOT = 0.444153330 DEGREES				

**CURVE TABLE BASED ON CB RADIUS**

STATION	ARC	CHORD LENGTH	R.T. DEFLECTION	TOTAL DEFLECTION
0+98.23 P.C.	1.77	0.99	1.77	0.4710°
1+00.00	0.00	0.00	0.00	0.4710°
1+25.00	25.00	13.87	24.84	11.5324°
1+47.51 P.T.	22.51	12.50	22.40	9.5951°
DEFLECTION/FOOT = 0.444153330 DEGREES				

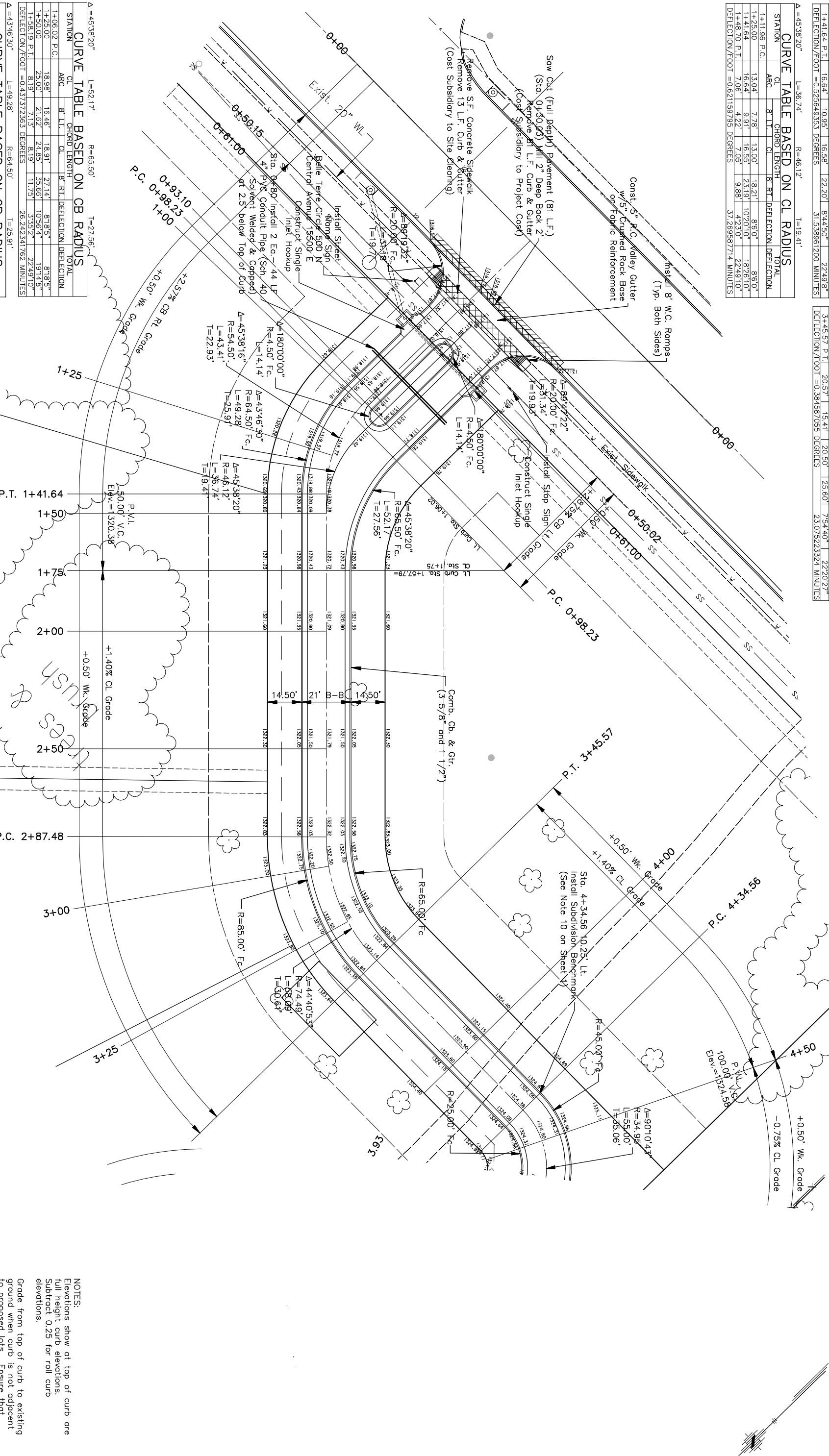

NOTES:  
Elevations show at top of curb are full height curb elevations. Subtract 0.25 for roll curb elevations.  
Grade from top of curb to existing ground when curb is not adjacent to proposed lots. Ensure that grades do not cause water to pond in these areas.

No.	Street and Station	From CL	Top of Curb (S)	Elevation
8	Belle Terre, 4+34.56	10.25' (S)		1324.39

**FINAL**

Designed By: J. Dickman  
 Drawn By: M. Tucker  
 Poe Job No.: 1809B  
 Date: April 2007

**POE & ASSOCIATES, INC.**  
 CONSULTING ENGINEERS  
 5940 E. Central, Suite 200 ■ Wichita, KS 67208-4242  
 Phone 316/685-4114 ■ FAX 316/685-4444

TERRADYNE WEST ADDITION  
 STREET IMPROVEMENTS  
 BELLE TERRE  
**CITY OF WICHITA, KANSAS**  
 JAMES L. ARMOUR, P.E. - CITY ENGINEER  
 Private Project # 179PPPP O.C.A. # 607879

No.	Date	By	Approved	Revision