

RECORD DRAWING
 1/9/2008
 MLT

1345	0+00	FL 1327.8	45.83 LF 18" RCP @ 4.50% Grade
1340	0+45.83	FL 1329.50	27.83 LF 18" RCP @ 1.72% Grade
1335	0+73.16	FL 1330.00	
1330		FL 1330.50	

LINE NO. 5

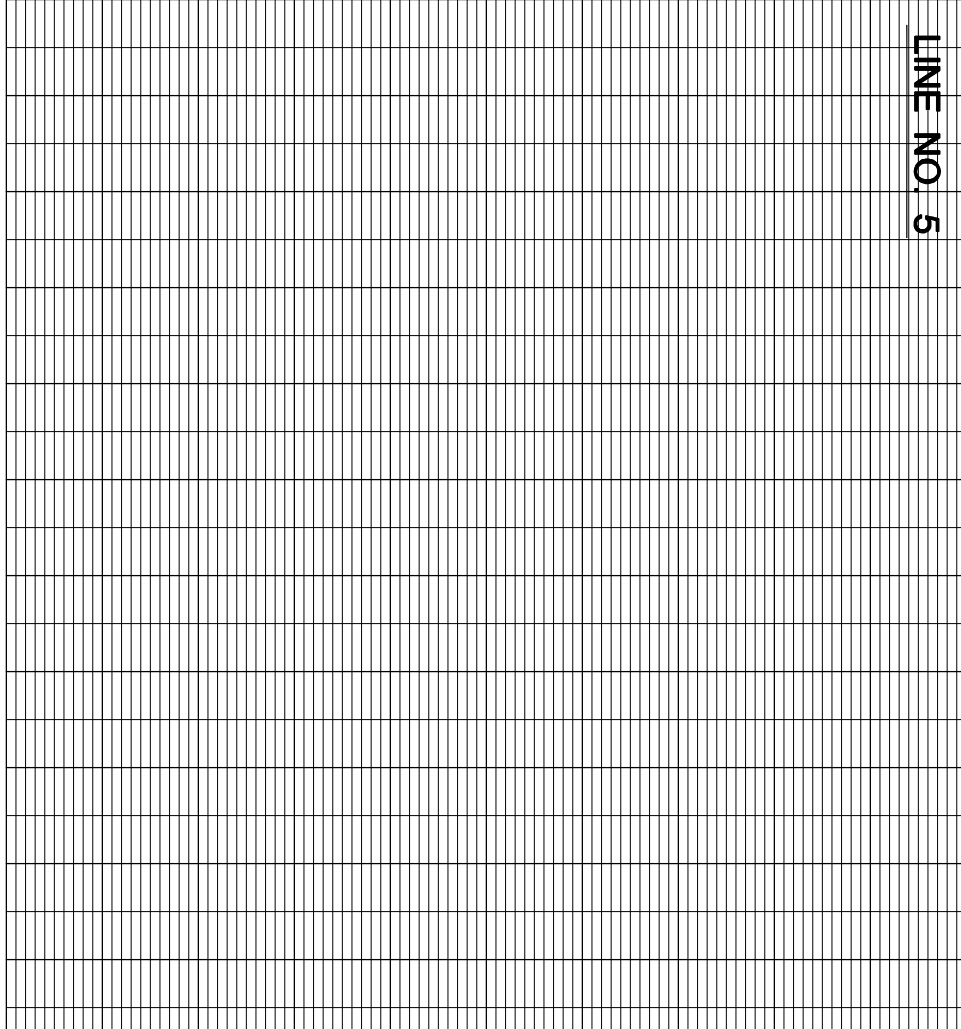

1345	0+00	1333.10	75.49 LF 18" RCP @ 0.61% Grade
1340	0+43.5	1335.56	
1335			
1330			
1325			
1320			
1315			
1310			
1305			
1300			

LINE NO. 7

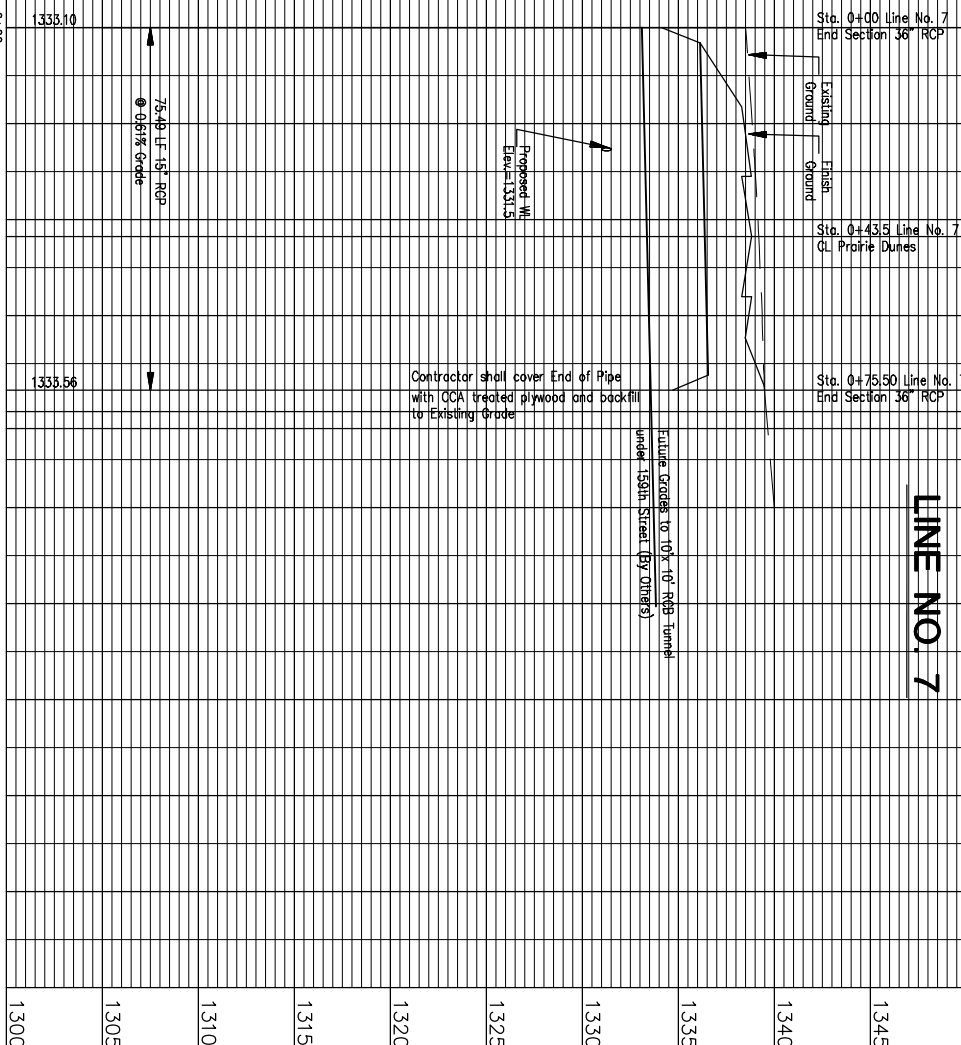

Contractor shall cover End of Pipe
 with CCA treated plywood and backfill
 to Existing grade

Future Grade to 10' 10" RCP Tunnel
 under 159th Street (By Other's)

FINAL

Designed By: J. Ubert / J. Dickman
 Drawn By: M. Tucker
 Poe Job No.: 1809
 Date: April 2007



POE & ASSOCIATES, INC.
 CONSULTING ENGINEERS
 5940 E. Central, Suite 200 ■ Wichita, KS 67208-4242
 Phone 316/685-4114 ■ FAX 316/685-4444

TERRADYNE WEST ADDITION
 STREET & STORM SEWER IMPROVEMENTS
 STORM SEWER LINE NO. 5 & 7
CITY OF WICHITA, KANSAS
 JAMES L. ARMOUR, P.E. - CITY ENGINEER
 Private Project # 179PPP OCA# 607879

No.	Date	By	Approved	Revision
1	1/9/08	MLT	JPD	Moved Curb Inlet South to New Location