

N
 SCALE: 1" = 30'

NOTE: Contractor shall seed and fertilize all slope surfaces and top of dam - see Special Provisions. Contractor will install Curlex Quickgrass, 25:1 seed matting, or approved equal, on all slope surfaces and 4' around the outside of detention area after completion of seeding.

Contractor to install 400 L.F. of Silt Fence Prior to Construction. Maintain until Erosion mat is installed on slopes.

Contractor to Construct Earth Embankment

Contractor to install 15' W x 4" P.C.C. Spillway (See Details)

Rip Rap By Others

Contractor to Remove Existing Plug and Extend 24" R.C.P. to Detention Basin (43 L.F. w/ Flange End Section).

Rip Rap Slope Protection By Others

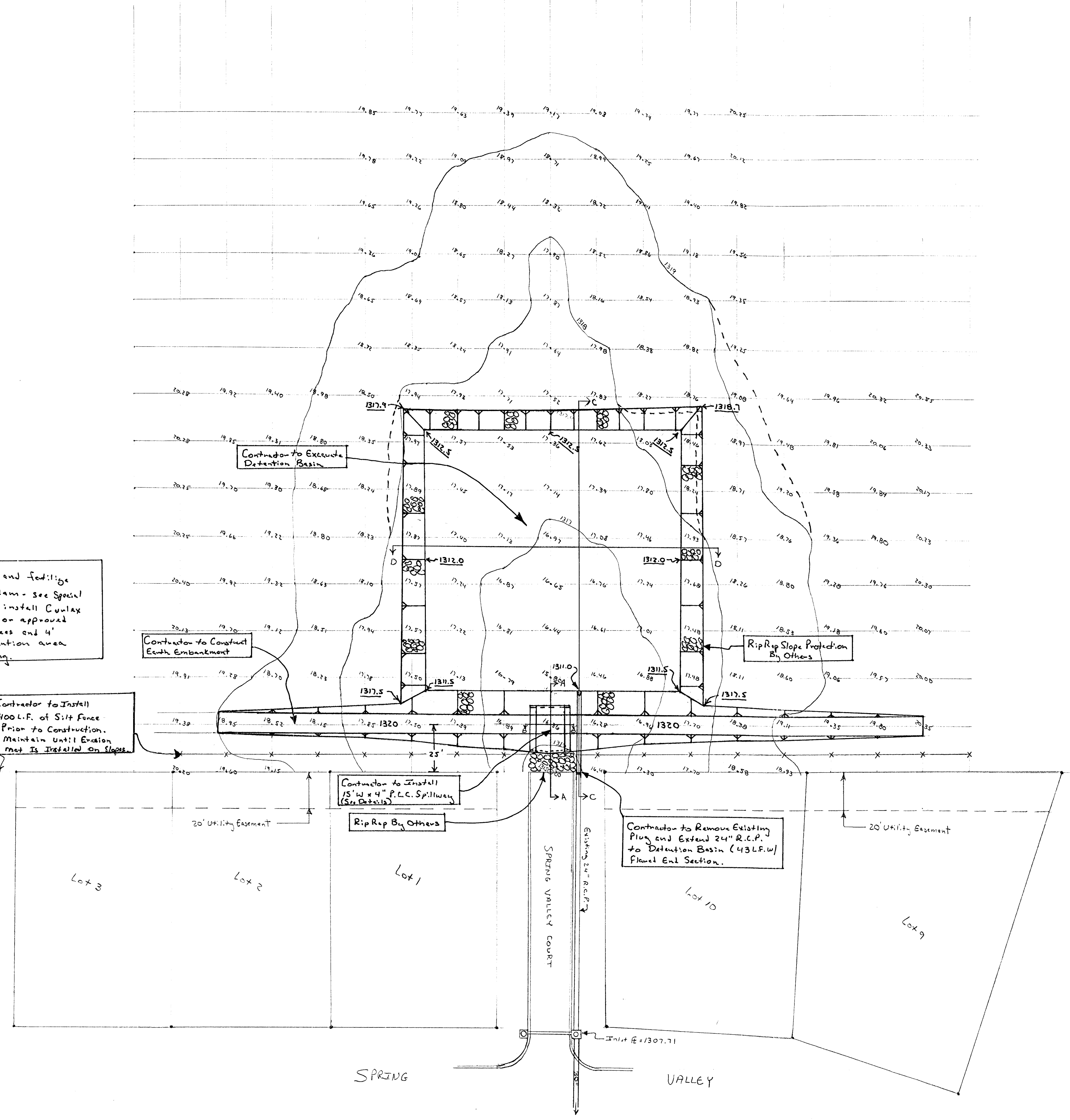

1:30

<p>THE CITY OF WICHITA CITY ENGINEER'S OFFICE CITY HALL - SEVENTH FLOOR 456 NORTH MAIN STREET WICHITA, KANSAS 67202 (316) 268-4507/202 (316) 268-4114 FAX</p>	SPRING VALLEY ESTATES 2ND ADDITION	
	STORM WATER DETENTION FACILITY	
	M. E. LINDBERG P.E. - CITY ENGINEER	
	PROJECT NUMBER	OCA NUMBER
DATE 11/00	SHEET 1 OF 2	