

PUB. ROAD DIV. NO.	STATE	FED. AID PROJ. NO.	FISCAL YEAR	SHEET NO.	TOTAL SHEETS
5	KANSAS		1970	128	229
35W-871-35W-1133146					
110					

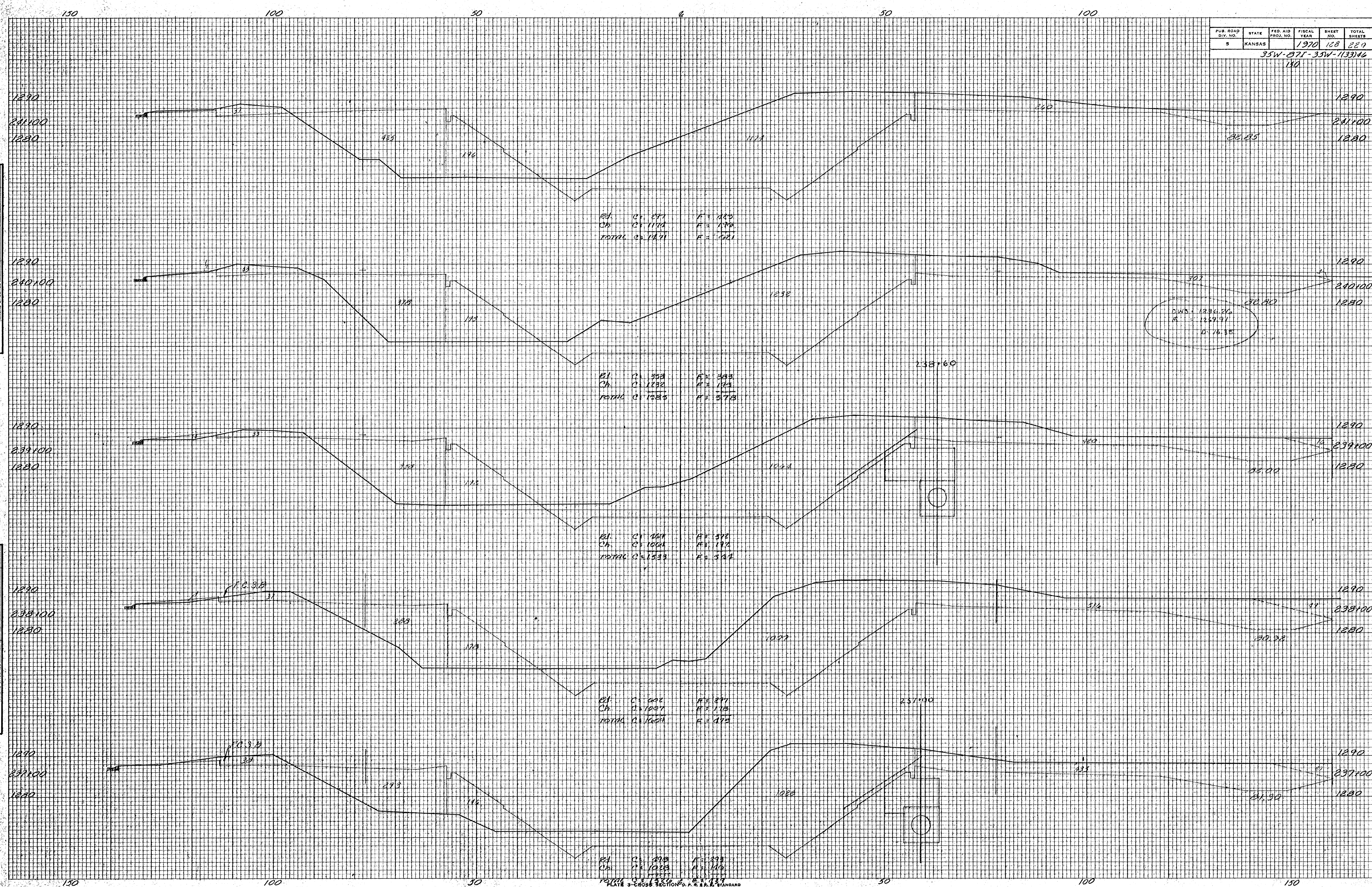

DIMS = 12.84' x 24'
 H = 12.59' x 7'
 D = 16.35'

ORIGINAL SURVEY BY DATE
 REVISIONS BY DATE
 CHECKED BY DATE
 APPROVED BY DATE
 NO. OF SHEETS
 TOTAL SHEETS

ORIGINAL SURVEY BY DATE
 REVISIONS BY DATE
 CHECKED BY DATE
 APPROVED BY DATE
 NO. OF SHEETS
 TOTAL SHEETS